

U. S. Department of Agriculture

FOREST SERVICE

Chippewa NATIONAL FOREST

P. M. I.

CORNERS OF THE PUBLIC SURVEY

T. 141 R. 25-426 Mer.

S. 1/6 Corner common to Sections 13-141-26, 12-141-25, and 18-141-25

Corner consists of a Cedar Post (set) in place

State condition good

Dimensions above ground 18 1/2 inches

Sketch grooves, letters, figures, or notches, on proper face or edge.

CARDINAL POSITION

DIAGONAL POSITION

	1/6 5 13		1/6 5 18
N	W	S	E

NW	SW	SE	NE

Mound of is located

Pits are located

Sketch markings of Bearing Trees (or Rocks) in proper box and fill blanks below, giving bearings from Corner to Trees and Distances in Links.

1/6 38			
B7			

Species Iron Stake Stamp

Diameter 2"

Bearing N

Distance 206

Do you believe this to be a genuine Land Office Corner? Yes

If not, why?

Frank H. Hendricks

(Signature)

Estimator

(Date)

(Title)

U. S. GOVERNMENT PRINTING OFFICE: 1909
CORNER OF THE PUBLIC SUBWAY

LW 3-27-76 NOT FOUND

Give any further facts which will aid in finding this
Corner again.

from which this Corner bears
side of
tree inches diameter, on the
Metal Location Poster is on a 1/3 T.

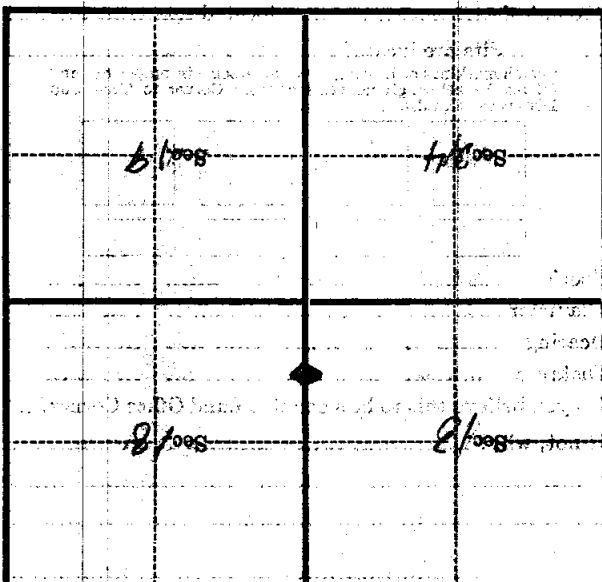

(Make sketch of topography near Corner)

U. S. Department of Agriculture
FOREST SERVICE

AA-1

CHIPPEWA NATIONAL FOREST

CORNERS OF THE PUBLIC SURVEY

T. 141 R. 25-26 5th. Mer.

S 1/16 Corner common to Sections
13-141-26, and 18-141-25

Corner consists of a cedar post in place

State condition good

Dimensions above ground 18" inches

Sketch grooves, letters, figures, or notches, on proper face or edge.

CARDINAL POSITION

DIAGONAL POSITION

	1/16	1/16
	S	S18
	13	

N W S E

NW SW SE NE

Mound of _____ is located _____

Pits are located _____

Sketch markings of Bearing Trees (or Rocks) in proper box and fill blanks below, giving bearings from Corner to Trees and Distances in Links.

1/16 S 18			
B.T.			

Species Tam stump

Diameter 5"

Bearing E

Distance 20

Do you believe this to be a genuine Land Office Corner? Yes

If not, why? _____

F. Hendricks

(Signature)

Estimator

2/27/35

(Date)

(Title)

WATER RESOURCES DIVISION

FIELD NOTES

NO. 141

DATE

BY

TO

PLACE

STATE

COUNTY

TOWNSHIP

RANGE

SECTION

ACRES

SECTION

SECTION

SECTION

SECTION

SECTION

SECTION

SECTION

SECTION

SECTION

SECTION

SECTION

SECTION

SECTION

SECTION

SECTION

SECTION

SECTION

SECTION

SECTION

Corner of road in small meadow
 Give any further facts which will aid in finding this
 chad's distant
 from which this Corner bears
 side of
 inches diameter, on the
 Metal Location Poster is on a

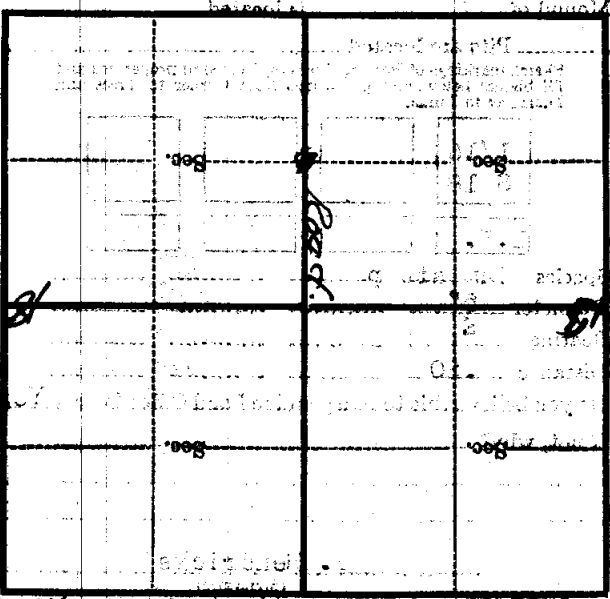

Make sketch of topography near Corner