

U. S. Department of Agriculture
FOREST SERVICE

0-2

Chippewa NATIONAL FOREST
CORNERS OF THE PUBLIC SURVEY

T. 60 R. 21 Mer. 4

1/16 Corner common to Sections

19, and

Corner consists of a Cedar Post (not) in place

State condition

Dimensions above ground 24 inches

Sketch grooves, letters, figures, or notches, on proper face or edge.

CARDINAL POSITION

DIAGONAL POSITION

	<u>1/16</u> <u>#2</u>		<u>1/16</u> <u>#2</u>
--	--------------------------	--	--------------------------

N W S E

--	--	--	--

NW SW SE NE

Mound of _____ is located _____

Pits are located _____

Sketch markings of Bearing Trees (or Rocks) in proper box and fill blanks below, giving bearings from Corner to Trees and Distances in Links.

			<u>1/16</u> <u>#2</u>
			<u>BT</u>

Species _____ Cedar

Diameter _____ 4"

Bearing _____ N 31 E

Distance _____ 31 lks

Do you believe this to be a genuine Land Office Corner? No

If not, why? Set by County

Len Skaji
(Signature)
CCC
(Title)

2/17/36
(Date)

Handwritten notes on a series of horizontal dashed lines.

Corner again.

Give any further facts which will aid in finding this

chains distant.

From which this Corner bears

side of

tree 5 inches diameter, on the

Metal Location Poster is on a

Force Post

56
Lu2ks Rd
S. S.

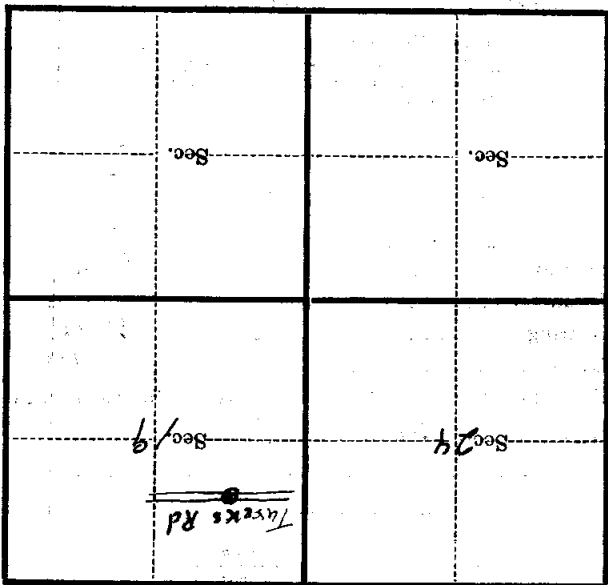

(Make sketch of topography near Corner)

T.

R.

Mer.

U. S. Department of Agriculture

FOREST SERVICE

0-2

----- NATIONAL FOREST

CORNERS OF THE PUBLIC SURVEY

T. 6a R. 26 4th Mer.

1/6 Corner common to Sections
center N^{1/4} of S 19, and

Corner consists of a Cedar Post (not) in place
State condition -----

Dimensions above ground 3" 9" x 2 1/2" inches
Sketch grooves, letters, figures, or notches, on proper face or edge.

CARDINAL POSITION

DIAGONAL POSITION

	<u>1/6</u> # <u>2</u>		<u>1/6</u> # <u>2</u>
N	W	S	E

NW	SW	SE	NE

Mound of ----- is located -----

Pits are located -----

Sketch markings of Bearing Trees (or Rocks) in proper box and fill blanks below, giving bearings from Corner to Trees and Distances in Links.

			<u>1/6</u> # <u>2</u>
			<u>BT</u>

Species ----- Cedar
 Diameter ----- 4"
 Bearing ----- N. 31° E
 Distance ----- 31 ch.

Do you believe this to be a genuine Land Office Corner? No

If not, why? County survey corner

Len Skajan
(Signature)

Feb 17 1936 (Date) ccc (Title)

Corner again.

Give any further facts which will aid in finding this

chains distant.

55

from which this Corner bears

side of *Turk's Road*

tree *5* inches diameter, on the *South*

Metal Location Poster is on a *Fence Post*

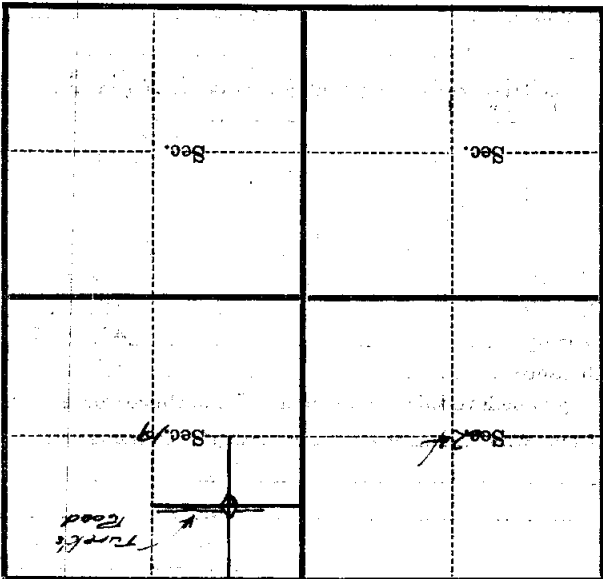

(Make sketch of topography near Corner)

T. 60 R. 26 Mer.