

U. S. Department of Agriculture
FOREST SERVICE

Chippewa NATIONAL FOREST

Posted

V-10/11

CORNERS OF THE PUBLIC SURVEY

T. 59 N R. 26 W 4th Mer.

M. C. Corner common to Sections
28, and 33

Corner consists of a 4" Balsam in place
State condition good (1" iron pipe)

Dimensions above ground 2' 6" inches

Sketch grooves, letters, figures, or notches, on proper face or edge.

CARDINAL POSITION

DIAGONAL POSITION

| | | | |
|----|---|----|---|
| S | | S | |
| 28 | | 33 | |
| N | W | S | E |

| | | | |
|----|----|----|----|
| | | | |
| | | | |
| NW | SW | SE | NE |

Mound of _____ is located _____

Pits are located _____

Sketch markings of Bearing Trees (or Rocks) in proper box and fill blanks below, giving bearings from Corner to Trees and Distances in Links.

| | | | |
|-----|--|-----|--|
| S | | S | |
| 28 | | 33 | |
| B.T | | B.T | |

Species W. Birch W. Birch

Diameter 6" 6"

Bearing N 42° E S 38° E

Distance 50 Li 49 Li

Do you believe this to be a genuine Land Office Corner? yes

If not, why? _____

Ernie Meagher
(Signature)

Field Ass't
(Title)

1-4-35
(Date)

LAND ROLLING SECOND
GROWN WITH ASPHEN

Corner again.

Give any further facts which will aid in finding this

19 1/2 corners distant.

from which this Corner bears N 38. W

side of tree

tree 6 inches diameter, on the N. W

Metal Location Poster is on a W. Birch

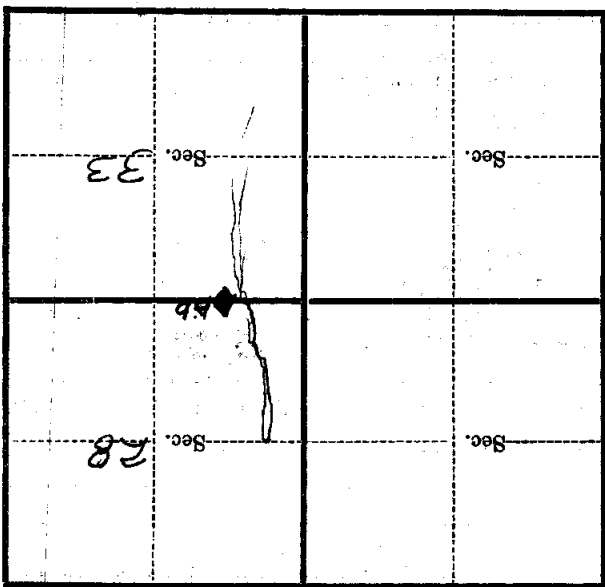

(Make sketch of topography near Corner)

T. 59 N R. 26 W Mer.

U. S. Department of Agriculture

FOREST SERVICE

~~C. L. IPPEW~~ NATIONAL FOREST

V-10, 11

CORNERS OF THE PUBLIC SURVEY

T. 59 N. R. 26 W. 4th Mer.

M. C. Corner common to Sections
28, and 33Corner consists of a 4" Balsam (not) in place
State condition Good 1" iron pipe 6" high

Dimensions above ground 2' 6" high inches

Sketch grooves, letters, figures, or notches, on proper face or edge.

CARDINAL POSITION

DIAGONAL POSITION

| | | | |
|----|---|----|---|
| S | | S | |
| 28 | | 33 | |
| N | W | S | E |

| | | | |
|----|----|----|----|
| | | | |
| | | | |
| NW | SW | SE | NE |

Mound of _____ is located _____

Pits are located _____

Sketch markings of Bearing Trees (or Rocks) in proper box and
fill blanks below, giving bearings from Corner to Trees and
Distances in Links.

| | | | |
|----|--|----|--|
| S | | S | |
| 28 | | 33 | |
| BT | | BT | |

Species W. birch W. birchDiameter 6" 6"Bearing N 42° E S 38° EDistance 50-145 19-145Do you believe this to be a genuine Land Office Corner? Yes

If not, why? _____

Ervin Meagher

(Signature)

1-4-35

(Date)

Field Assc.

(Title)

Corner again.
1st and Hill second
19-175
From which this Corner bears
side of tree
tree 6 inches diameter, on the
Metal Location Poster is on a
W. Birch

Give any further facts which will aid in finding this
19-175 chains distant.
N 38. W
tree 6 inches diameter, on the
Metal Location Poster is on a
W. Birch

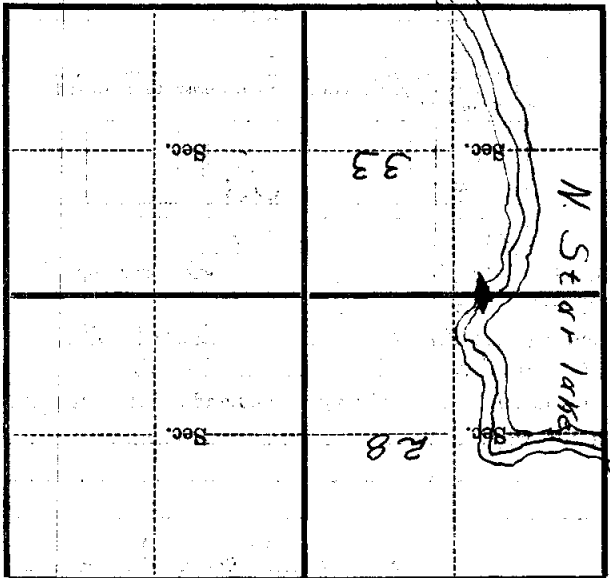

(Make sketch of topography near Corner)

T. 59N R. 26E 4th Mer.

U. S. Department of Agriculture

FOREST SERVICE

V-10-11

CHIPPENAW NATIONAL FOREST
 CORNERS OF THE PUBLIC SURVEY

T. 59 N R. 26 W 4th Mer.

N. C. Corner common to Sections
 _____, _____, 28, and 33.

Corner consists of a 4" Balsam (not) in place

State condition good 1" iron pipe 6" high

Dimensions above ground 2'6" high inches

Sketch grooves, letters, figures, or notches, on proper face or edge.

CARDINAL POSITION

DIAGONAL POSITION

| | | | |
|----|---|----|---|
| S | | S | |
| 28 | | 33 | |
| N | W | S | E |

| | | | |
|----|----|----|----|
| | | | |
| | | | |
| NW | SW | SE | NE |

Mound of _____ is located _____

Pits are located _____

Sketch markings of Bearing Trees (or Rocks) in proper box and fill blanks below, giving bearings from Corner to Trees and Distances in Links.

| | | | |
|---------|----|---------|--|
| S 28 | | S 33 | |
| BT | BT | BT | |

Species W. Birch W. Birch

Diameter 6 6

Bearing N 72° E S 38° E

Distance 50 Lks 19 Lks

Do you believe this to be a genuine Land Office Corner? yes

If not, why? _____

Emin M. _____
 (Signature)

1-4-35
 (Date)

Field Ass't
 (Title)

Corner again.
 1 AND HILL SECOND
 GROWNCH W. BIRCH

Give any further facts which will aid in finding this
 1915 ~~and~~ distant.
 From which this Corner bears
 N 38° W
 side of tree
 tree 6 inches diameter, on the N.W.
 Metal Location Poster is on a W. BIRCH

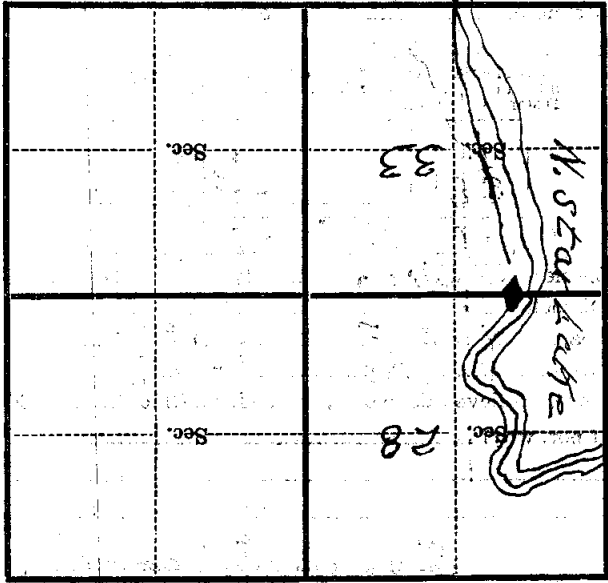

(Make sketch of topography near Corner)

T 57 N R 26 W 7 24 Mer.