

U. S. Department of Agriculture

FOREST SERVICE

E-23
E-25

Chippewa

NATIONAL FOREST

CORNERS OF THE PUBLIC SURVEY

T. 59 N R. 26 W Mer.

1/4

Corner common to Sections

1, and 12

Corner consists of a Aspen stake (not) in place

State condition

Dimensions above ground 40 inches

Sketch grooves, letters, figures, or notches, on proper face or edge.

CARDINAL POSITION

DIAGONAL POSITION

--	--	--	--

N W S E

--	--	--	--

NW SW SE NE

Mound of _____ is located _____

Pits are located _____

Sketch markings of Bearing Trees (or Rocks) in proper box and fill blanks below, giving bearings from Corner to Trees and Distances in Links.

Species _____

Diameter _____

Bearing _____

Distance _____

Do you believe this to be a genuine Land Office Corner? No

If not, why? U.S.F.S

(Signature)

10-7-35

(Date)

(Title)

.....

Corner again.

Give any further facts which will aid in finding this
 chains distant.

0.21

from which this Corner bears

536 E

side of

tree

tree 10 inches diameter, on the

SE

Metal Location Poster is on a

N.P.

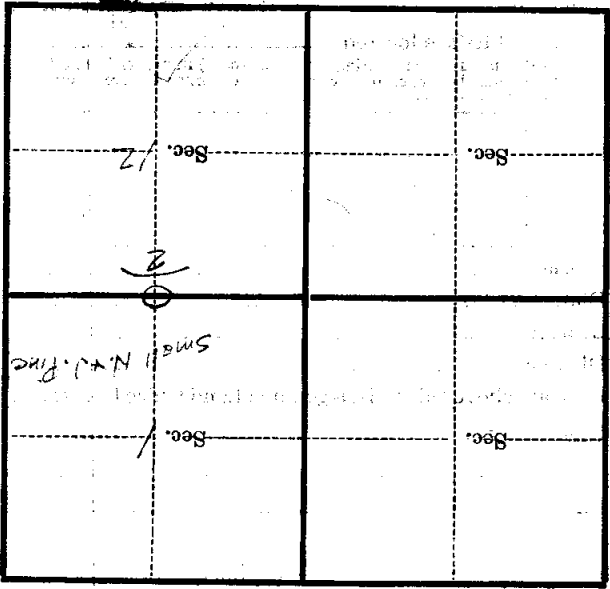

(Make sketch of topography near Corner)

T. R. Mer.