

U. S. Department of Agriculture

FOREST SERVICE

E-21

Chippewa NATIONAL FOREST

CORNERS OF THE PUBLIC SURVEY

T. 59N R. 26W 9th Mer.

Section Corner common to Sections 1, 2, 11, and 12

Corner consists of a 1/4" x 1/3" Iron bar (not) in place

State condition Good

Dimensions above ground 18 inches

Sketch grooves, letters, figures, or notches, on proper face or edge.

CARDINAL POSITION

DIAGONAL POSITION

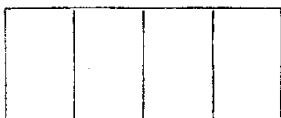
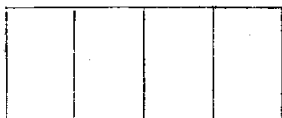

N W S E

NW SW SE NE

Mound of is located

Pits are located

Sketch markings of Bearing Trees (or Rocks) in proper box and fill blanks below, giving bearings from Corner to Trees and Distances in Links.



Species Pine Stump

Diameter

Bearing 55° 40' N

Distance 28.140

Do you believe this to be a genuine Land Office Corner? No

If not, why? Evidently set by County from G. L. O. bearing tree which is still there.

Arthur J. Johnson (Signature)

Special Foreman (Title)

3/7/40 (Date)

Corner again. This corner lies 1/4 mi. East of T.T. #602

Give any further facts which will aid in finding this 28 chains distant. from which this corner bears N57° E T.T. #602 side of tree. inches diameter, on the East Metal Location Poster is on the BT

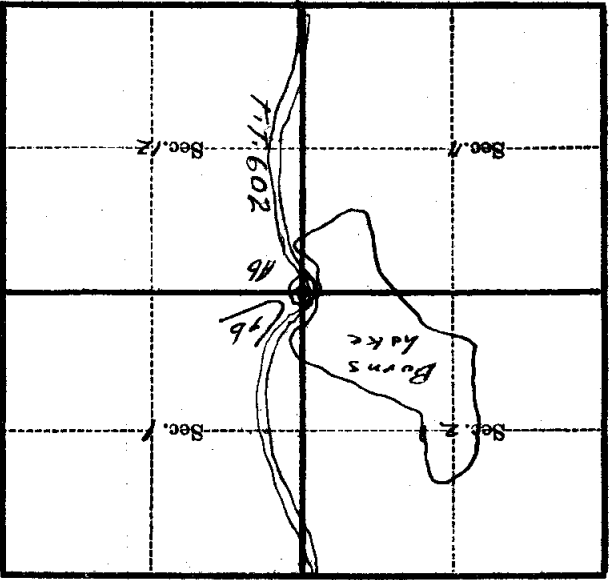

(Make sketch of topography near corner)

T. 59 N R. 26 W Mer. 9th

U. S. Department of Agriculture
FOREST SERVICE

E-21

Chippewa NATIONAL FOREST

CORNERS OF THE PUBLIC SURVEY

T. 59 N R. 26 W 4th P Mer.

Section Corner common to Sections

1, 2, 11, and 12
Corner consists of a Strip Iron (sled runner) (net) in place

State condition Good

Dimensions above ground 18 inches

Sketch grooves, letters, figures, or notches, on proper face or edge.

CARDINAL POSITION

DIAGONAL POSITION

--	--	--	--

--	--	--	--

N W S E

NW SW SE NE

Mound of _____ is located _____

Pits are located _____

Sketch markings of Bearing Trees (or Rocks) in proper box and fill blanks below, giving bearings from Corner to Trees and Distances in Links.

Species N. Pine 9229

Diameter Was 18"

Bearing N55E

Distance 28 ch

Do you believe this to be a genuine Land Office Corner? Yes

If not, why? _____

George H. Jennings

(Signature)

10-2-35

(Date)

J. J. Newman C.M.

(Title)

Lined writing area with horizontal dashed lines.

Corner again.

Give any further facts which will aid in finding this

chains distant.

from which this Corner bears

side of

tree _____ inches diameter, on the

Metal Location Poster is on a N.P. 3153

N.E. 1

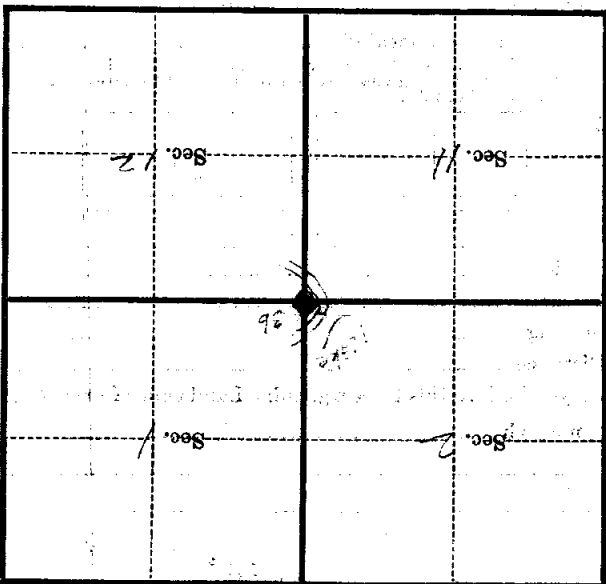

(Make sketch of topography near Corner)

T. R. Mer.

U. S. Department of Agriculture

FOREST SERVICE

posted E-21

21110 NATIONAL FOREST

CORNERS OF THE PUBLIC SURVEY

T. 59 R. 26 4 Mer.

sec. Corner common to Sections

1, 2, 11, and 12

Corner consists of a wood Post (not) in place

State condition Poor dead stub

Dimensions above ground _____ inches.

Sketch grooves, letters, figures, or notches, on proper face or edge.

CARDINAL POSITION

DIAGONAL POSITION

N	W	S	E

<u>2</u>	<u>11</u>	<u>12</u>	<u>1</u>
NW	SW	SE	NE

Mound of _____ is located _____

_____ Pits are located _____

Sketch markings of Bearing Trees (or Rocks) in proper box and fill blanks below, giving bearings from Corner to Trees and Distances in Links.

<u>11</u>	<u>2</u>	<u>1</u>	<u>12</u>
<u>BT</u>			

Species Alnus

Diameter 12

Bearing S 10 W

Distance 20 ft

Do you believe this to be a genuine Land Office Corner?.....

If ~~not~~, why? Yes

John Cochran
(Signature)

Oct 26
(Date)

Estimator
(Title)

Metal Location Poster is on a tree inches diameter, on the side of from which this Corner bears chains distant. Give any further facts which will aid in finding this Corner again.

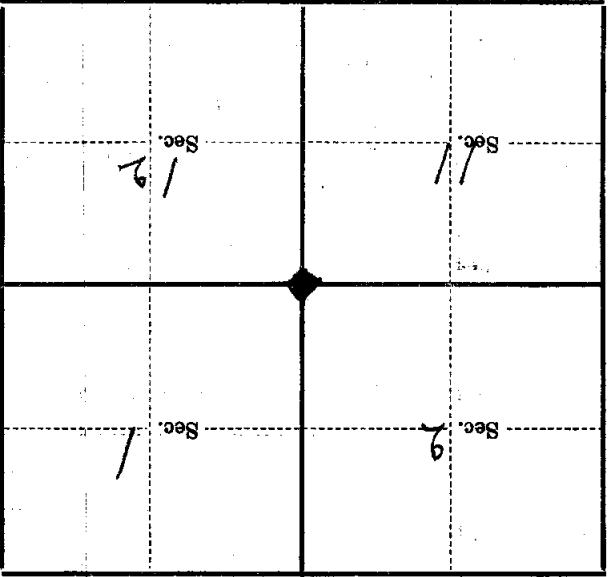

(Make sketch of topography near Corner)

T. 59 R. 26 Mer. 4

U. S. Department of Agriculture

FOREST SERVICE

E-21

Chippewa NATIONAL FOREST

CORNERS OF THE PUBLIC SURVEY

T. 59N R. 26W 4 P Mer.

Section Corner common to Sections

1, 2, 11, and 12

Corner consists of strap iron (Sled runner) in place

State condition Good

Dimensions above ground 18 inches

Sketch grooves, letters, figures, or notches, on proper face or edge.

CARDINAL POSITION

DIAGONAL POSITION



N W S E

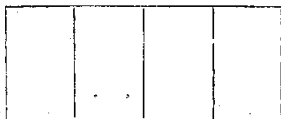

NW SW SE NE

Mound of is located

Pits are located

Sketch markings of Bearing Trees (or Rocks) in proper box and fill blanks below, giving bearings from Corner to Trees and Distances in Links.



Species N. Pine Snag

Diameter Was 18"

Bearing N55E

Distance .28 ch

Do you believe this to be a genuine Land Office Corner? Yes

If not, why?

George H. Jennings

(Signature)

10-2-35

(Date)

Jr. Foreman C & M

(Title)

(Make sketch of topography near Corner)

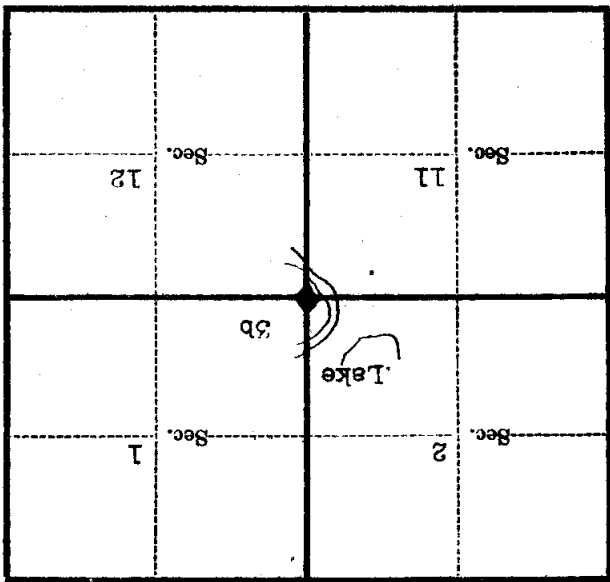

Metal Location Poster is on a N. Pine snag

tree _____ inches diameter, on the N.E.

side of Snag

from which this Corner bears

0.28

chains distant.

Give any further facts which will aid in finding this

Corner again.

T. 39 R. 22 A P Mer.

U. S. Department of Agriculture

FOREST SERVICE

E-21

Chippewa NATIONAL FOREST

CORNERS OF THE PUBLIC SURVEY

T. 59N R. 26W 4th Mer.

Section

Corner common to Sections

1, 2, 11, and 13

Corner consists of a 1/2" x 3" Iron box (not) in place

State condition Good

Dimensions above ground 18 inches

Sketch grooves, letters, figures, or notches, on proper face or edge.

CARDINAL POSITION

DIAGONAL POSITION

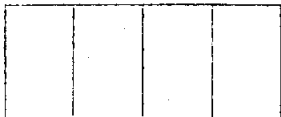

N W S E

NW SW SE NE

Mound of is located

Pits are located

Sketch markings of Bearing Trees (or Rocks) in proper box and fill blanks below, giving bearings from Corner to Trees and Distances in Links.

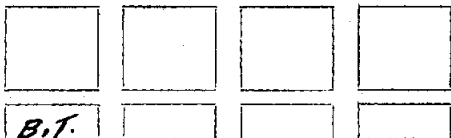

Species Pine Stump

Diameter

Bearing 257° W

Distance 20.1 ks

Do you believe this to be a genuine Land Office Corner? NO

If not, why? Evidently set by County from G.H.O. bearing trees which is still there.

0

Cuthbert J. Johnson

(Signature)

Special Foreman

(Title)

3/7/40

(Date)

(Make sketch of topography near Corner)

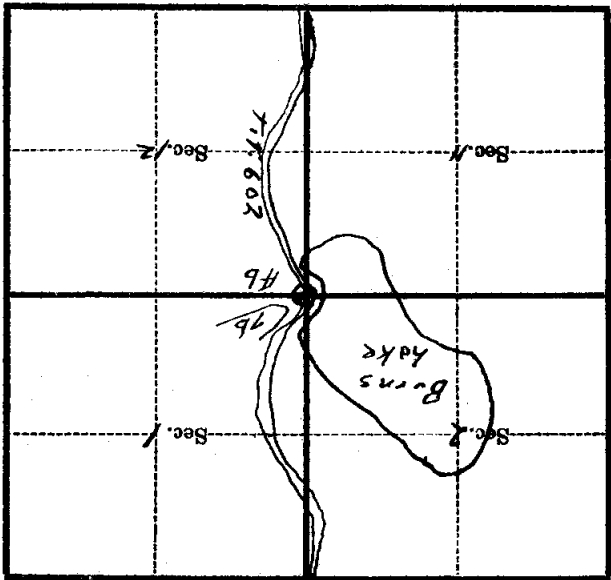

T. 59N R. 26W 4th Mer.

Metal Location Poster is on the BT

tree inches diameter, on the EAST

side of T.F. #602

from which this Corner bears N57°E

. 28 chains distant.

Give any further facts which will aid in finding this

Corner again.

This Corner lies 1/4 ch. East of T.F. #602