

U. S. Department of Agriculture

FOREST SERVICE

A-14

Chippewa

NATIONAL FOREST

CORNERS OF THE PUBLIC SURVEY

T. 59 & 60 R. 26 4 Mer.

W 1/4

Corner common to Sections

3, and 3A

Corner consists of a Cedar post (not) in place

State condition

Dimensions above ground inches

Sketch grooves, letters, figures, or notches, on proper face or edge.

CARDINAL POSITION

DIAGONAL POSITION

--	--	--	--

N W S E

--	--	--	--

NW SW SE NE

Mound of is located

Pits are located

Sketch markings of Bearing Trees (or Rocks) in proper box and fill blanks below, giving bearings from Corner to Trees and Distances in Links.

Species

Diameter

Bearing

Distance

Do you believe this to be a genuine Land Office Corner? No

If not, why? U.S.F.S

George H. Kinnison

(Signature)

11-26-35

(Date)

J. M. Newman C.M.

(Title)

Handwritten notes on ruled lines, including "MSN" and "MSW".

Corner again...
Twin elm with poster is
between old pole road &
bearing of up slope

Give any further facts which will aid in finding this
chains distant.

from which this Corner bears
side of tree

Metal Location Poster is on a
tree 4 inches diameter, on the
West North
Twin Elm?

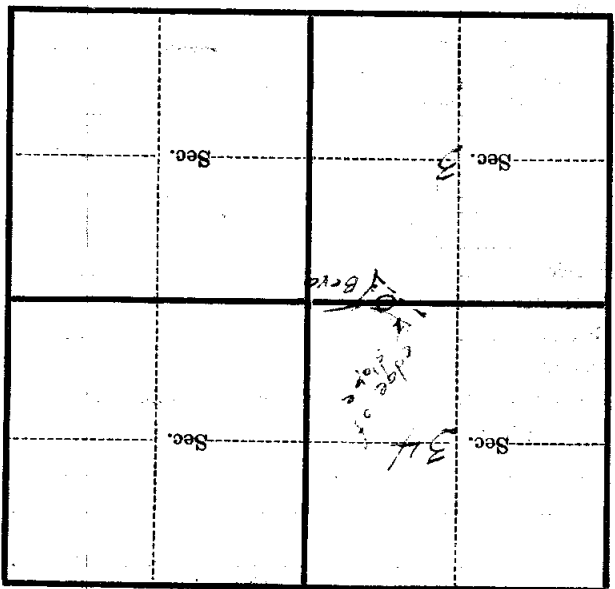

(Make sketch of topography near Corner)