

Camp
copy

U. S. Department of Agriculture
FOREST SERVICE

Y-3

Shippewa NATIONAL FOREST

CORNERS OF THE PUBLIC SURVEY

T. 59 N R. 26 W 4th Mer.

S 1/16 - Co #16 #6 Corner common to Sections
31, , and

Corner consists of a Cedar Post (not) in place
State condition Good

Dimensions above ground 30 inches

Sketch grooves, letters, figures, or notches, on proper face or edge.

CARDINAL POSITION

DIAGONAL POSITION

S		S	
31		31	
N	W	S	E

NW	SW	SE	NE

Mound of is located

Pits are located

Sketch markings of Bearing Trees (or Rocks) in proper box and fill blanks below, giving bearings from Corner to Trees and Distances in Links.

1/16
#6

1/16
#6

B.T.

B.T.

Species Aspen Cedar

Diameter 9" 5"

Bearing S74E S25W

Distance 14 1/2 Lks 15 Lks

Do you believe this to be a genuine Land Office Corner? No

If not, why? Corner post has county
cor. number scribed on it.

10/8/36
(Date)

(Signature)
H. J. [unclear]
(Title)

located on T. 591, Logging Road
branches off of main trail just
south of corner & runs N.E.
Timber type balsam-cedar
and Aspen.

Corner again.

Give any further facts which will aid in finding this

6 Mks. ~~distance~~ distant.

from which this Corner bears Due East

side of Post

tree 6 inches diameter, on the West

Metal Location Poster is on a F.S. Post

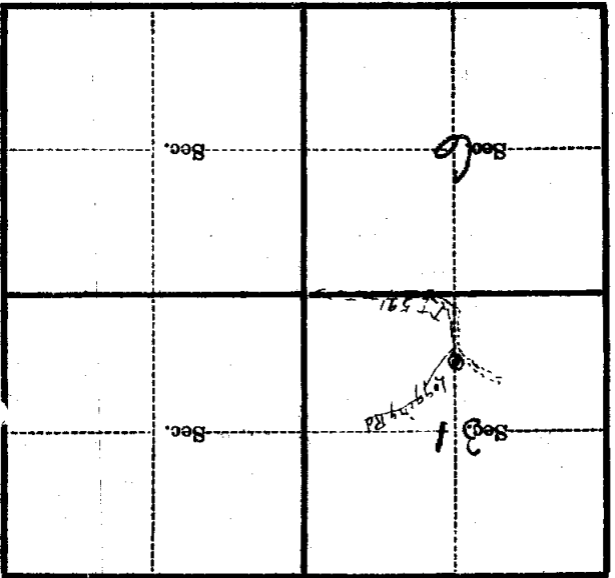

(Make sketch of topography near Corner)

T. 591 R. 26 W. 4th Mer.

beginning 1917

U. S. Department of Agriculture

FOREST SERVICE

Y-3

P

Chiquagon NATIONAL FOREST

CORNERS OF THE PUBLIC SURVEY

T. *59 N* R. *26 W* of *12* Mer.

CS 116 # 6

Corner common to Sections

-----, *31*, and -----

Corner consists of a *Cedar Post - iron pipe* (not) in place

State condition *good*

Dimensions above ground *30* inches

Sketch grooves, letters, figures, or notches, on proper face or edge.

CARDINAL POSITION

DIAGONAL POSITION

<i>3</i>		<i>5</i>	
<i>13</i>		<i>13</i>	

N W S E

NW SW SE NE

Mound of ----- is located -----

Pits are located -----

Sketch markings of Bearing Trees (or Rocks) in proper box and fill blanks below, giving bearings from Corner to Trees and Distances in Links.

<i>1/16</i> <i>#6</i>

<i>1/16</i> <i>#6</i>

--

--

<i>BT</i>

<i>BT</i>

--

--

Species *Aspen Cedar*

Diameter *9" 5"*

Bearing *S74°E S25°W*

Distance *14 1/2 lks 15 lks*

Do you believe this to be a genuine Land Office Corner? -----

If not, why? -----

Resurvey by county engineer

M. M. ...

(Signature)

10/8/36
(Date)

S. Clark
(Title)

Corner again.
Ditch on T 591 a bearing
and branch off just as if
come from the
Bisson cedar trees
top

Metal Location Poster is on a
tree 6 inches diameter, on the
side of *Post*
from which this Corner bears
to the chains distant.
Give any further facts which will aid in finding this

Minnesota National Forest
CASS LAKE, MINN.

JUL 19 1937
RECEIVED

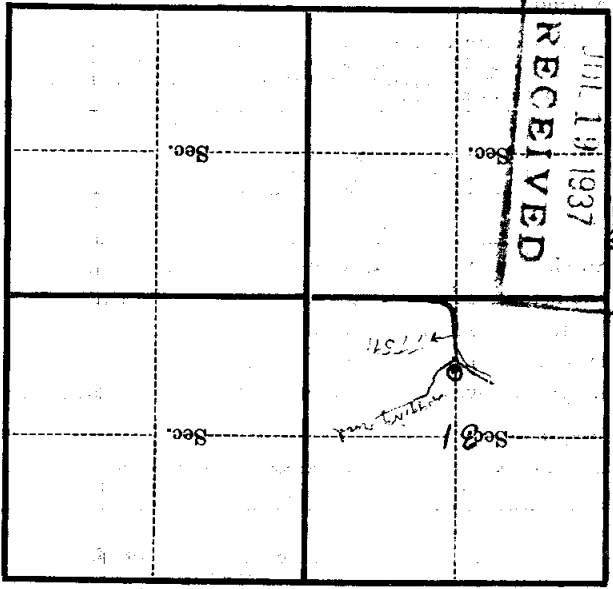

(Make sketch of topography near Corner)

T. 59 n R. 26 W
Mer.