

U. S. Department of Agriculture
FOREST SERVICE

21

Chippewa NATIONAL FOREST

CORNERS OF THE PUBLIC SURVEY

T. 59 R. 26 27 4 Mer.

1/4 Corner common to Sections

19, and 24

Corner consists of a Cedar st (~~not~~) in place

State condition

Dimensions above ground 20 inches

Sketch grooves, letters, figures, or notches, on proper face or edge.

CARDINAL POSITION

DIAGONAL POSITION

--	--	--	--

--	--	--	--

N W S E

NW SW SE NE

Mound of _____ is located _____

Pits are located _____

Sketch markings of Bearing Trees (or Rocks) in proper box and fill blanks below, giving bearings from Corner to Trees and Distances in Links.

	<u>1/4</u> <u>S</u>		

Species Tam. 5029

Diameter 6

Bearing S85E

Distance 0.50

Do you believe this to be a genuine Land Office Corner? No

If not, why? U.S.F.S. Cor.

One, probably County. B.T.

George H. Jennings
(Signature)

9-24-35
(Date)

Jr. Foreman C.M.
(Title)

Corner again.
Ticket line intersection

Give any further facts which will aid in finding this

chains distant. 0.78

from which this Corner bears North

side of tree

tree 6 inches diameter, on the N

Metal Location Poster is on a W. Cedar

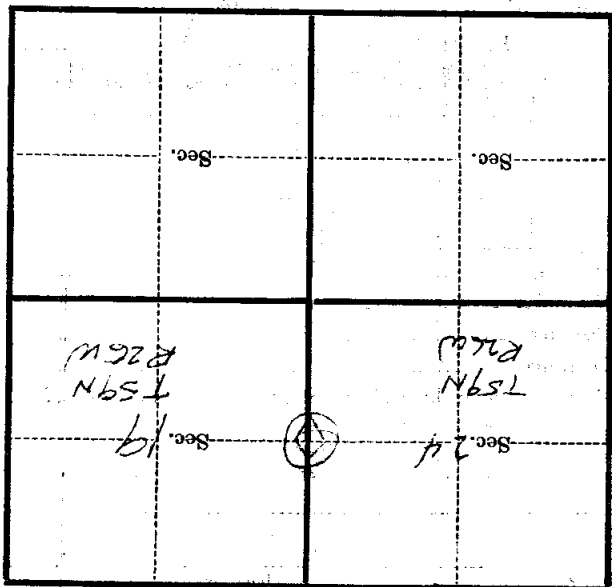

(Make sketch of topography near Corner)

T. 59 R. 26+27 4 Mer.

U. S. Department of Agriculture

FOREST SERVICE

P-1

Chippewa NATIONAL FOREST

CORNERS OF THE PUBLIC SURVEY

T. 59N R. 26 & 27 W 4 Mer.

1/4 Corner common to Sections

19, and 24

Corner consists of a Cedar Stake (not) in place

State condition

Dimensions above ground 20 inches

Sketch grooves, letters, figures, or notches, on proper face or edge.

CARDINAL POSITION

DIAGONAL POSITION

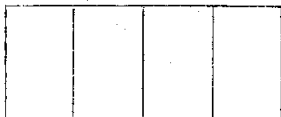

N W S E

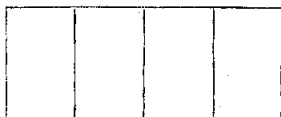

NW SW SE NE

Mound of is located

Pits are located

Sketch markings of Bearing Trees (or Rocks) in proper box and fill blanks below, giving bearings from Corner to Trees and Distances in Links.

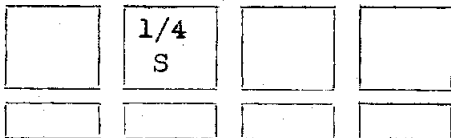

Species Tam. snag

Diameter 6

Bearing S85E

Distance 0.50

Do you believe this to be a genuine Land Office Corner? No

If not, why? U. S. F. S. Corner.

One, probably County, B. T.

George H. Jennings

(Signature)

9-24-35-

(Date)

Const. Foreman. G&M

(Title)

Metal Location Poster is on a W. Cedar tree 6 inches diameter, on the N side of tree from which this Corner bears North 0.28 chains distant. Give any further facts which will aid in finding this Corner again. Picket line intersection.

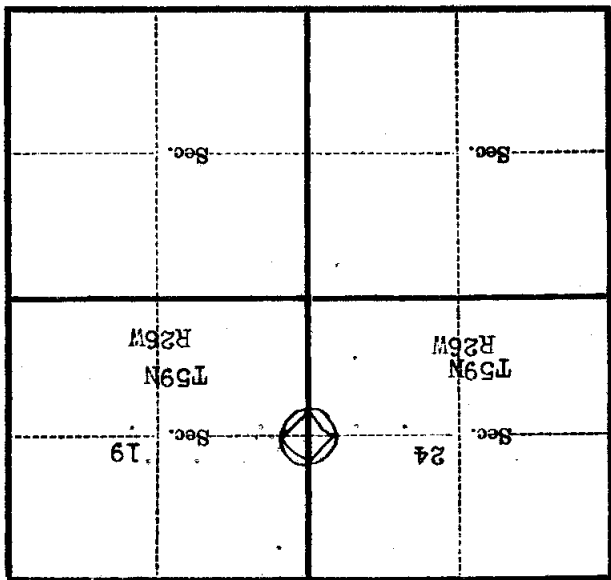

(Make sketch of topography near Corner)