

Form 874-B—Revised May, 1918  
 U. S. Department of Agriculture  
 FOREST SERVICE

A-5

Chippewa NATIONAL FOREST

CORNERS OF THE PUBLIC SURVEY

T. 54-58 R. 26 W 4<sup>th</sup> Mer.

Section Corner common to Sections  
31, 32, 5, and 6

Corner consists of a Brick post (not) in place

State condition rotted at bottom

Dimensions above ground by iron gauge inches

Sketch grooves, letters, figures, or notches, on proper face or edge.

CARDINAL POSITION

DIAGONAL POSITION

--	--	--	--

--	--	--	--

N W S E

NW SW SE NE

Mound of \_\_\_\_\_ is located \_\_\_\_\_

Pits are located \_\_\_\_\_

Sketch markings of Bearing Trees (or Rocks) in proper box and fill blanks below, giving bearings from Corner to Trees and Distances in Links.

	<u>See</u> <u>32</u>	<u>See</u> <u>37</u>	<u>See</u>
	<u>BT</u>	<u>BT</u>	

Species Balsam Poplar Cedar Birch

Diameter 9" 12" 12"

Bearing N 55° E N 68° E N 79° W

Distance 107 lks 125 lks 143 lks

Do you believe this to be a genuine Land Office Corner? \_\_\_\_\_

If not, why? \_\_\_\_\_

Resurveyed by county

Musbeck-Niebrub

(Signature)

10/22/36  
(Date)

S. Clerk  
(Title)

Corner again.  
 Co. corner Post by on ground, taken  
 up with level and level about 1/4 mile  
 East of corner  
 location given also on F.S. Map  
 Post No. of T. 591 and No. of  
 corner in map.

Give any further facts which will aid in finding this  
 chains distant.

from which this Corner bears  
 side of  
 tree 9 inches diameter, on the  
 Metal Location Poster is on a  
*Topography poster*

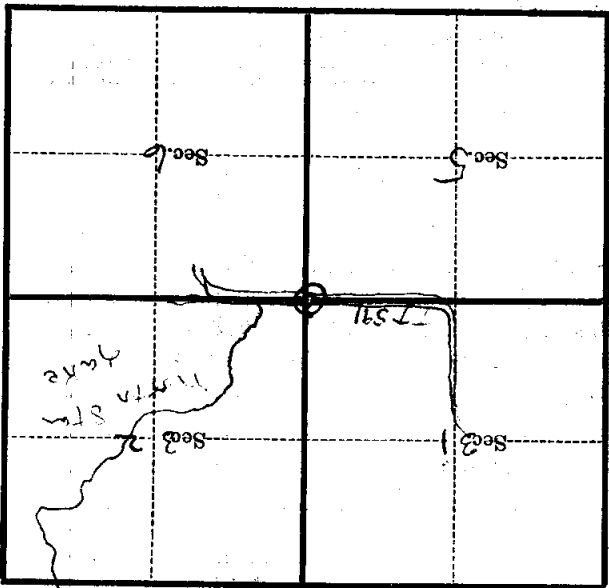

(Make sketch of topography near Corner)

T. 59. 58 N. R. 25 W. 44 Mer.