

U. S. Department of Agriculture
FOREST SERVICE

Chippewa NATIONAL FOREST *D 4*
CORNERS OF THE PUBLIC SURVEY

T. *58 N* R. *26 W* *4th* Mer.

S.E. 1/16 Corner common to Sections

....., and *6*

Corner consists of a *4" Aspen Post* (not) in place
State condition *Post set from B.T.*

Dimensions above ground *40* inches

Sketch grooves, letters, figures, or notches, on proper face or edge.

CARDINAL POSITION

DIAGONAL POSITION

--	--	--	--

N W S E

--	--	--	--

NW SW SE NE

Mound of is located

Pits are located

Sketch markings of Bearing Trees (or Rocks) in proper box and fill blanks below, giving bearings from Corner to Trees and Distances in Links.

Species *Cedar*

Diameter *8"*

Bearing *N 25° W*

Distance *21163*

Do you believe this to be a genuine Land Office Corner? *No*

If not, why? *Records show it was set by*

County Surveyor

H. Hamalainen

(Signature)

Enrollee

(Title)

1/11/40

(Date)

Corner again.

Give any further facts which will aid in finding this

chains distant.

from which this Corner bears

side of

tree inches diameter, on the

Metal Location Poster is on a *The B.T.*

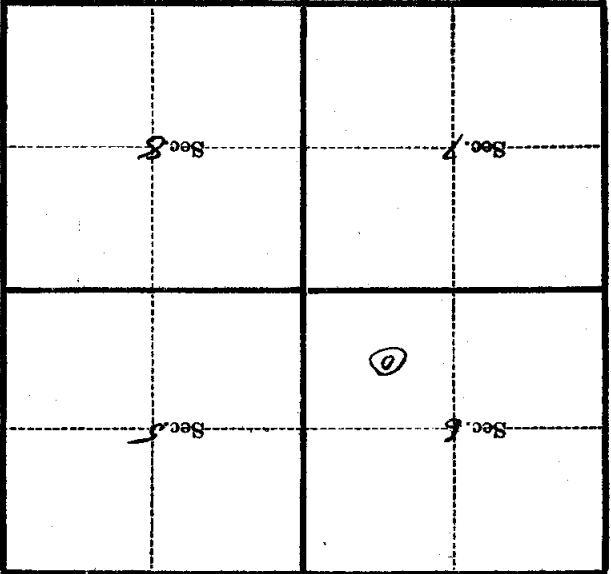

(Make sketch of topography near Corner)

T. 58 N. R. 26 W. 9th Mer.

Form 874-9—Revised May, 1918
U. S. Department of Agriculture
FOREST SERVICE

D-4

Chippewa NATIONAL FOREST

CORNERS OF THE PUBLIC SURVEY

T. 58N R. 26W 9th Mer.

S. E 1/16 Corner common to sections

.....,, ~~1~~ 6

Corner consists of a 4" Aspen Post (not) in place

State condition Post set from B.T.

Dimensions above ground 40 inches

Sketch grooves, letters, figures, or notches, on proper face or edge.

CARDINAL POSITION

DIAGONAL POSITION

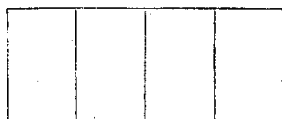
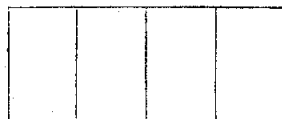

N W S E

NW SW SE NE

Mound of is located

Pits are located

Sketch markings of Bearing Trees (or Rocks) in proper box and fill blanks below, giving bearings from Corner to Trees and Distances in Links.



Species Cedar

Diameter 8"

Bearing N25°W

Distance 2 1/2 links

Do you believe this to be a genuine Land Office Corner? No

If not, why? Records show it was set by County Surveyor

Harold Hanslan

(Signature)

Enroller

(Title)

1/11/90

(Date)

Metal Location Poster is on *the B.T.*
 tree inches diameter, on the
 side of
 from which this Corner bears
 chains distant.
 Give any further facts which will aid in finding this
 Corner again.

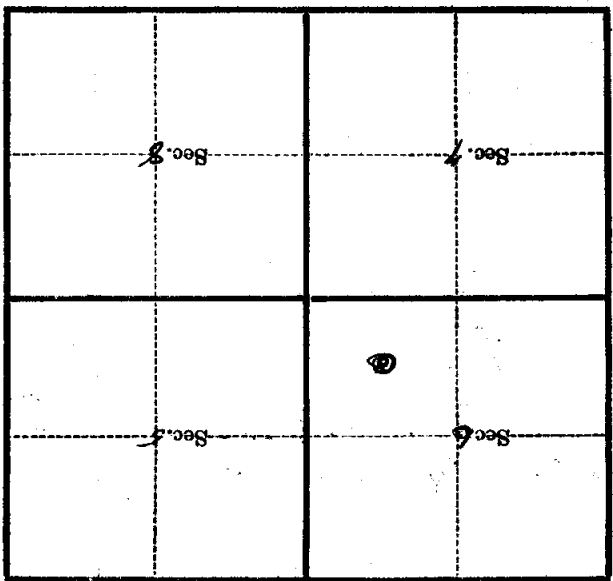

(Make sketch of topography near Corner)

T. 58N R. 26W Mer. *9th*

Camp copy

U. S. Department of Agriculture
FOREST SERVICE

D-5

Chippewa NATIONAL FOREST

CORNERS OF THE PUBLIC SURVEY

T. 58 R. 26 4 Mer.

1/16 #7

Corner common to Sections

-----, -----, and 6

Corner consists of a Cedar Post () in place

State condition Good

Dimensions above ground 4' + 4' + 40 inches

Sketch grooves, letters, figures, or notches, on proper face or edge.

CARDINAL POSITION

DIAGONAL POSITION

1/16 #	1/16	1/16	1/16
5/6	7	5/6	#7
N	W	S	E

NW	SW	SE	NE

Mound of ----- is located -----

----- Pits are located -----

Sketch markings of Bearing Trees (or Rocks) in proper box and fill blanks below, giving bearings from Corner to Trees and Distances in Links.

Species Cedar

Diameter 10"

Bearing N. 25. W.

Distance 21.1 Ks

Do you believe this to be a genuine Land Office Corner? No

If not, why? - County Surveyors' Corner

Harold Hamalino

(Signature)

1/17/40

(Date)

C.C.C.

(Title)

Corner again.
The burning tree is
one of the first seen
from the corner.

Give any further facts which will aid in finding this
corner distant.
from which this Corner bears
side of *Tree*
tree *10* inches diameter, on the *SE*
Metal Location Poster is on a *claw*

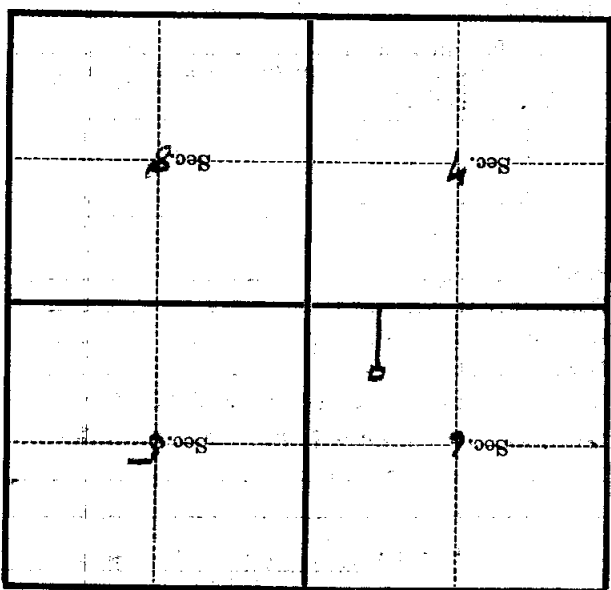

(Make sketch of topography near Corner)

U. S. Department of Agriculture
FOREST SERVICE

D-4

Chippewa NATIONAL FOREST

CORNERS OF THE PUBLIC SURVEY

T. 58N R. 26W. 4th Mer.

S.E. 1/4 Corner common to Sections

....., and 6

Corner consists of a 4" Aspen Post (not) in place

State condition Post set from B.T.

Dimensions above ground 90 inches

Sketch grooves, letters, figures, or notches, on proper face or edge.

CARDINAL POSITION

DIAGONAL POSITION



N W S E



NW SW SE NE

Mound of is located

Pits are located

Sketch markings of Bearing Trees (or Rocks) in proper box and fill blanks below, giving bearings from Corner to Trees and Distances in Links.



Species Cedar

Diameter 8"

Bearing N25°W

Distance 21 lks

Do you believe this to be a genuine Land Office Corner? NO

If not, why? Records show it was set

by County surveyor

H. Hamalainen

(Signature)

Employee

(Title)

11/11/40
(Date)

Metal Location Poster is on *The B.T.* tree inches diameter, on the side of from which this Corner bears chains distant. Give any further facts which will aid in finding this Corner again.

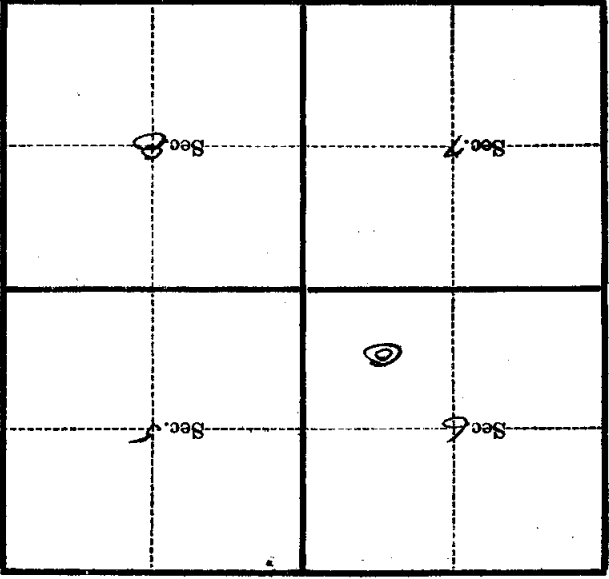

(Make sketch of topography near Corner)

T. 58 N R. 26 W 4th Mer.

U. S. Department of Agriculture
FOREST SERVICE

D-4

Chippewa NATIONAL FOREST

CORNERS OF THE PUBLIC SURVEY

T. 58N. R. 26W. 412 Mer.

1/16 # 7 Corner common to Sections
_____, 6, and _____

Corner consists of a Cedar post (not) in place

State condition Good

Dimensions above ground 40 inches

Sketch grooves, letters, figures, or notches, on proper face or edge.

CARDINAL POSITION

DIAGONAL POSITION

<u>1/16</u> <u>56</u>	<u># 7</u>	<u>1/16</u> <u>56</u>	<u># 7</u>
N	W	S	E

NW	SW	SE	NE

Mound of _____ is located _____

Pits are located _____

Sketch markings of Bearing Trees (or Rocks) in proper box and fill blanks below, giving bearings from Corner to Trees and Distances in Links.

Species Cedar

Diameter 10"

Bearing N. 25° W

Distance 21.6 Ks

Do you believe this to be a genuine Land Office Corner? No

If not, why? County scribing on post

Harold Hamalainen
(Signature)

CCG
(Title)

1/17/40
(Date)

This corner located on the
West of T. 581
Tamarack Swamp

Corner again.

Give any further facts which will aid in finding this

chains distant.

21

from which this Corner bears

S 25° E

side of T. 58

tree 12 inches diameter, on the S.E.

Metal Location Poster is on a cedar

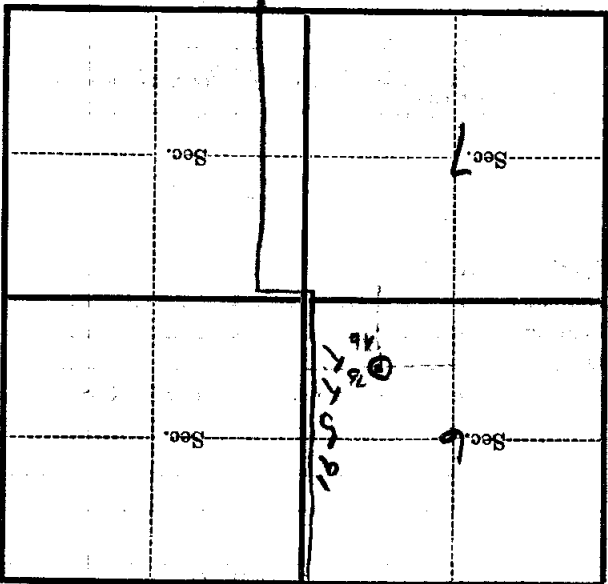

(Make sketch of topography near Corner)

T. 58 R. 25 Mer. 4