

U. S. Department of Agriculture

FOREST SERVICE

L-25

Chippewa NATIONAL FOREST

CORNERS OF THE PUBLIC SURVEY

T. 56 N R. 24-25 4th Mer.

1/4 Corner common to Sections

Corner consists of iron pipe & post (not in place) State condition pipe good - Post new

Dimensions above ground pipe 12 post 5x5x36 inches

Sketch grooves, letters, figures, or notches, on proper face or edge.

CARDINAL POSITION

DIAGONAL POSITION

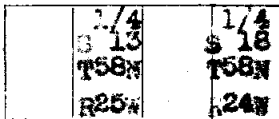

N W S E

NW SW SE NE

Mound of \_\_\_\_\_ is located \_\_\_\_\_

Pits are located \_\_\_\_\_

Sketch markings of Bearing Trees (or Rocks) in proper box and fill blanks below, giving bearings from Corner to Trees and Distances in Links.



Species Maple (fallen)

Diameter 10

Bearing S 41° W

Distance 0.30 ch

Do you believe this to be a genuine Land Office Corner? Yes

If not, why? Reestablished by county surveyor about 1915. It erroneously scribed as 12"

Gath E. Peterson (Signature)

5/11/38 (Date)

Jr. Asst. to Tech. (Title)

(Make sketch of topography near Corner)

T. 38 N R. 24-25 E 4th Mer.

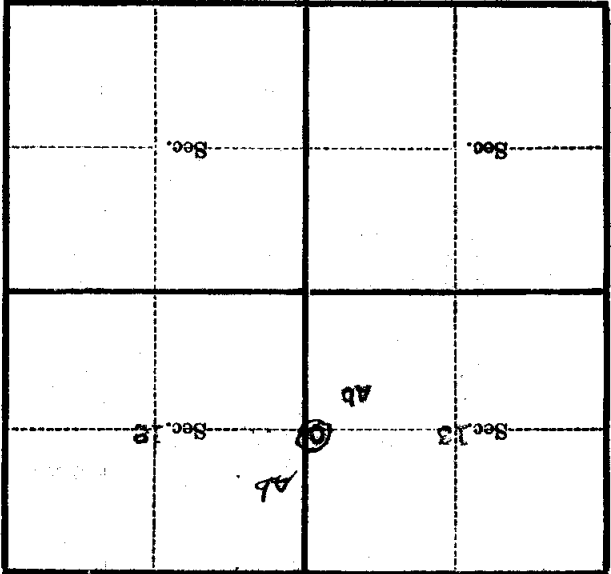

Metal Location Poster is on a

tree 8 inches diameter, on the west

side of brushed out line

from which this Corner bears N 76° E

0.25

chains distant.

Give any further facts which will aid in finding this

Corner again.

Large white pine N 49° E about

4 chains.

U. S. Department of Agriculture  
FOREST SERVICE

1-25

Chippewa NATIONAL FOREST

CORNERS OF THE PUBLIC SURVEY

T. 58 N R. 29 & 25 W 4th Mer.

1/4 Corner common to Sections

Corner consists of a 13 and 18  
6" scribed Post  
1" X 8" Iron Pipe (not) in place

State condition Good

Dimensions above ground 36 inches

Sketch grooves, letters, figures, or notches, on proper face or edge.

CARDINAL POSITION

DIAGONAL POSITION

|  |                       |  |                       |
|--|-----------------------|--|-----------------------|
|  | 45.13<br>T58N<br>R25W |  | 45.18<br>T58N<br>R25W |
|--|-----------------------|--|-----------------------|

|  |  |  |  |
|--|--|--|--|
|  |  |  |  |
|--|--|--|--|

N W S E

NW SW SE NE

Mound of \_\_\_\_\_ is located \_\_\_\_\_

Pits are located \_\_\_\_\_

Sketch markings of Bearing Trees (or Rocks) in proper box and fill blanks below, giving bearings from Corner to Trees and Distances in Links.

|  |  |  |  |
|--|--|--|--|
|  |  |  |  |
|  |  |  |  |

Species \_\_\_\_\_

Diameter \_\_\_\_\_

Bearing \_\_\_\_\_

Distance \_\_\_\_\_

Do you believe this to be a genuine Land Office Corner? NO

If not, why? Probably set by County Surveyor  
judging by app. Post.

Arthur J. Johnson

(Signature)

Special Foreman

(Title)

2/26/40

(Date)

(Make sketch of topography near Corner)

T. 58 N. R. 27425 W. 276 Mer.

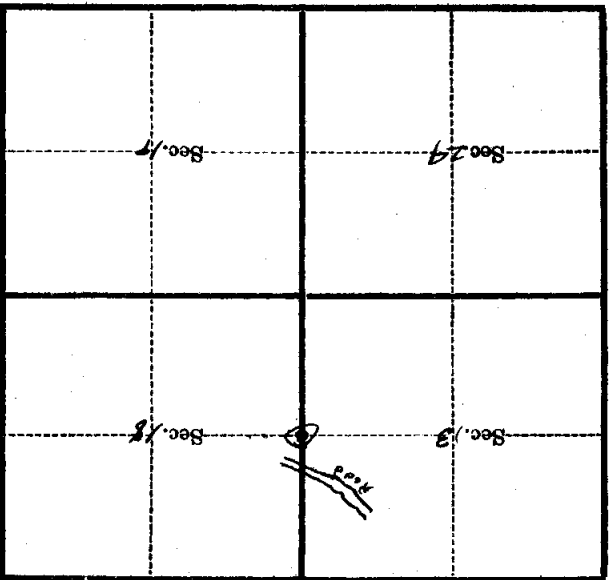

Metal Location Poster is on a *Aspen*

tree *4* inches diameter, on the

side of

from which this Corner bears *N 76° E*

*25* chains distant.

Give any further facts which will aid in finding this

Corner again.

U. S. Department of Agriculture  
FOREST SERVICE

1-25

Chippewa NATIONAL FOREST

CORNERS OF THE PUBLIC SURVEY

T. 58 N R. 29 & 25 W. 9th Mer.

1/4 Corner common to Sections

Corner consists of a 6" scribbled post (not) in place

State condition Good

Dimensions above ground 36 inches

Sketch grooves, letters, figures, or notches, on proper face or edge.

CARDINAL POSITION

DIAGONAL POSITION

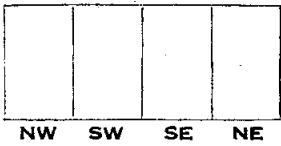
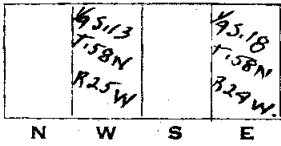

Mound of \_\_\_\_\_ is located \_\_\_\_\_

Pits are located \_\_\_\_\_

Sketch markings of Bearing Trees (or Rocks) in proper box and fill blanks below, giving bearings from Corner to Trees and Distances in Links.



Species \_\_\_\_\_

Diameter \_\_\_\_\_

Bearing \_\_\_\_\_

Distance \_\_\_\_\_

Do you believe this to be a genuine Land Office Corner? N.O

If not, why? Probably set by County Surveyor judging from age of Post

Arthur J. Johnson  
(Signature)

Special Foreman  
(Title)

2/26/90  
(Date)

(Make sketch of topography near Corner)

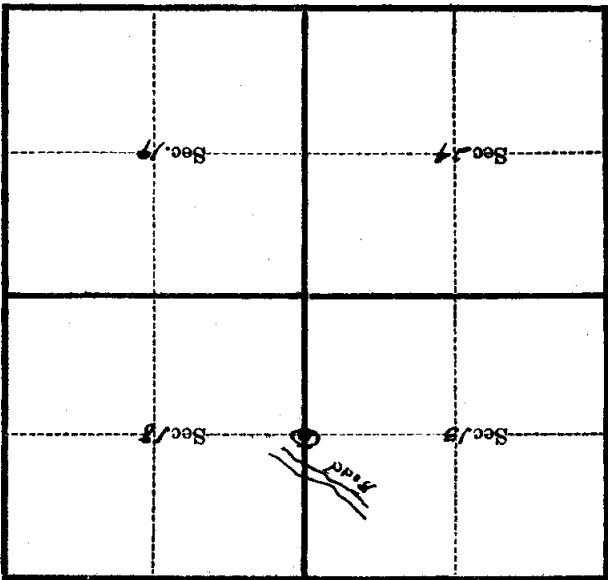

T. 58N R. 29E W. 9th. Mer.

Metal Location Poster is on a *Hesper*

tree *7* inches diameter, on the

side of

from which this Corner bears *N 76° E*

*85* chains distant.

Give any further facts which will aid in finding this

Corner again.

## U. S. Department of Agriculture

## FOREST SERVICE

Chippewa NATIONAL FOREST L 25

## CORNERS OF THE PUBLIC SURVEY

T. 58 N R. 24-25 W 4th Mer.

1/4 Corner common to Sections

13, and 18

Corner consists of ~~iron pipe & post~~ <sup>Aspen</sup> (not) in placeState condition ~~pipe good-- post new~~Dimensions above ground ~~pipe 4x12 post~~ <sup>5x5x36</sup> inches

Sketch grooves, letters, figures, or notches, on proper face or edge.

CARDINAL POSITION

DIAGONAL POSITION

|   |     |   |     |
|---|-----|---|-----|
|   | 1/4 |   | 1/4 |
| S | 13  | S | 18  |
| T | 58N | T | 58N |
| R | 25W | R | 24W |

N W S E

|  |  |  |  |
|--|--|--|--|
|  |  |  |  |
|  |  |  |  |
|  |  |  |  |
|  |  |  |  |

NW SW SE NE

Mound of \_\_\_\_\_ is located \_\_\_\_\_

Pits are located \_\_\_\_\_

Sketch markings of Bearing Trees (or Rocks) in proper box and fill blanks below, giving bearings from Corner to Trees and Distances in Links.

|             |  |  |  |
|-------------|--|--|--|
| 1/4<br>S 12 |  |  |  |
| BT          |  |  |  |

Species Maple (fallen)Diameter 10Bearing S 41° WDistance 0.30 chDo you believe this to be a genuine Land Office Corner? YesIf not, why? Reestablished by Countysurveyor about 1915. BT erroneouslyscribed as 12°Seth W. Peterson  
(Signature)5/11/38  
(Date)Jr. Asst. to Tech.  
(Title)

Large white pine N 49° E about 4 chains.

Corner again.

Give any further facts which will aid in finding this

0.25 chains distant.

from which this Corner bears N 76° E

side of brushed out line

tree 8 inches diameter, on the west

Metal Location Poster is on a Aspen

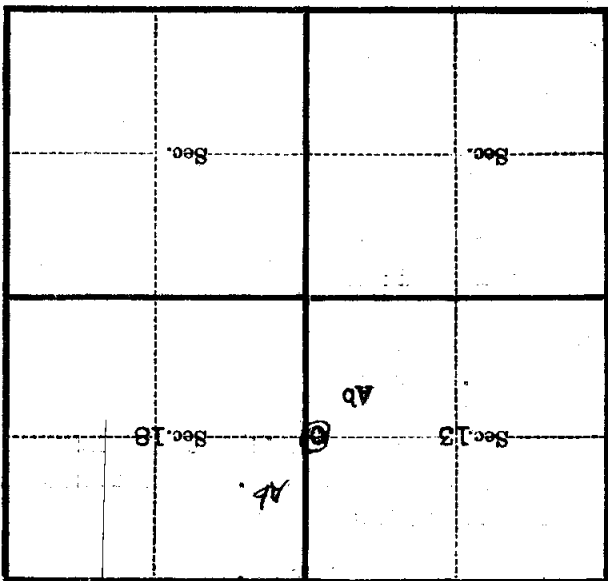

(Make sketch of topography near Corner)

T. 58 N R. 24-25 W 4th Mer.