

U. S. Department of Agriculture
FOREST SERVICE

A-17

NATIONAL FOREST

CORNERS OF THE PUBLIC SURVEY

T. 58 R. 25 Mer.

On Rip Line Corner common to Sections 3, 2, and

Corner consists of a I.P.P. with Cap in place
State condition Good

Dimensions above ground 24" inches

Sketch grooves, letters, figures, or notches, on proper face or edge.

CARDINAL POSITION

DIAGONAL POSITION

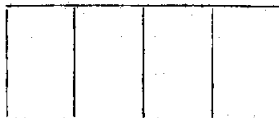

N W S E

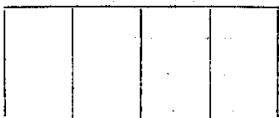

NW SW SE NE

Mound of _____ is located _____

Pits are located _____

Sketch markings of Bearing Trees (or Rocks) in proper box and fill blanks below, giving bearings from Corner to Trees and Distances in Links.

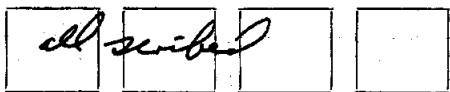

Species	<u>B. Sp</u>	<u>Maple</u>	<u>B.S</u>	<u>B.S</u>
Diameter	<u>6</u>	<u>4"</u>	<u>7"</u>	<u>7"</u>
Bearing	<u>S85W</u>	<u>S35E</u>	<u>NSW</u>	<u>N30E</u>
Distance	<u>35'</u>	<u>45'</u>	<u>28'</u>	<u>30'</u>

Do you believe this to be a genuine Land Office Corner? _____

If not, why? No - set 1954 by Com

R. H. Christensen

(Signature)

D. F. R.

(Title)

12-14-54

(Date)

Metal Location Poster is on a tree _____ inches diameter, on the _____ side of _____ from which this Corner bears _____ chains distant.

Give any further facts which will aid in finding this Corner again.

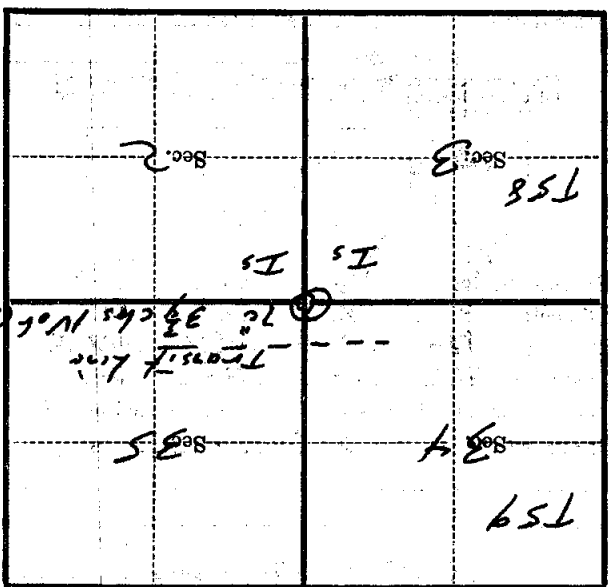

(Make sketch of topography near Corner)