

Form 874-9-Revised May, 1918  
U. S. Department of Agriculture  
FOREST SERVICE

11-17

Chippewa NATIONAL FOREST

CORNERS OF THE PUBLIC SURVEY

T. 57N R. 27W 4th Mer.

Section Corner common to Sections  
14, 15, 22, and 23

Corner consists of a None (not) in place  
State condition

Dimensions above ground \_\_\_\_\_ inches

Sketch grooves, letters, figures, or notches, on proper face or edge.

CARDINAL POSITION

DIAGONAL POSITION

--	--	--	--

N W S E

--	--	--	--

NW SW SE NE

Mound of \_\_\_\_\_ is located \_\_\_\_\_

\_\_\_\_\_ Pits are located \_\_\_\_\_

Sketch markings of Bearing Trees (or Rocks) in proper box and fill blanks below, giving bearings from Corner to Trees and Distances in Links.

5.14			

Species W. Pine

Diameter 2.2"

Bearing N 70° E

Distance 146.142

Do you believe this to be a genuine Land Office Corner? Yes

If not, why? \_\_\_\_\_

Arthur J. Johnson

(Signature)

Guard Foreman

(Title)

2/9/40  
(Date)

X

N-17

Corner again.  
Corney falls in road intersection.  
Remaining B.T. checks with B.L.O.  
Notes: 6

Metal Location Poster is on a the B.T.  
tree inches diameter, on the N.E.  
side of Road Intersection  
from which this Corner bears 370° W  
176 chains distant.  
Give any further facts which will aid in finding this

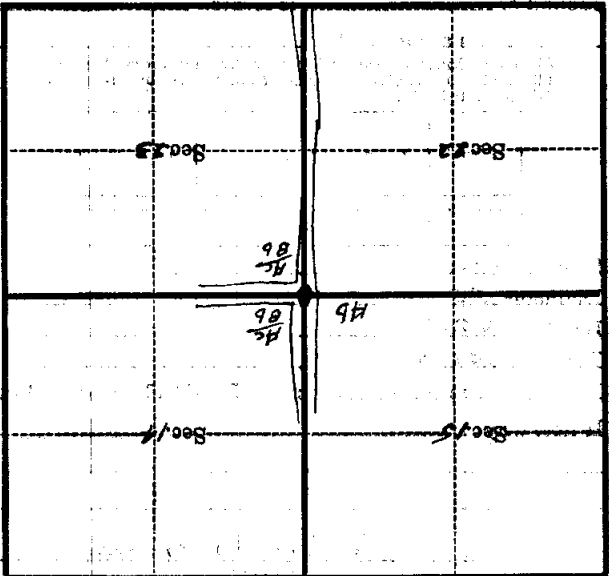

(Make sketch of topography near Corner)

T. 57N R. 22W 9th Mer.

U. S. Department of Agriculture

FOREST SERVICE

N 17

Chippewa NATIONAL FOREST

CORNERS OF THE PUBLIC SURVEY

T. 57N R. 27W 9th Mer.

Section Corner common to Sections  
14, 15, 22, and 23

Corner consists of a None (not) in place  
State condition

Dimensions above ground \_\_\_\_\_ inches

Sketch grooves, letters, figures, or notches, on proper face or edge.

CARDINAL POSITION

DIAGONAL POSITION

--	--	--	--

N W S E

--	--	--	--

NW SW SE NE

Mound of \_\_\_\_\_ is located \_\_\_\_\_

Pits are located \_\_\_\_\_

Sketch markings of Bearing Trees (or Rocks) in proper box and fill blanks below, giving bearings from Corner to Trees and Distances in Links.

3.14			

Species W. Pine

Diameter 22"

Bearing N 70° E

Distance 126 lks.

Do you believe this to be a genuine Land Office Corner? Yes.

If not, why? \_\_\_\_\_

Arthur J. Johnson

(Signature)

Squad Foreman

(Title)

2/9/40

(Date)

Corner again.  
Larner falls in road intersection.  
Remaining B.I. checks with G.H. notes.

Give any further facts which will aid in finding this  
17b chains distant.

from which this Corner bears  
side of road intersection  
tree inches diameter, on the N.E.  
Metal Location Poster is on a the B.I.

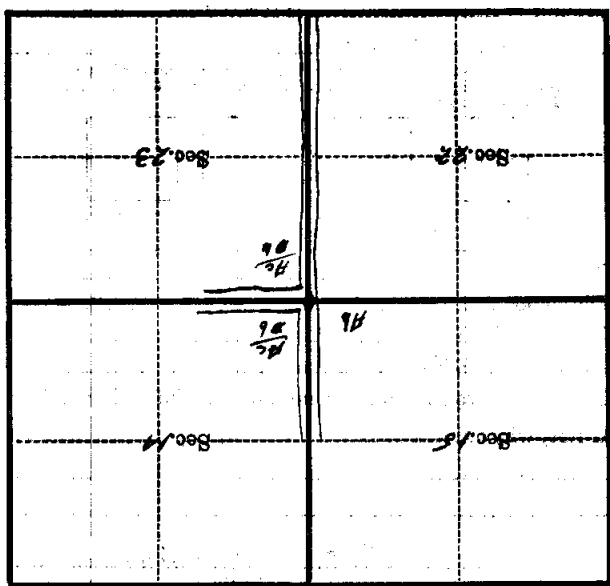

(Make sketch of topography near Corner)

T. 57N R. 27W 9th Mer.

Form 874-9—Revised May, 1918  
 U. S. Department of Agriculture  
 FOREST SERVICE

N-17

Shippewa NATIONAL FOREST

CORNERS OF THE PUBLIC SURVEY

T. 57N. R. 27W. 9th Mer.

Section Corner common to Sections  
12, 15, 22, and 23

Corner consists of a \_\_\_\_\_ (not) in place  
 State condition \_\_\_\_\_

Dimensions above ground \_\_\_\_\_ inches

Sketch grooves, letters, figures, or notches, on proper face or edge.

CARDINAL POSITION

DIAGONAL POSITION

--	--	--	--

--	--	--	--

N W S E

NW SW SE NE

Mound of \_\_\_\_\_ is located \_\_\_\_\_

Pits are located \_\_\_\_\_

Sketch markings of Bearing Trees (or Rocks) in proper box and fill blanks below, giving bearings from Corner to Trees and Distances in Links.

S. 14			

Species W. Pine \_\_\_\_\_

Diameter 22" \_\_\_\_\_

Bearing N 70° E \_\_\_\_\_

Distance 196 lks \_\_\_\_\_

Do you believe this to be a genuine Land Office Corner? Yes

If not, why? \_\_\_\_\_

Arthur J. Johnson

(Signature)

Special Foreman

(Title)

2/9/90

(Date)

N-17

This Corner lies in center of  
Roads running N, S & E. The B.T.  
that is left checks with the  
original survey notes

Corner again.

Give any further facts which will aid in finding this

1.76 chains distant.

from which this Corner bears S 70° W

side of Road Intersection

tree inches diameter, on the N.E. side

Metal Location Poster is on the B.T.

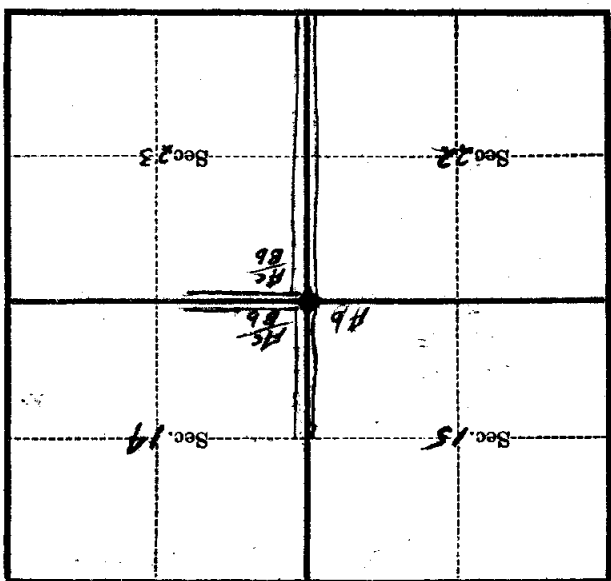

(Make sketch of topography near Corner)

T. 59N R. 27W 916 Mer.