

Form 874-9—Revised May, 1918
 U. S. Department of Agriculture
 FOREST SERVICE

G-4-21
~~51~~

Chippewa NATIONAL FOREST
 CORNERS OF THE PUBLIC SURVEY

T. 57 N R. 26 W 4th Mer.

M.C. Corner common to Sections
 11, and 12

Corner consists of a 4" ASPEN (not) in place
 State condition good

Dimensions above ground 3' high inches

Sketch grooves, letters, figures, or notches, on proper face or edge.

CARDINAL POSITION

DIAGONAL POSITION

	S		S
	11		12
N	W	S	E

NW	SW	SE	NE

Mound of _____ is located _____

Pits are located _____

Sketch markings of Bearing Trees (or Rocks) in proper box and fill blanks below, giving bearings from Corner to Trees and Distances in Links.

	S		S
	11		12
	B.T		B.T

Species aspen aspen

Diameter 5" 17"

Bearing N73°W S62°W

Distance 65.4 35.1

Do you believe this to be a genuine Land Office Corner? Yes

If not, why? _____

Erwin M. ...
 (Signature)

12-21-34
 (Date)

Field Ass't
 (Title)

6-21

LAND LEVEL, SECOND
GROWTH ASPEN

Corner again.

Give any further facts which will aid in finding this

357.1. ~~chain~~ distant.

From which this Corner bears N 62° E

side of tree

tree 7 inches diameter, on the N. E

Metal Location Poster is on a ASPEN

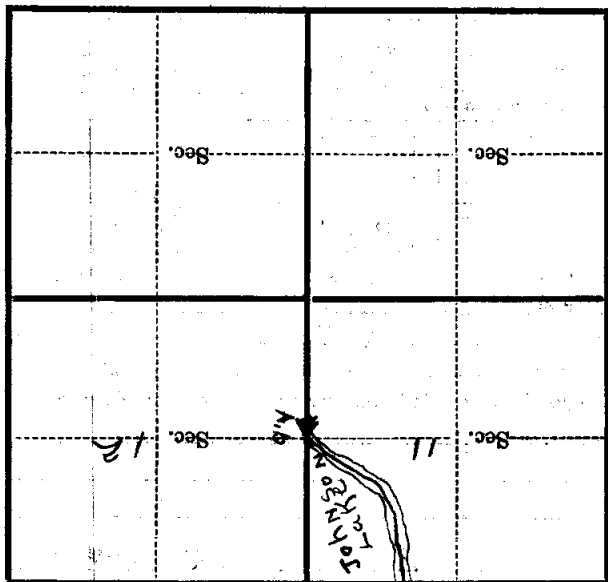

(Make sketch of topography near Corner)

T. 57 N R. 26 W 4th Mer.

U. S. Department of Agriculture

FOREST SERVICE

Eastern

Chippewa NATIONAL FOREST G-421

CORNERS OF THE PUBLIC SURVEY

T. 57 N R. 26 W 4th Mer.

M.C. Corner common to Sections
 _____, _____, 11, and 12

Corner consists of a 4" aspen (not) in placeState condition goodDimensions above ground 3' high inches

Sketch grooves, letters, figures, or notches, on proper face or edge.

CARDINAL POSITION

DIAGONAL POSITION

	S		S
	11		12

N W S E

NW SW SE NE

Mound of _____ is located _____

Pits are located _____

Sketch markings of Bearing Trees (or Rocks) in proper box and fill blanks below, giving bearings from Corner to Trees and Distances in Links.

	S 11		S 12
	BT		BT

Species aspen aspenDiameter 5" 7"Bearing N 73° W S 62° WDistance 65 Li. 35 Li.Do you believe this to be a genuine Land Office Corner? YES

If not, why? _____

Ernie Menger
 (Signature)

Field Ass't.
 (Title)

12-21-34
 (Date)

Corner again.

Land level, second growth aspen.

Give any further facts which will aid in finding this

35 ft. chains distant.

From which this Corner bears N 62° E

side of Tree

tree 7 inches diameter, on the N.E.

Metal Location Poster is on a aspen

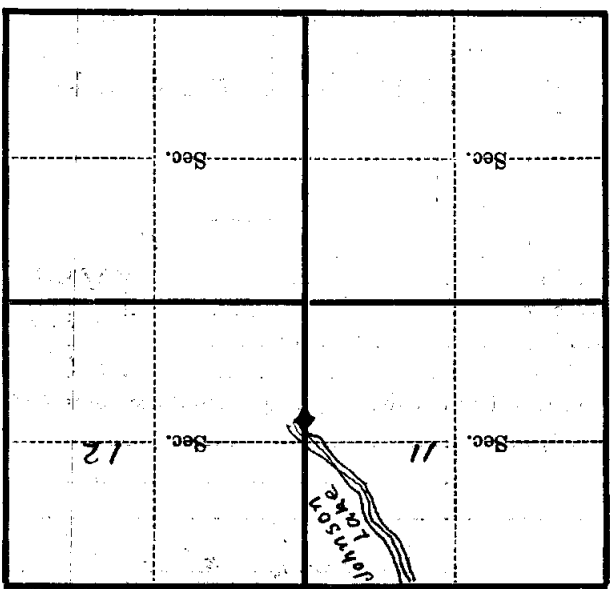

(Make sketch of topography near Corner)

T. 57 N. R. 26 W. 4th Mer.

Form 874-9—Revised May, 1918
U. S. Department of Agriculture
FOREST SERVICE

G-11-21
G-11-21

Chippewa NATIONAL FOREST

CORNERS OF THE PUBLIC SURVEY

T. 57 N R. 26 W 4th Mer.

M.C. Corner common to Sections
11, and 12

Corner consists of a 4" aspen (not) in place
State condition good

Dimensions above ground 3' high inches

Sketch grooves, letters, figures, or notches, on proper face or edge.

CARDINAL POSITION

DIAGONAL POSITION

	S		S
	11		12
N	W	S	E

NW	SW	SE	NE

Mound of _____ is located _____

Pits are located _____

Sketch markings of Bearing Trees (or Rocks) in proper box and fill blanks below, giving bearings from Corner to Trees and Distances in Links.

	S		S
	11		12
	BT		BT

Species aspen aspen
Diameter 5" 7"
Bearing N 73° W S 62° W
Distance 65 Li. 35 Li.

Do you believe this to be a genuine Land Office Corner? yes

If not, why? _____

E. M. M. M. M.
(Signature)

12-21-34
(Date)

Field Ass't
(Title)

6-21

Land level, second growth with aspen.

Corner again.

Give any further facts which will aid in finding this

35.7! chains distant.

from which this Corner bears N 62° E

side of Trees

tree 7 inches diameter, on the N E

Metal Location Poster is on a ASPEN

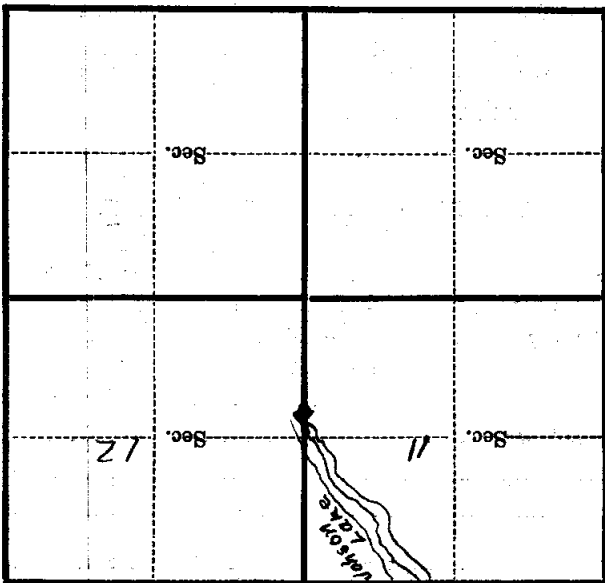

(Make sketch of topography near Corner)

T. 57 N R. 26 W. 4th Mer.