

U. S. Department of Agriculture
FOREST SERVICE

5-17

Chippewa NATIONAL FOREST
CORNERS OF THE PUBLIC SURVEY

T. 57 N R. 26 W 4th Mer.
Sec. Corner common to Sections

10, 11, 14, and 15

Corner consists of a 4" Maple (not) in place
State condition good

Dimensions above ground 2' 6" inches

Sketch grooves, letters, figures, or notches, on proper face or edge.

CARDINAL POSITION

DIAGONAL POSITION

N	W	S	E

S	S	S	S
10	15	14	11
NW	SW	SE	NE

Mound of _____ is located _____

Pits are located _____

Sketch markings of Bearing Trees (or Rocks) in proper box and fill blanks below, giving bearings from Corner to Trees and Distances in Links.

S	S	S	S
10	15	14	11
B.T		B.T	

Species W. pine W. pine, stump

Diameter 14" 22"

Bearing N 38 W S 35 E

Distance 163 li 33 li

Do you believe this to be a genuine Land Office Corner? yes

If not, why? _____

Erwin Meagher
(Signature)

12-4-34
(Date)

Field Ass't
(Title)

J-17

cor. is 3.30 chs, from
 Big Horn Trail,
 7.96 chs. E to small
 lake, second growth
 ASPEN, Hazel under
 brush, and rolling

Corner again.

Give any further facts which will aid in finding this

163-11 - chains distant.

from which this Corner bears

S. 38° E

side of tree

tree 4 inches diameter, on the

W Pine S.E

Metal Location Poster is on a

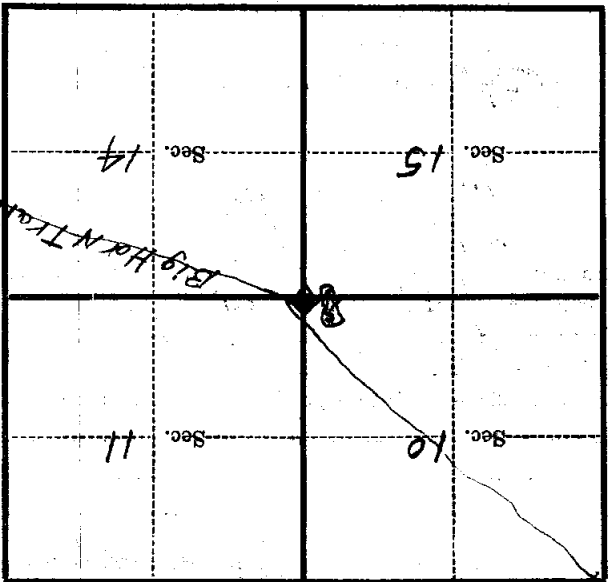

(Make sketch of topography near Corner)

T. 57N R. 26W 7th Mer.

U. S. Department of Agriculture
FOREST SERVICE

J-17

Chippewa NATIONAL FOREST
CORNERS OF THE PUBLIC SURVEY

T. 57N R. 26W 4th Mer.

Sec. Corner common to Sections
10, 11, 14, and 15

Corner consists of a 4" Maple (not) in place

State condition good

Dimensions above ground 2' 6" inches

Sketch grooves, letters, figures, or notches, on proper face or edge.

CARDINAL POSITION

DIAGONAL POSITION

N	W	S	E

S	S	S	S
10	15	14	11
NW	SW	SE	NE

Mound of _____ is located _____

Pits are located _____

Sketch markings of Bearing Trees (or Rocks) in proper box and fill blanks below, giving bearings from Corner to Trees and Distances in Links.

S 10		S 14	
B.T.		B.T.	

Species W. pine W. pine, stump

Diameter 14" 22"

Bearing N. 38° W S. 35° E

Distance 163-li 33 li

Do you believe this to be a genuine Land Office Corner? yes

If not, why? _____

Emin Mergler

(Signature)

12-4-34
(Date)

Field Ass't
(Title)

21.8

Cor. is 3.30 chs, from
Big Horn Trail
7.96 chs. E. to SW all
L. 96 chs. Second growth
Aspen, Hazel & Alder
brush, Land rolling

Corner again.

Give any further facts which will aid in finding this

163.71' chains distant.

from which this Corner bears

S. 38. E

side of tree

tree 1/4 inches diameter, on the

Metal Location Poster is on a

W. PINE

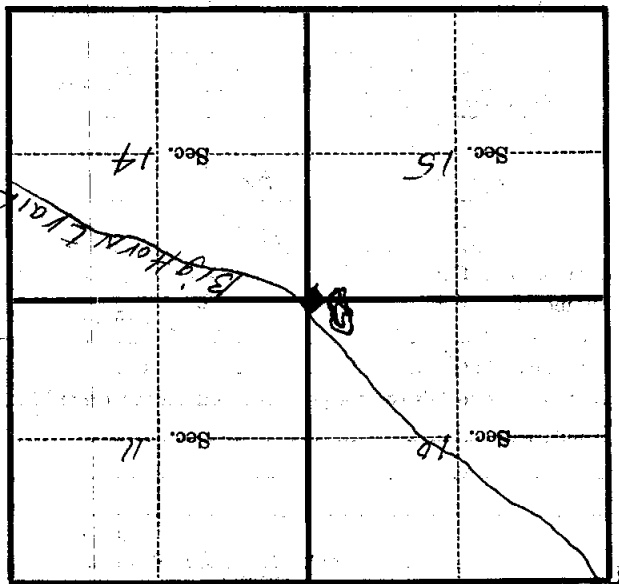

(Make sketch of topography near Corner)

T. 57 N R. 26 W 4th Mer.

U. S. Department of Agriculture
 FOREST SERVICE
 P. J. [unclear]

 Chippewa NATIONAL FOREST J 17
 CORNERS OF THE PUBLIC SURVEY

T. 57N R. 26W 4th Mer.

Sec _____ Corner common to Sections

10, 11, 14, and 15

Corner consists of a 4" Maple (not) in place

State condition good

Dimensions above ground 2' 6" inches

Sketch grooves, letters, figures, or notches, on proper face or edge.

CARDINAL POSITION

DIAGONAL POSITION

--	--	--	--

N W S E

S	S	S	S
10	15	14	11

NW SW SE NE

Mound of _____ is located _____

Pits are located _____

Sketch markings of Bearing Trees (or Rocks) in proper box and fill blanks below, giving bearings from Corner to Trees and Distances in Links.

S 10	
---------	--

--	--

S 14	
---------	--

--	--

B.T.	
------	--

--	--

B.T.	
------	--

--	--

Species W. pine W. pine, stump

Diameter 14" 22"

Bearing N 38° W S 35° E

Distance 163-Li 33-Li

Do you believe this to be a genuine Land Office Corner? yes

If not, why? _____

Erwin Meagher

(Signature)

12-7-34

(Date)

Field Ass't

(Title)

cor. 15 3.30 chs, from
 Big Horn trail,
 796 chs. E. to small
 lake, second growth
 aspen, hazel under
 brush, land rolling

Corner again.

Give any further facts which will aid in finding this

163-71 chains distant.

from which this Corner bears

S. 38° E

side of tree

tree 14 inches diameter, on the

W/PINE
 S.E

Metal Location Poster is on a

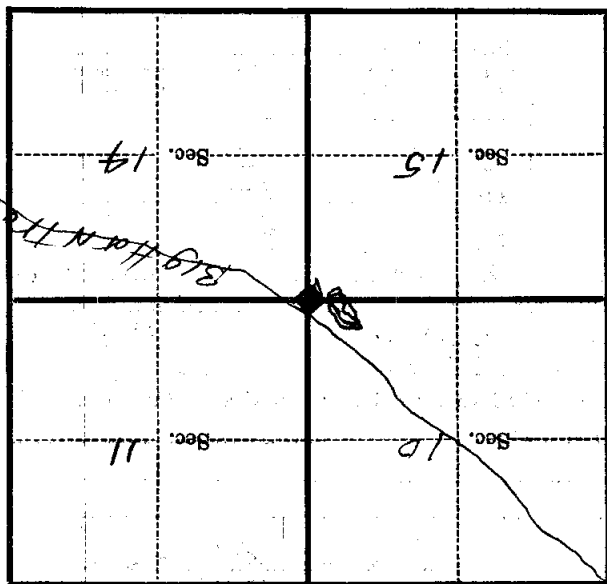

(Make sketch of topography near Corner)

T. 57 N R. 26 W 4th Mer.