

136-50

Maple Tab

FINAL ROAD ORDER OF TOWN BOARD

Filed this 16<sup>th</sup> day of October A. D. 1909.

W. H. Huffman  
Town Clerk

The within Road Order, together with the Award of Damages was recorded by me this 25<sup>th</sup> day of September 1909, in the Road Record Book of the Township, and then sent by me to the County Auditor, to be filed and preserved by him.

W. H. Huffman  
Town Clerk

Office of County Auditor,

County of Leas Minn.

Filed this 2<sup>nd</sup> day of Dec, 1909, at 9 o'clock A. M., in this office.

W. H. Huffman  
County Auditor

Within five days after date of within order Town Board shall make its Award of Damages and file all papers pertaining to the road with the Town Clerk. The Town Clerk must not record this order within thirty days after filing, and not then, if an appeal has been taken, until the order is confirmed on appeal. But if no appeal is taken, or if on appeal this order is confirmed, it, together with the award, must be recorded and then transmitted to the County Auditor, to be filed and preserved by him.

892300

OWNERSHIP AND DESCRIPTION OF LANDS AS GIVEN IN THE PETITION

OWNERS OF LANDS	DESCRIPTION OF LANDS	SECTION	TOWN	RANGE
John Pippinge	N 1/2 SW 1/4	14	136	30
John Pippinge	E 1/2 SE 1/4	15	136	30
Mary Parker	E 1/2 NE 1/4 and E 1/2 SE 1/4	22	136	30
O. W. Halvorson	N 1/2 SW 1/4	23	136	30
J. J. Cruikshank	N 1/2 SW 1/4	23	136	30

The names of the Petitioners, the places where, and the time when copies of the Supervisors' Order or Notice of Hearing were posted; and the names of persons served with the Supervisors' Order or Notice, and how served, are as follows, viz:

NAMES OF PETITIONERS	SUPERVISORS' ORDER OR NOTICE, WHEN AND WHERE POSTED	SUPERVISORS' NOTICE, ON WHOM SERVED	HOW SERVED
Kels Olson Claus T. Olson W. H. Huffman Andrew Brandt John Hylan L. E. Larson * Alfred Johnson Kels Johnson John Pippinge Mrs. Halvorson John Thomsen	On the 5 <sup>th</sup> Oct. 1909, one notice was posted at each of the following public posting places of Maple Township: SE corner of sec. 10; SE corner of sec. 12; NE corner of sec. 26. Twp. 136. R. 30.	Supervisors' notice was personally served on John Pippinge; and on O. W. Halvorson by leaving a notice with Mrs. O. W. Halvorson, wife of O. W. Halvorson, parties being occupiers of land adjoining said road.	By personal service and written notice.

\* The name of Alfred Johnson was omitted & struck from the list of Petitioners by the Town Board since Alfred Johnson was not being legally qualified to sign.

State of Minnesota, County of Leas Town of Inaple SS.

Whereas, Upon the petition of John legal voters who own real estate or who occupy real estate under the homestead or pre-emption laws of the United States, or under contract from the State of Minnesota, within three (3) miles of the road proposed in said petition to be laid out and established, which said petition was filed with the Town Clerk, who forthwith presented it to us for action thereon, and which said proposed road is set forth and described in said petition as follows, viz: Beginning

At the section corner post between sections 22, 23, 26 and 27 Twp: 136 R 30. The course of the road to follow north on the section line between sections 22 and 23 Twp: 136 R 30 for a distance of 35 chains 22 lks (2324.52') to A.P. 1; from thence on a course of N 24° 26' E for a distance of 5 chains 84 lks (385.44') to A.P. 2; from thence on a course of N 12° 26' E for a distance of 14 chains 39 lks (949.74') to A.P. 3; from thence on a course of N 76° 26' W for a distance of 7 chains 37 lks (486.42') to A.P. 4; from thence north on the section line between sections 22 and 23 Twp: 136 R 30 for a distance of 25 chains (1650') to the section corner post between sections 14, 15, 22 and 23 Twp: 136 R 30; from thence on a course north on the section line between sections 14 and 15 Twp: 136 R 30 to the Quarter section post between sections 14 and 15 Twp: 136 R 30.

The road to be of the width of four (4) rods where the course is on the section line and where it deviates from the section line, to be of the width of two (2) rods.

And Whereas, Upon receiving said petition, we did, within thirty days thereafter, make out an order or notice of hearing and fix therein a time and place at which we would meet and act upon such petition, to-wit: On the 16 day of October 1909, at 9 o'clock in the forenoon, the place of meeting being at the Quarter section post between sections 14 and 15 Twp: 136 R 30,

causing copies of such notice to be posted in three public places in said Town at least ten days before such meeting; and having met at such time and place as above named in said notice, and being satisfied that the petitioners had, at least ten days previous to said time caused said notice of time and place of hearing to be given to all the occupants of the land through which such highway might pass, by serving the same personally upon each of said occupants, proof of which was shown by affidavit, we proceeded to examine personally such highway, and heard all persons interested, and any and all reasons for or against the laying out and establishment of the same, and being of opinion that such laying out and establishment was necessary and proper, and that the public interest would be promoted thereby, we granted the prayer of said petitioners and determined to layout and establish said road, and caused a survey thereof to be made according to the report and plat herewith accompanying, the description of which as so laid out and established is as follows, to-wit: Beginning

At the section corner post between sections 22, 23, 26 and 27 Twp: 136 R 30. The course of the road to follow north on the section line between sections 22 and 23 Twp: 136 R 30 for a distance of 35 chains 22 lks (2324.52') to A.P. 1; from thence on a course of N 24° 26' E for a distance of 5 chains 84 lks (385.44') to A.P. 2; from thence on a course of N 12° 26' E for a distance of 14 chains 39 lks (949.74') to A.P. 3; from thence on a course of N 76° 26' W for a distance of 7 chains 37 lks (486.42') to A.P. 4; from thence north on the section line between sections 22 and 23 Twp: 136 R 30 for a distance of 25 chains (1650') to the section corner post between sections 14, 15, 22 and 23 Twp: 136 R 30; from thence on a course north on the section line between sections 14 and 15 Twp: 136 R 30 to the Quarter section post between sections 14 and 15 Twp: 136 R 30.

The road to be of the width of four (4) rods where the course is on the section line and where it deviates from the section line, to be of the width of two (2) rods.

To the Board of Supervisors of the Town of \_\_\_\_\_ County of \_\_\_\_\_ and State of Minnesota:

The undersigned, having been employed by you to make a survey of a road in said Town, would report that the following is a correct

Plat  
of

Newly established Road, referred to in, and being the road established by the Final Road Order of Maple Township Supervisors bearing date October 16<sup>th</sup> 1909, which order contains full description of said road, of which the following is a Plat.

AP on the section line running north from the section corner post between sections 22, 23, 26 & 27 T. 136 R. 30 on a V<sup>2</sup> of  $9^{\circ} 26'$  and at a distance from said corner post of 35.22 chain (2324.52') Bearing trees to AP 1. 12 Tam N  $68^{\circ} 26' W$  52 lbs.; 12 oak N  $51^{\circ} E$  80 lbs.

AP 2 at a distance from AP 1 of chain 5.54 (358.44'), on a course of N  $24^{\circ} 26' E$  Bearing trees 3 Jack Pine S  $44^{\circ} 30' W$  2 lbs.; 12 Tam. N  $16^{\circ} 00' E$  14 lbs.

AP 3 " " AP 2 " 14.39 (949.74') " " N  $12^{\circ} 26' E$  " " 12 White Pine S  $55^{\circ} 30' E$  19 lbs.; 12 W. Pine N  $96^{\circ} E$  8 2 lbs.

AP 4 " " AP 3 " 7.37 (486.42') " " N  $76^{\circ} 26' W$  " " 8 Red oak N  $54^{\circ} 30' W$  11 lbs.; 30 W Pine N  $9^{\circ} E$  99 lbs.

J. W. H. Huffman, having been employed by the Town Board of Maple Township to survey and Plat such survey of the road herein shown - Boundaries of which road are shown by red lines & the centre line of such road by a black line - hereby certifies that the above minutes of such survey are correct as to courses, distances, and angles in every particular - J. W. H. Huffman (Surveyor) Oct. 16<sup>th</sup> 1909, Reg'd. Minn.

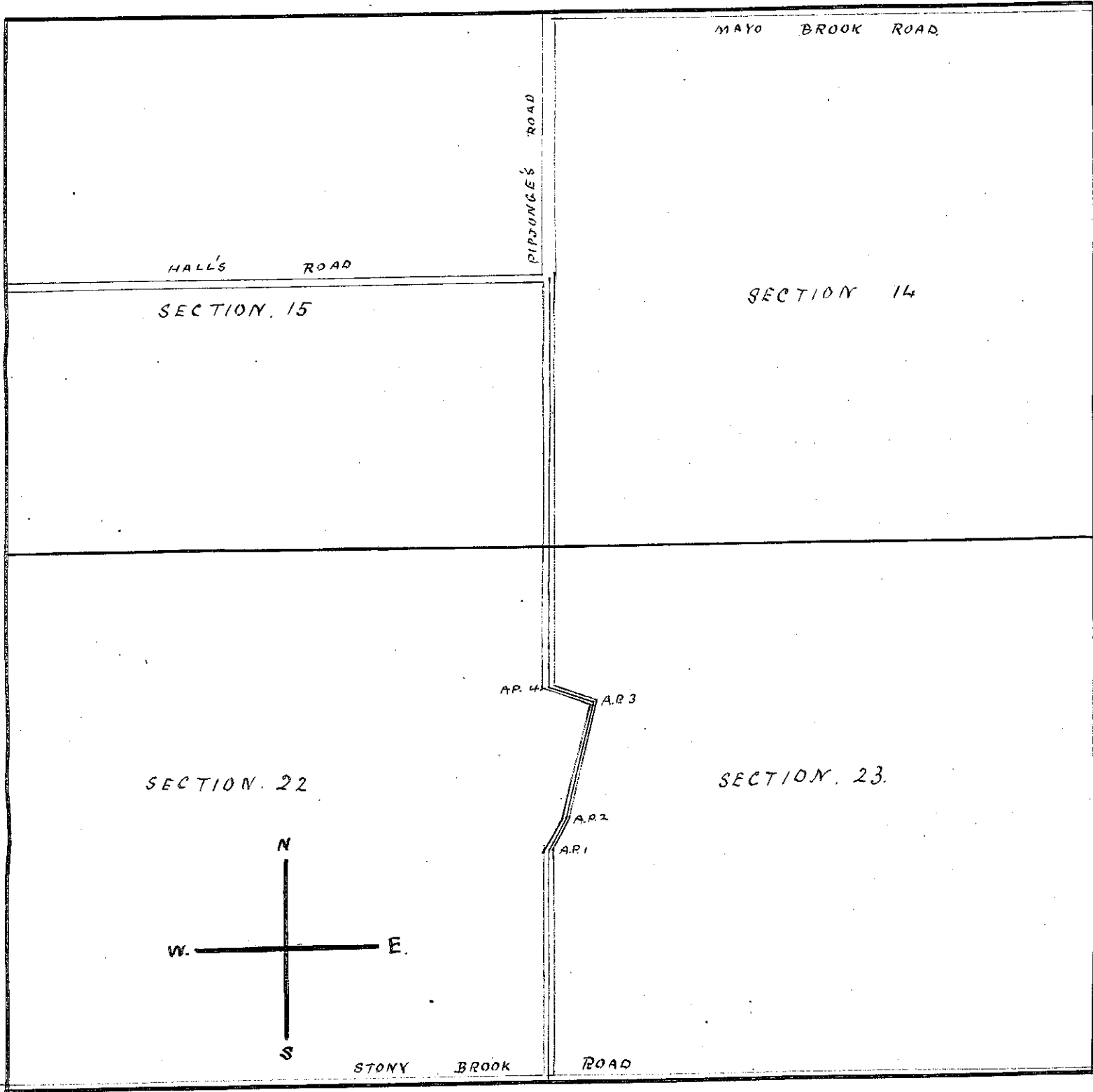

Scale 4" to 1 mile  
- 117

State of Minnesota, County of Lass Town of Maple SS.

Whereas, A road was laid out and established on the 16<sup>th</sup> day of October 1909, by us, the Supervisors <sup>and Trustees of the Board</sup> of the said Town of Maple on the petition of ten legal voters who own real estate or who occupy real estate under the homestead or pre-emption laws of the United States, or under contract from the State of Minnesota, within three (3) miles of said road, which said road

is set forth and described in the foregoing Supervisors' Order, made by us, and

Whereas, A part of the damages sustained by reason of the laying out and establishment said road has been ascertained by the agreement of the owners of the lands through which said road passes, with us, and a part of the owners of the said lands have in writing released all claims to damages; but not being able to agree with the owners of the following described lands, claiming damages by reason of said road passing through, and the owners of some of the said lands being unknown, we have assessed the damages to each of such individual claimants with whom we could not agree, and awarded damages to the owners of such lands through which such road passes as are unknown, at what we deemed just and right; taking into account and estimating the benefits the road will confer on the claimants and owners, as well as the disadvantages. We have assessed and awarded damages as follows:

(Persons lawfully occupying United States or State land, considered the owners thereof for purposes hereof.)

OWNERS OF LANDS	DESCRIPTION OF LANDS	SECTION	TOWN	RANGE	DAMAGES
<u>Mary Barber</u>	<u>E 1/2 E E 1/4 and E 1/2 S E 1/4</u>	<u>22</u>	<u>136</u>	<u>30</u>	<u>none</u>
<u>J. S. Bruikshank</u>	<u>N 1/2 S W 1/4</u>	<u>23</u>	<u>136</u>	<u>30</u>	<u>none</u>

And in case of the following lands and claimants for damages, we estimate that the advantages and benefits said road will confer on them are equal to all damages sustained by them by reason of laying out and establishing said road, to-wit:

OWNERS OF LANDS	DESCRIPTION OF LANDS	SECTION	TOWN	RANGE	DAMAGES
<u>John Pippunge</u>	<u>N 1/2 S W 1/4</u>	<u>14</u>	<u>136</u>	<u>30</u>	
<u>John Pippunge</u>	<u>E 1/2 S E 1/4</u>	<u>15</u>	<u>136</u>	<u>30</u>	
<u>O. W. Helvorson</u>	<u>N 1/2 S W 1/4</u>	<u>23</u>	<u>135</u>	<u>30</u>	