

INDEX

2 = 28-133-29 McKessing ✓
 3-5 2-137-27 Dudley ✓
 7-8 @ Sabin Shores - Harrison ✓
 9 @ Lot 1-2-3 Big Imbler ✓
 10 21-46-28 Moody ✓
 11-12, 17 Hwy Accident - Arthur ✓
 13 10-137-27 Johnson ✓
 14-18 17-137-26 Polk ✓
 19 L1 B2 Lakeview Okura ✓
 20 @ Holland to Brd - Potter ✓
 21 @ 4-45-28 Town ✓
 22-23 16-139-26 Alexson ✓
 25-29 14-134-29 Park Reg'n ✓
 30 'Y' Garrison - Bartel ✓
 31-33 13-137-29 Barbour ✓
 36-37-38 L Falls Lots MVE Co ✓
 39 H.S. Football Field ✓
 40 35-46-28 Hamilton ✓
 41-44 12-44-28 Emsen ✓
 45 19-137-28 V. Anderson ✓
 46-47 E. Nolan - Ore Stock Pile ✓

48-51 1-42-29 Lillie ✓
 52 Lots 5-6 Keddy Bz ✓
 53 10+20 - B.S. Crossby ✓
 54 Lot 21-22 B.S. Crossby ✓
 55-57 11-42-28 Trusty ✓ Keller ✓
 58 33-139-26 Angus ✓
 59-73, 79 5-133-28 Baxter School ✓
 74 - Lot 23-24 Crosby ✓ Smith ✓
 75

R

Lot 3 21-133-29

M. McKusson

$$\begin{array}{r}
 179.51 \\
 359.42 \\
 \hline
 179.91 \\
 \underline{136.5} \\
 179.91
 \end{array}$$

$$\begin{array}{r}
 197.46 \\
 98.10 \\
 \hline
 99.33
 \end{array}$$

$$\begin{array}{r}
 337.50 \\
 168.10 \\
 \hline
 169.40
 \end{array}$$

$$\begin{array}{r}
 180 \\
 61 \\
 \hline
 119
 \end{array}$$

$$\begin{array}{r}
 272.8 \\
 33 \\
 \hline
 239.8
 \end{array}$$

94.60 8° 93.5

locate pipe
set by J Howard

5 May 60 2
AS

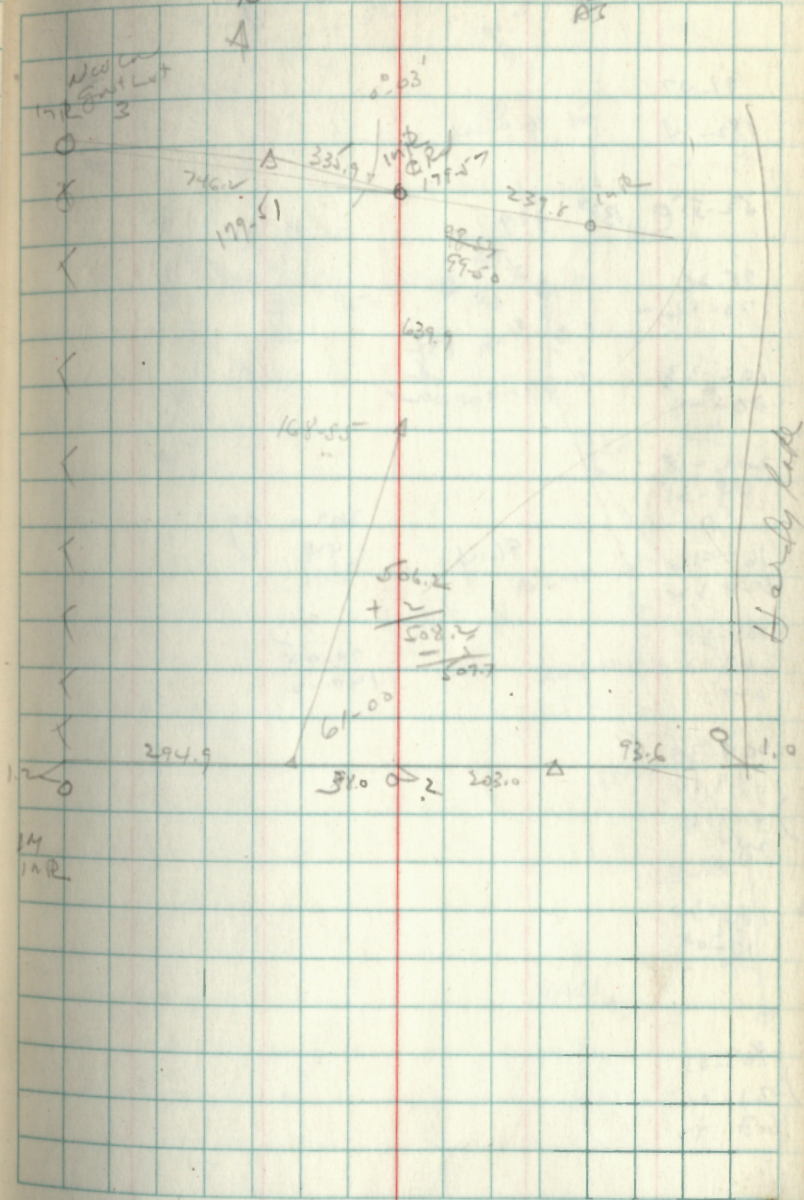

16-139-26

481.0
200.0
164.0

745.0

180.007
0-01

1836.8
1836.2

0.6

113
745
4022
273

1533.2
303.6

1836.8
- d.

1836.4

180-02 -
-03

150 @ 120
200.0
99.9
102.3

402.2

63.1
408

303.7

179-58
359 55

June 6 60 23
ds
wt

Warden

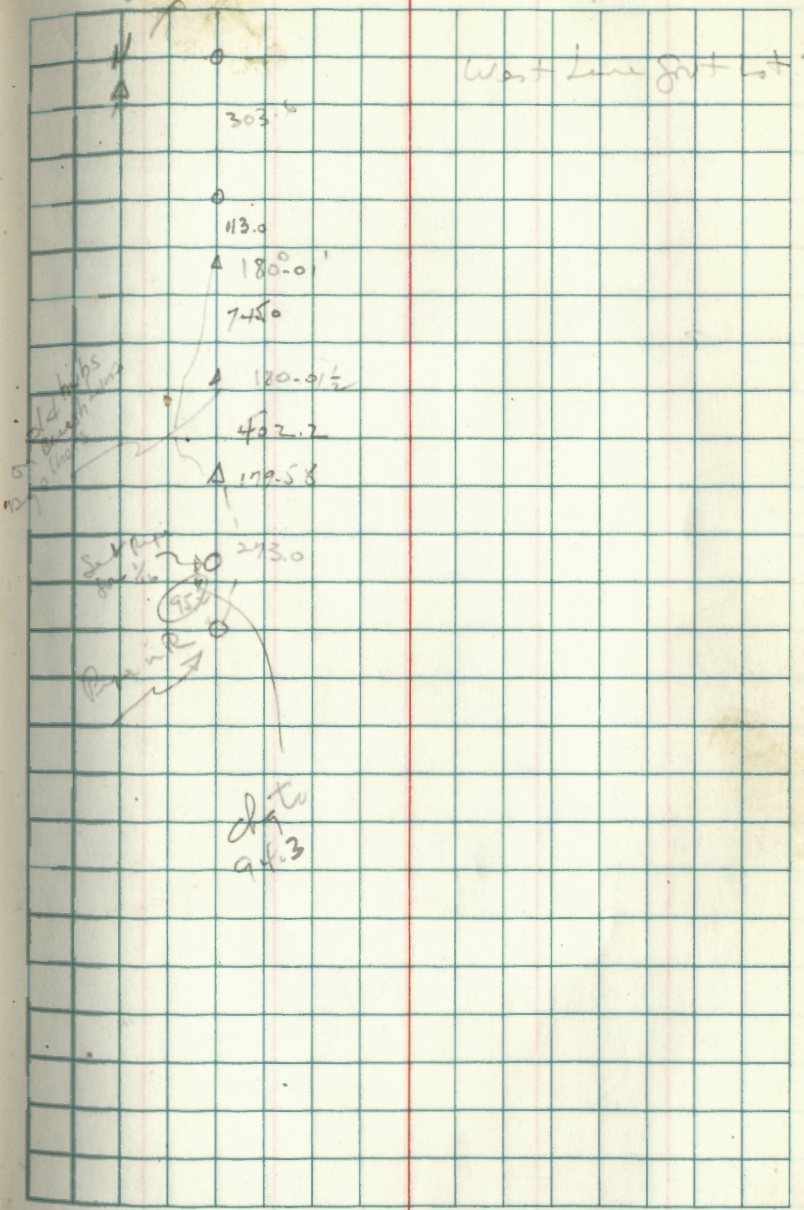

33-129-26

August 4
Austin73-05
146 10
$$\begin{array}{r} 500 @ 3^0 \quad 1997 \\ \underline{776} \\ 2773 \end{array}$$

$$\begin{array}{r} 94.00 \\ 3) 281.57 \\ \underline{93 \quad 57} \end{array}$$

$$\begin{array}{r} 94.38 \\ 189-16 \\ \underline{74 \quad 22} \end{array}$$

181.7 @ 3.0 180.6

$$\begin{array}{r} 94.00 \\ 187-59 \\ \underline{93 \quad 115} \end{array}$$

114.1

47.8 @ 11.10 46.2

84.5 @ 12 82.6

149.08
298-17
$$\begin{array}{r} 112-57 \\ \underline{225 \quad 42} \\ 112 \end{array}$$
193-35
27 10
$$\begin{array}{r} 225.42 \\ \underline{112 \quad 51} \end{array}$$
185-40
11 209 July 60
JS
PV

58

