



A000683295

OFFICE OF THE COUNTY RECORDER
 CASS COUNTY, MINNESOTA
 CERTIFIED, FILED, AND/OR
 RECORDED ON

4/12/2022 12:16:43 PM

AS DOC #: A000683295

PAGES: 2

REC FEES: 0.00

KATHRYN M. NORBY
 CASS COUNTY RECORDER

BY KF Dep TX#: 180547

Index No. P-17

CERTIFICATE OF LOCATION OF GOVERNMENT CORNER

EAST QUARTER Corner of Section 22, Township 145N, Range 27W
5th Principal Meridian, State of Minnesota, County of CASS

At the corner location shown on the sketch:

- On 1/12/2022 found a NO ORIGINAL EVIDENCE
DATE
- left monument as found, lowered monument, removed monument (explain)
- On 1/12/2022 Placed a 3/4" REBAR WELDED TO A 5.0' STEEL POST WITH CAP
DATE
STAMPED "MN DNR LS 48249". UP 1.0'. IN A SWAMP.

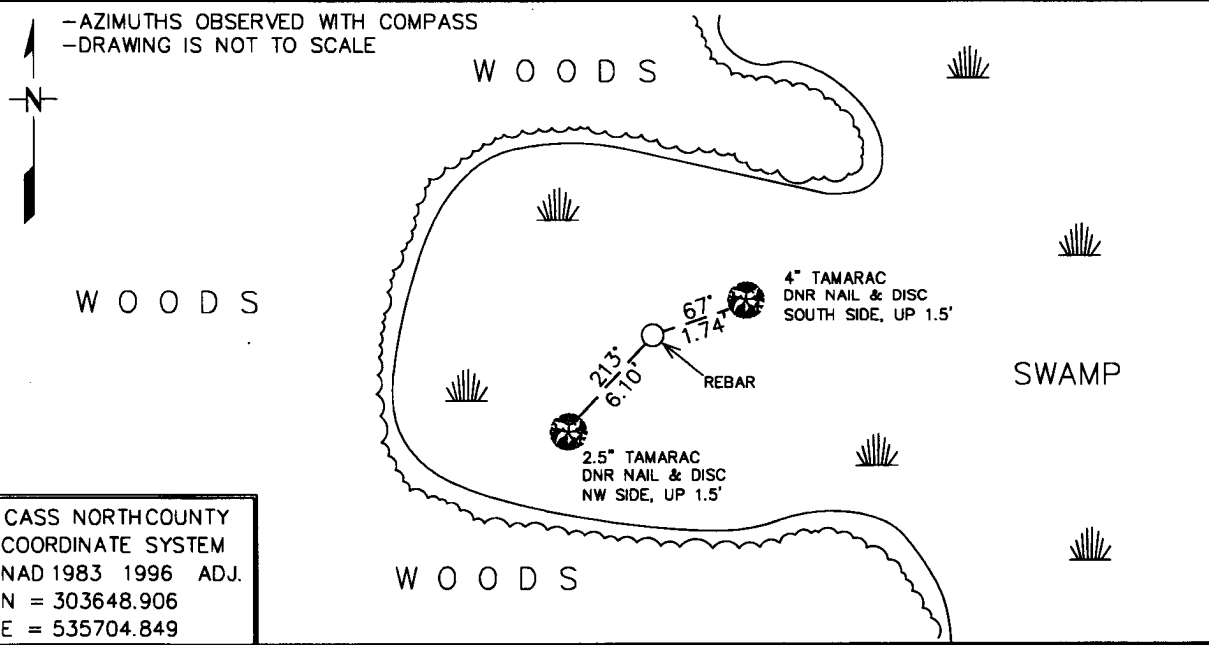

CASS NORTH COUNTY
 COORDINATE SYSTEM
 NAD 1983 1996 ADJ.
 N = 303648.906
 E = 535704.849

Statement of evidence for this corner location is on back of this page. AMD 2/2/2022
GNA00002.00.00.01

I hereby certify that this plan, specification, or report was prepared by me or under my direct supervision and that I am a duly Licensed Land Surveyor under the laws of the State of Minnesota.

SIGNATURE Daniel A. Drusch DATE 3-31-2022 License Number 48249
 DANIEL A. DRUSCH

Title: Land Surveyor Professional Engineer County Surveyor County Engineer

**East Quarter Corner Section 22, Township 145 North, Range 27 West, 5th P.M.**

The DNR Land Survey Unit contacted the following offices for survey information on this corner:

Bureau of Land Management (BLM)
MN Secretary of State
Cass County Recorder, Auditor, Surveyor, and Highway Engineer
U.S. Forest Service
Itasca County Surveyor

1873 The U.S. General Land Office (GLO) survey notes and plat, on file in the MN Secretary of State's Office, describe this corner as a post set, from which:

4" Tam, S 51° W, 55 links

2" Tam, S 60° E, 22 links

1914 USFS, M. J. Cummings, Asst. Forest Ranger, States that he set a: nue corner stake poplar and no witnesses on the edge of swamp in mixed poplar, spruce and pine.

2021 March, the DNR Land Survey Unit conducted a search for the corner but did not find any original evidence. As a result, this corner position was computed by Single Proportionate Measurement between the Northeast and Southeast corners of section 22. This computed position was found to measure:

2635.799 feet (GLO = 2640 ft) from adjoining corners.

Analysis of the available information led me to accept the computed position as the corner. Lack of government perpetuation bears out the need for the lost position.