



A000675037

OFFICE OF THE COUNTY RECORDER  
CASS COUNTY, MINNESOTA  
CERTIFIED, FILED, AND/OR  
RECORDED ON

7/28/2021 11:58:55 AM

AS DOC #: A000675037

PAGES: 2

REC FEES: 0.00

KATHRYN M. NORBY  
CASS COUNTY RECORDER

BY KF Dep TX#: 173852

Page 1 of 2  
A000675037

Twp 140 Rge 25 Index No. J.0-17.0

### CERTIFICATE OF LOCATION OF GOVERNMENT CORNER

Northeast Corner of Section 15, Township 140 N., Range 25 W., 5th P.M.  
State of Minnesota, County of Cass

At the corner location shown on the sketch:

On 3-31-2021 found No evidence of an existing corner

left monument as found  lowered monument  removed monument (explain)

On 3-31-2021 placed Aluminum rod with a 3 1/2" aluminum cap stamped with LS#21367, Up 6"

#### SKETCH OF REFERENCE TIES (NOT TO SCALE)



SE1/4--SE1/4,  
SECTION 10

SW1/4--SW1/4,  
SECTION 11

Set New Tie:  
Set spike in northerly face  
of a 10" Popple, 8" above  
ground.

Set New Tie:  
Set spike in southerly face  
of a 5" Popple, 8" above  
ground.

Set New Tie:  
Set spike in westerly face of  
a 8" Popple, 8" above  
ground.

Set New Tie:  
Set spike in easterly face of  
a 10" Popple, 8" above  
ground.

NE1/4--NE1/4,  
SECTION 15

NW1/4--NW1/4,  
SECTION 14

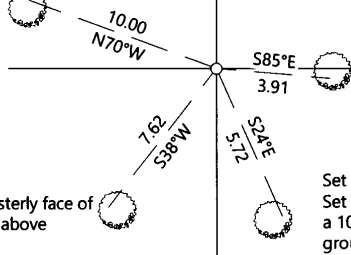

NOTE: All bearings are true.

Statement of evidence relative to this corner location is on the back of this page.

I hereby certify that this survey, plan, or report was prepared by me or under my direct supervision and that I am a duly Licensed land Surveyor under the laws of the State of Minnesota. I further certify that this United States public land survey monument record is correct and complete to the best of my knowledge and belief.

Terry L. Freeman, Land Surveyor

Date 7/26/21 MN License No. 21367

**Index No. J.0- 17.0****STATEMENT OF EVIDENCE**

**Northeast Quarter corner Section 15, Township 140 North, Range 25 West, 5<sup>th</sup> Principal Meridian.**

**Oct. 1867** O.E. Garrison, General Land Office (GLO) Deputy Surveyor in the notes of the subdivision of Township 140 North, Range 25 West, set a post for the original corner and referenced it as follows: 5° Spruce N 23 1/2° W 13 Links 5° Spruce N 63 1/2° E 6 Links 5° Spruce S 88° W 15 Links 4° Spruce S 29° E 36 Links  
Said records are on file with the Minnesota Historical Society, St. Paul, Minnesota, copies are filed with the Cass County Highway Department, Surveyor's Office (CCHD/SO).

**1915** E.B. Horst in Curo Book 68, P.2 notes indicate No BITS, found line tree to South.  
Information on file in CCHD/SO

**1937** CCC notes at Washburn Lake Forestry station in Book 2, P. 61, notes indicate at 5280 from east set approximate corner.

**2018** CCHD/SO, while surveying in area search for corner and accessories. Found nothing. Determine double proportion position from North ¼ corner section 15, North ¼ corner section 14, East ¼ corner section 10 and Northeast corner section 27.

**2021** A Northern Engineering and Consulting, Inc survey crew make final search for corner evidence and finding none, set corner at double proportion position established in 2018.

The monument set and established references for the position are shown on the face of this document.

**Analysis of the recovered record data, field evidence and survey measurements, indicates that the corner position determined by CCHD/SO and set by Northern Engineering and Consulting, Inc. in 2021 is the accepted location of this corner.**

**County Coordinates (NAD88, Cass County North, 2011 ADJ.)**

Northing 152766.560  
Easting 599794.484

