



A000651331

OFFICE OF THE COUNTY RECORDER  
CASS COUNTY, MINNESOTA  
CERTIFIED, FILED, AND/OR  
RECORDED ON

7/11/2019 10:59:03 AM

AS DOC #: A000651331

PAGES: 2

REC FEES: 0.00

KATHRYN M. NORBY  
CASS COUNTY RECORDER

BY SF \_\_\_\_\_ Dep TX#: 154805

Page 1 of 2  
A000651331

Twp 139 Rge 26 Index No. V.0-23.0

### CERTIFICATE OF LOCATION OF GOVERNMENT CORNER

North Quarter corner of Section 36, Township 139 N., Range 26 W., 5th P.M.  
State of Minnesota, County of Cass

At the corner location shown on the sketch:

On 7 May 2019 found a 1.25 inch iron pipe in concrete post, down 0.9 foot,  
2 feet± north of centerline of Trail.

left monument as found     lowered monument     removed monument (explain)

On \_\_\_\_\_ placed \_\_\_\_\_

#### SKETCH OF REFERENCE TIES NOT TO SCALE



Wooded

SECTION 25

16d duplex nail  
up 1.0 foot in E. side  
of 6 inch White Pine

16d duplex nail  
up 1.0 foot in S. side  
of 18 inch White Pine

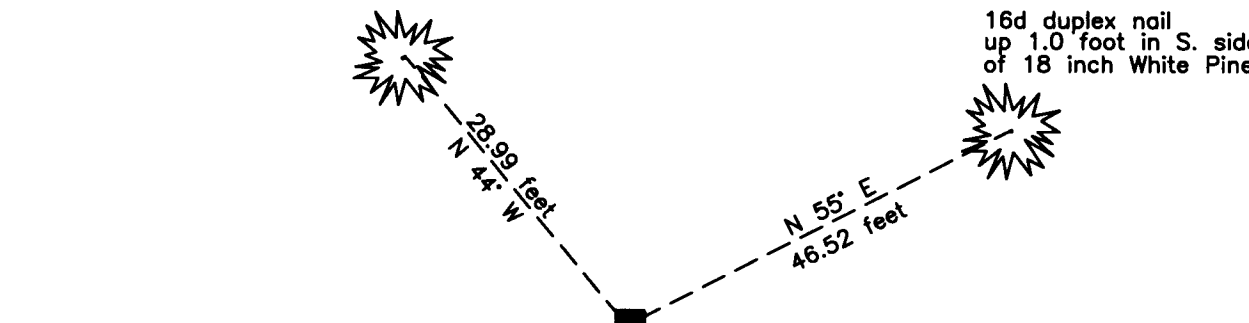

Centerline of Trail

SECTION 36

Wooded

16d duplex nail  
up 1.0 foot in E. side  
of 6 inch Red Pine

NOTE:  
All bearings are true

Statement of evidence relative to this corner location is on the back of this page.

I hereby certify that this survey, plan or report was prepared by me or under my direct supervision and that I am a duly Licensed Land Surveyor under the laws of the State of Minnesota.

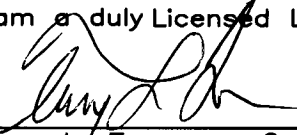
  
Terry L. Freeman, Cass County Surveyor  
Date 7/10/19 MN License No. 21367

Statement of Evidence**North Quarter corner Section 36, Township 139 North, Range 26 West, 5th Principal Meridian.**

Dec. 1863 Johnson and Thornton, General Land Office (GLO) Deputy Surveyors, notes of the subdivision of Township 139 North, Range 26 West, set a post for the original corner and referenced as follows:  
 6" N. Pine S 5° E 11 links (7.26 feet) 6" N. Pine N 25° E 15 links (9.90 feet)  
 Said records are on file at the Minnesota Historical Society, St. Paul, Minnesota, copies are filed with the Cass County Highway Department, Surveyor's Office (CCHD/SO).

April 1908 J.W. Curo, LS 1428, Cass County Surveyor, Survey Record #173, Book A, page 390 and Curo Book 95, pages 12 and 30, on file in the CCHD/SO, states "we set the live ¼ cor. from one NP, N 25° E. The other B.T. is gone tho there is a root which checks out for measurement tho it is a foot too far west."

May 1927 J.P. Larsen, LS 143, Plat of TINGDALE BROS.' ROOSEVELT TRAILS, on file in the Cass County Recorders Office(CCRO), as Document Number 87084, indicates Concrete Mon. at the subject corner.

May 2019 B. Hippen, technician, records of the CCHD/SO, found a 1.5 inch outside diameter iron pipe in concrete, down 0.9 foot, 2 feet, more or less, north of centerline of trail and the following witnesses:  
 18" White Pine N 55° E 46.52 feet 6" White Pine N 44° W 28.99 feet  
 6" Norway Pine S 7° E 57.07 feet

The recovered and established witnesses for this corner position are shown on the face of this document.

**Analysis of the recovered record data, field evidence and survey measurements, indicates that the monument recovered in 2019 by the CCHD/SO, is the correct perpetuation of this corner.**

**County Coordinates (Cass County North)**

**Northing 105291.65**

**Easting 576087.92**