



A000616729

OFFICE OF THE COUNTY RECORDER
CASS COUNTY, MINNESOTA
CERTIFIED, FILED, AND/OR
RECORDED ON

10/29/2015 10:43:04 AM

AS DOC #: A000616729

PAGES: 2

REC FEES: 0.00

KATHRYN M. NORBY
CASS COUNTY RECORDER

BY SR _____ Dep TX#: 126773

Page 1 of 2 A000616729

Twp 144 Rge 25 Index No. X.0-17.0

CERTIFICATE OF LOCATION OF GOVERNMENT CORNER

East Quarter corner of Section 34, Township 144 N., Range 25 W., 5th P.M.
State of Minnesota, County of Cass

At the corner location shown on the sketch:

On 8 July 2015 found _____ a 1 inch iron pin, down 0.3 foot, on centerline of
County Road #74.

left monument as found lowered monument removed monument (explain)

On 14 Oct 2015 placed an 1 inch by 30 inch aluminum tube with aluminum cap,
down 0.05 foot, 0.5 foot west of centerline County Road #74.

Monument

SKETCH OF REFERENCE TIES
NOT TO SCALE

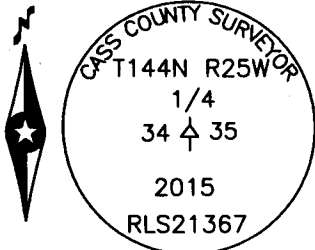

is marked

Alder Swamp

SECTION 34

County Road #74
Centerline of

Wooded

SECTION 35

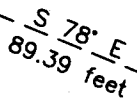
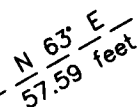
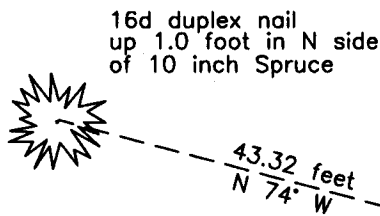

NOTE:
All bearings are true

Statement of evidence relative to this corner location is on the back of this page.

I hereby certify that this survey, plan or report was prepared by me or under my direct supervision and that I am a duly Licensed Land Surveyor under the laws of the State of Minnesota.

Terry L. Freeman, Cass County Surveyor

Date 10/28/15 MN License No. 21367



Statement of Evidence

East Quarter corner of Section 34, Township 144 North, Range 25 West, 5th Principal Meridian.

- April 1876 B.C. Baldwin, General Land Office (GLO) Deputy Surveyor, in the notes of the subdivision Township 144 North, Range 25 West, set a post for the original corner and referenced it as follows:
8" Birch N 78° E 7 links (4.62 feet) 10" Spruce N 12° W 23 links (15.18 feet)
The above record is on file with the Minnesota Historical Society in St. Paul, Minnesota, copies are filed with the Cass County Highway Department, Surveyor's Office (CCHD/SO).
- July 1908 J. Flynn, County Surveyor, road survey in Survey Record No. 416, Book C, page 183, on file in the CCHD/SO states "then S. bet. Sec's 34, 35, said Twp., at 2640.0' finding no evidence of ¼ S., continued on S. Var. 8° and at 5275.0 cor. to sec's 34-35 144-25 and 2-3 143-25."
- Feb. 1972 J.R. Worcester, CCHD, project S.A.P. 11-674-01, on file at the CCHD, indicate corner assumed at intersection of fence line and centerline of County Road. No.74 at station 133+57.3.
- Nov. 1976 R. Schneider, LS 5740, plat of DAY'S HIGH LANDING recorded as **Document Number 229024** in the office of the Cass County Recorder (CCRO). Indicates an iron bar at the subject corner.
- April 1984 United States Department of Agriculture, Forest Service (USFS) and CCHD/SO, records of the CCHD/SO, found a ¾ inch iron bar set by Schneider for plat and witnessed as follows:
14" Spruce N 37° E 169.50 feet Power Pole N 63° E 57.39 feet
10" Twin Birch S 78° E 89.45 feet
- May 1989 W.E. Curo, LS 11395, Curo file 1983 and Curo Book 322, page 1, on file in the CCHD/SO, indicates a lost position for this corner was used in subdivision in Section 34, Certificate of Survey indicates an iron pipe was set 330.84 feet north and 991.87 feet south of this corner.
- Dec. 2000 B. Hippen and C.Loe, technicians, records of the CCHD/SO, measured south and found a ¾ inch pin at the subject corner.
- July 2015 B. Hippen, technician, records of the CCHD/SO, prior to reconstruction of County Road #74 found a 1 inch pin, down 0.3 foot, in the centerline of County Road. #74. Removed pin after witnessing as follows:
12" Twin Birch S 78° E 89.39 feet(1984) 10" Spruce N 74° W 43.32 feet
Power Pole N 63° E 57.59 feet
- Oct. 2015 B. Hippen, technician, records of the CCHD/SO, after reconstruction of County Road #74, set an aluminum Cass County monument at the recovered iron pin position from the recovered witnesses, down 0.05 foot, 0.5 foot west of new centerline of County Road. #74.

The monument, recovered and established references for the position are shown on the face of this document.

Analysis of the recovered record data, field evidence and survey measurements, indicates that the monument set by the CCHD/SO in 2015 is the accepted location of this corner.

County Coordinates (Cass County North)
Northing 261053.00
Easting 599338.57