



A000608475

OFFICE OF THE COUNTY RECORDER  
CASS COUNTY, MINNESOTA  
CERTIFIED, FILED, AND/OR  
RECORDED ON

12/26/2014 9:18:22 AM

AS DOC #: A000608475

PAGES: 2

REC FEES: 0.00

KATHRYN M. NORBY  
CASS COUNTY RECORDER

BY SR Dep TX#: 120142

Page 1 of 2 A000608475

### CERTIFICATE OF LOCATION OF GOVERNMENT CORNER

I hereby certify that this survey, plan, or report was prepared by me or under my direct supervision and that I am a duly Licensed Land Surveyor under the laws of the State of Minnesota.

*Patrice A. Stottie*

Date: 12-16-14 License No: 41002

North Quarter Corner of Section 8, Township 140 N, Range 25W, 5<sup>th</sup> P.M.

On 4-16-14 found a 1 1/2" iron pipe 1' above ground, leaning SE'ly.  
Measurement taken to entry point on NW side of pipe

left monument as found,  lowered monument,  removed monument (explain)

On \_\_\_\_\_ placed a \_\_\_\_\_

### SKETCH OF REFERENCE TIES

Corner Index:

E-7

Not to Scale

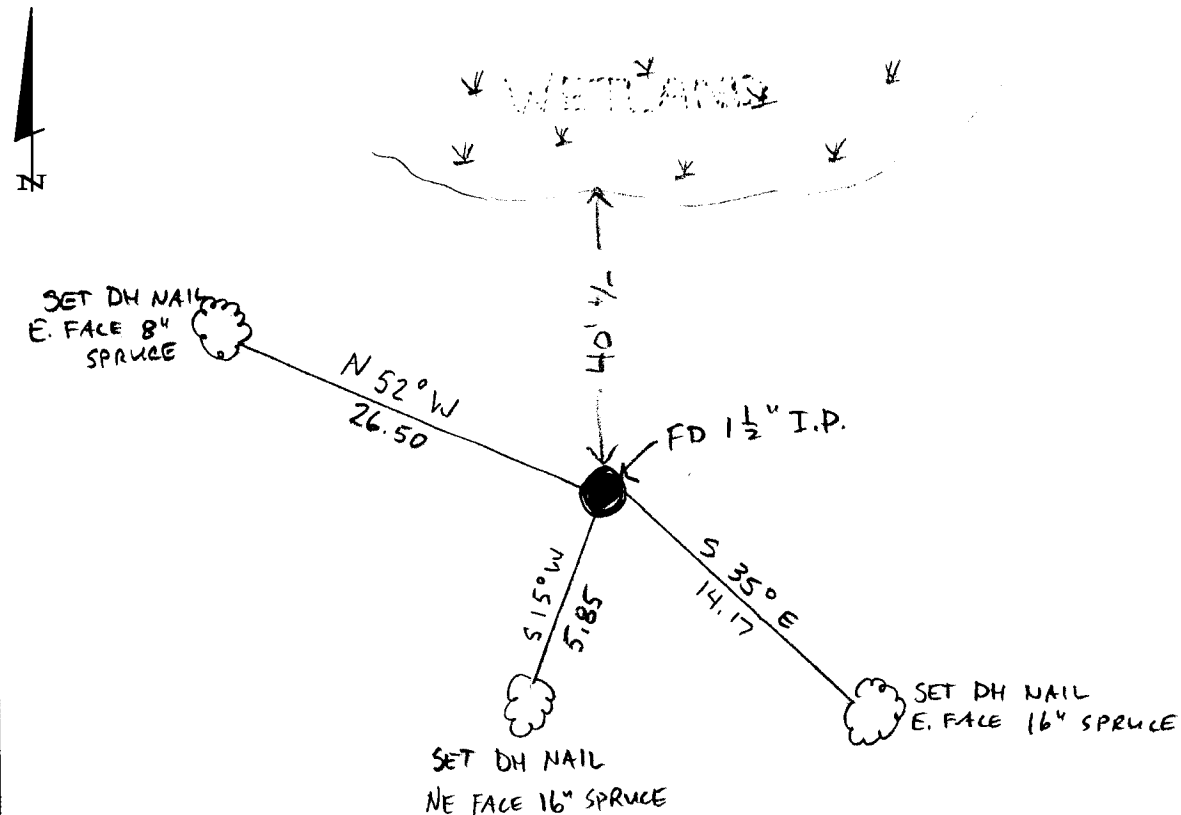

Statement of evidence for this corner position is on the back of this page



**Statement of Evidence**

**North quarter corner, Section 8, Township 140 North, Range 25 West, 5<sup>th</sup> Principal Meridian, Cass County, Minnesota**

1867 – Original U.S. Government Survey establishing this corner was performed. A wood post was set marking its location from which the following witnesses were established:

W. Birch	N 24° E	3 links
6" Bl. Oak	S 35 ½ ° W	11 links

1912 – Harry S. Todd in County Survey Record Book A, pages 552-555, found both original bearing trees and set a wood stake. Also found in Curo Book 98, p. 74.

1914 – John Curo in County Survey Record Book B, pages 320-322, and in Curo Book 98, p. 82, found Todd's stake, the two original bearing trees, and two ties set by Todd in 1912 as follow:

10" Birch	S 5° W	22.30 feet
8" Birch	N 2° W	16.10 feet

1937 – CCC- Washburn Lake field book 4, page 26 indicates an approximate corner was set at distance of 2640 feet from section corner to east.

1964 – R.F. Schneider in County Survey Record Book D, pages 436-437, found an iron pipe and established the following ties:

5" Maple	NE	31.0 feet
6" Birch	NW	12.35 feet
6" Birch	S 10° W	17.9 feet

2014 – Patrick Trottier, PLS 41002, found a 1 ½ " iron pipe. Did not find 1964 ties. Measured distance to 1/16<sup>th</sup> corner to west as shown by Schneider on said page 437 fit well within tolerance. Accepted pipe as corner and established witnesses as shown on the face of this survey.

County Coordinates (Cass County North)

Northing 157967.18

Easting 586616.60