



A000607943

OFFICE OF THE COUNTY RECORDER
CASS COUNTY, MINNESOTA
CERTIFIED, FILED, AND/OR
RECORDED ON

12/4/2014 1:17:38 PM

AS DOC #: A000607943

PAGES: 2

REC FEES: 0.00

KATHRYN M. NORBY
CASS COUNTY RECORDER

BY SR Dep

Twp 143 Rge 26 Index No. E.0-05.0

CERTIFICATE OF LOCATION OF GOVERNMENT CORNER

Northeast corner of Section 7, Township 143 N., Range 26 W., 5th P.M.
State of Minnesota, County of Cass

At the corner location shown on the sketch:

On 9 Dec 2008 found a 2 inch outside diameter iron pipe, with brass cap,
up 0.6 foot in Cedar swamp.

left monument as found lowered monument removed monument (explain)

On _____ placed _____

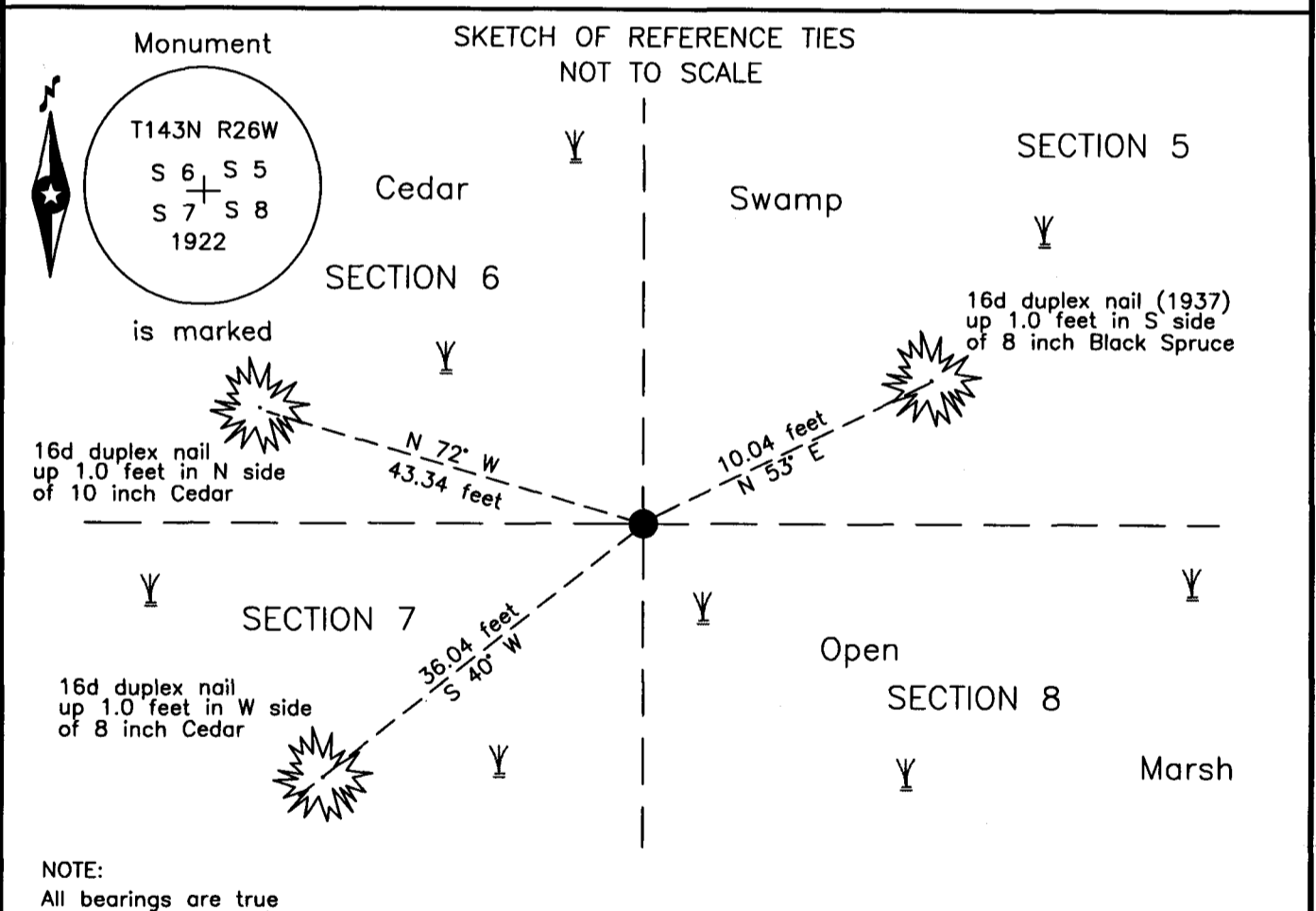

Statement of evidence relative to this corner location is on the back of this page.

I hereby certify that this survey, plan or report was prepared by me or under my direct supervision and that I am a duly Licensed Land Surveyor under the laws of the State of Minnesota.

Terry L. Freeman, Cass County Surveyor
Date 12/3/14 MN License No. 21367

Page 1 of 2
A000607943



Index No. E.0-05.0

Statement of Evidence

Northeast corner of Section 7, Township 143 North, Range 26 West, 5th Principal Meridian.

Aug. 1872 E.W. Griffin, General Land Office (GLO) Deputy Surveyor notes of the subdivision of Township 143 North, Range 26 West, set a post for the original corner and referenced it as follows:
12" Tam N 80° E 15 links (9.90 feet) 10" Tam S 38° E 25 links (16.50 feet)
8" Tam S 71° W 12 links (7.92 feet) 10" Tam N 37° W 40 links (26.40 feet)
The above record is on file with the Minnesota Historical Society in St. Paul, Minnesota, copies are filed with the Cass County Highway Department, Surveyor's Office (CCHD/SO).

Circa 1900 F.V, Abbot, Major, United States Army, Corps of Engineers (COE), Lake Pokegama Reservoir Map 143-26, on file with the United States Department of Agriculture, Forest Service (USFS) offices in Cass Lake, MN, by symbol indicates this to be a known corner. Notes on film of Book A1-230, page 57, state "Corner secs 5-6-7-8, Township 143 Range 26 Found all four Trees, all standing but the one to the South East."

Aug. 1922 G.R. Veal, U. S. Cadastral Engineer, GLO, Reestablishment of a Portion of Township 143 North, Range 26 West, on file with the Minnesota Historical Society, St. Paul, Minnesota, copies are filed with the CCHD/SO, states "Set an iron post, 3 ft. long, 2 ins. diam., 27 ins. in the ground, for cor. of secs. 5, 6, 7 and 8, with brass cap" and lists the original witnesses as follows:

14" Tam stp.	N 75°30' E	16 links (10.56 feet)	12" Tam stp.	S 39° E	27 links (17.82 feet)
12" Tam stp.	S 81°15' W	18 links (11.88 feet)	12" Tam stp.	N 30°30' W	42 links (27.72 feet)

He lists the following new witnesses:

5" Tamarack	N 54°30' E	15 links (9.90 feet)	10" Tamarack	S 63° E	73 links (48.18 feet)
8" Tamarack.	S 48° W	53 links (34.98 feet)	6" Tamarack	N 47° W	101 links (66.66 feet)

1960 USFS, Field Book #2, page 13, on file in the offices in Cass Lake, MN, notes only indicates the GLO witnesses.

Dec. 2008 B. Hippen, technician, records of the CCHD/SO, found the 1922 GLO 2 inch outside diameter iron pipe with brass cap, leaning west. Stood it up vertically over base, now is up 0.6 foot in cedar swamp. The monument was witnessed it as follows:
8" Blk Spruce N 53° E 10.05 feet(1922) 10" Cedar N 72° W 43.34 feet
8" Cedar S 40° W 36.04 feet

The recovered and established references for the position are shown on the face of this document.

Analysis of the recovered record data, field evidence and survey measurements, indicates that the monument recovered by the CCHD/SO in 2008 is the correct perpetuation for this corner.

County Coordinates (Cass County North)
Northing 254442.00
Easting 551430.95