

CERTIFICATE OF LOCATION OF GOVERNMENT CORNER

North Quarter Corner of Section 14
Township 145 N, Range 30 W, 5th P.M.
STATE OF MINNESOTA, COUNTY OF CASS



A000601386

OFFICE OF THE COUNTY RECORDER
CASS COUNTY, MINNESOTA
CERTIFIED, FILED, AND/OR
RECORDED ON

4/3/2014 11:29:57 AM

AS DOC #: A000601386

PAGES: 2

REC FEES: 0.00

KATHRYN M. NORBY
CASS COUNTY RECORDER

BY SR Dep

On 04/20/2010, found a(n): 1" Iron Pipe With 2" Brass Cap
Stamped 1933, 0.8' Above Ground

- left monument as found
- lowered monument
- removed monument (explain)
- raised monument

On _____, set a(n): _____

See "Statement of Evidence" for further details (on back)

(reserved for recording data)

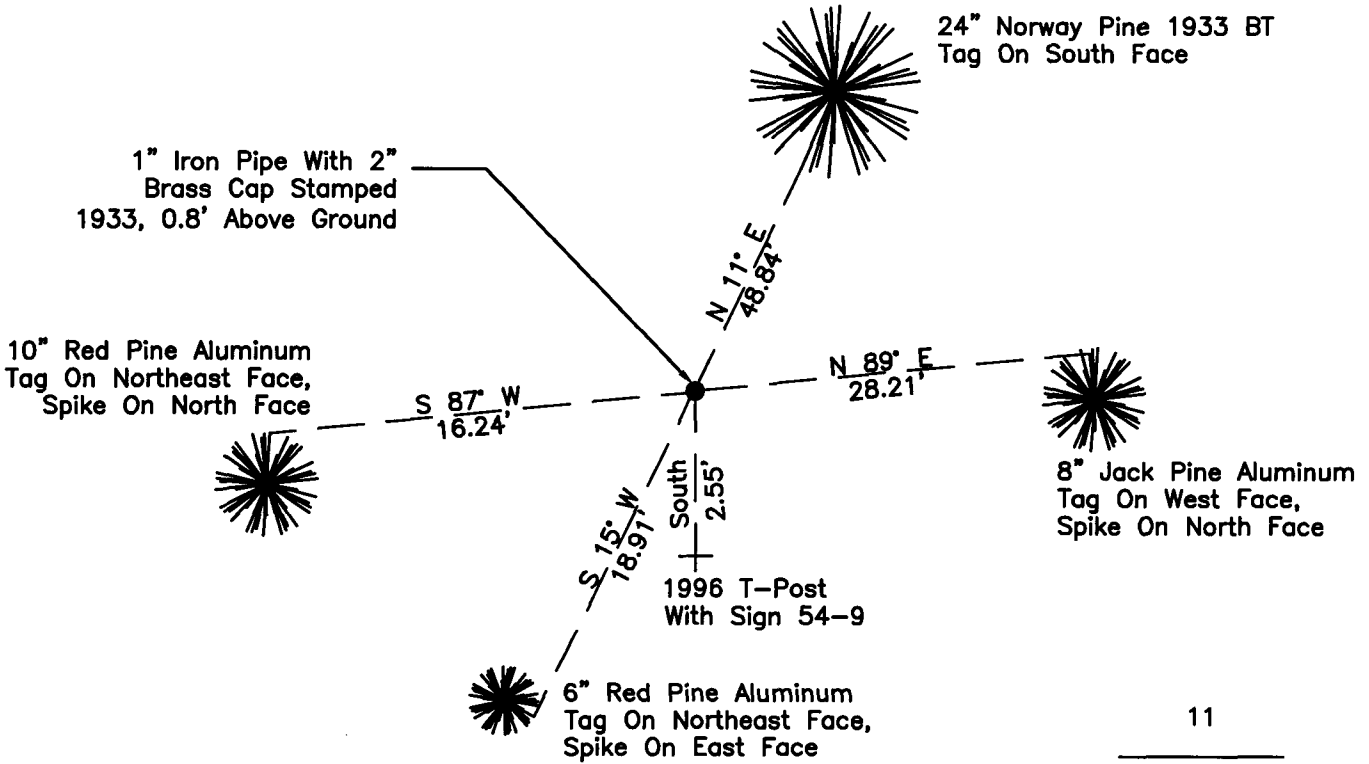

11

14

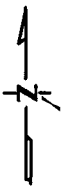

"SKETCH OF REFERENCE TIES" (not to scale - bearings are magnetic)

Ties are measured to center of monument unless otherwise noted.

UNITS = Metric English

UTM COORDINATES, ZONE 15

Northing: 17220000.870

Easting: 1281868.042

NAD 83/1996 Adjustment.

Obtained by RTK GPS observations.

I hereby certify that this survey, plan, or report was prepared by me or under my direct supervision, and that I am a duly Licensed Land Surveyor under the laws of the State of Minnesota.

Ross Wamre
signature

8/7/13
date

Ross Wamre, Minnesota License No. 45334





STATEMENT OF EVIDENCE: Quarter Corner common to Sections 11 and 14 of Township 145 North,
Range 30 West of the 5th Principal Meridian

1874; This corner was originally established by P.H. Conger for the Government Land Office. His field notes indicate a wood post set at this corner position, witnessed by:

Blk. Pine 6" North 32° East, 41 links
Blk. Pine 6" South 84° West, 20 links

1933; Resurvey by GLO, Willis W. Bandy, found no evidence of the original post or bearing trees. Set by lost proportionate methods, an iron post, 3' long, 1" diameter 27" in the ground with a stamped brass cap witnessed by:

Norway Pine 14" North 11° East, 74 links, mkd ¼ S11 BT
Norway Pine 20" South 79° East, 93 links, mkd ¼ S14 BT

1962; Peter J. Meyer, RLS #3628 and R.H. McDonald, USFS Book 1 of Township 145 North, Range 30 West, page 77, found the iron post with brass cap and the 1933 BT's. An Affidavit as to Location of Government Corner is on file at the Cass County Office of Register of Deeds. Corner is witnessed by:

Norway Pine 19" North 11° East, 48.84', with scribe (1933 tie)
Norway Pine 23" South 79° East, 61.38', (1933 tie) re-scribed
J. Pine 9" South 80° East, 9.65', mkd ¼ S14 BT

1996; Curtis Krause, USFS Book 1 of Township 145 North, Range 30 West, page 77, found GLO iron and cap in-place, cap 7" above ground in very thick brush.

J. Pine (dead snag) South 80° East, 9.65', (1962 tie)
Norway Pine 19" North 11° East, 48.84', with scribe (1933 tie)
Norway Pine 23" South 79° East, 61.38', with scribe (1933 tie)

New BT:

8' Steel Sign Post, South 2.55'

2010; A Kadrmas, Lee & Jackson survey crew found 1" iron pipe with a 2" Brass cap standard GLO monument, 0.8' above ground in good condition. Witnesses found and established as shown on the face of this certificate.

2012; Ross Wamre, RLS #45334, after analysis of record and survey information accepts this monument as the correct perpetuation of the corner.

Contacts pertaining to this corner are as follows:

Cass County Recorder's Office

Cass County Surveyors Office

United States Forest Service

Bureau of Indians Affairs – Bemidji

Bureau of Land Management's (BLM) Northeastern States Field Office

Cass County Engineers Office

Northern Engineering and Consulting Inc.

MnDOT – District Office 2