



A000584040

**OFFICE OF THE COUNTY RECORDER
CASS COUNTY, MINNESOTA
CERTIFIED, FILED, AND/OR
RECORDED ON**

9/11/2012 7:23:37 AM

AS DOC #: A000584040

PAGES: 3

REC FEES: 0.00

**KATHRYN M. NORBY
CASS COUNTY RECORDER**

BY KF Dep

AFFIDAVIT BY THE CASS COUNTY SURVEYOR IN REGARD TO A CERTIFICATE OF LOCATION OF GOVERNMENT CORNER

STATE OF MINNESOTA }
 }ss
COUNTY OF CASS }

Robert Kovanen, being first duly sworn, deposes and states as follows:

That Affiant is the County Surveyor in and for the County of Cass, in the State of Minnesota;

That in such capacity Affiant has knowledge of the books and records kept in the Office of the County Surveyor in and for the County of Cass, State of Minnesota;

That the attached CERTIFICATE OF LOCATION OF GOVERNMENT CORNER has been found in the Surveyor's records and after checking with the Cass County Recorder, it was determined that the document was never assigned a document number and was never officially recorded in the real estate records or tracted in the tract indexes within said Cass County Recorder's Office;

Page 1 of 3

A000584040



-2-

That in order to make the attached CERTIFICATE OF LOCATION OF GOVERNMENT CORNER a matter of public record and locatable by legal description, Affiant does herewith attach said document to this affidavit and requests the Cass County Recorder to record same at her earliest opportunity.

FURTHER, Affiant sayeth not.



Robert Kovanen, Cass County Surveyor

Subscribed and sworn to before me
this 30 day of August, 2012.



Notary Public

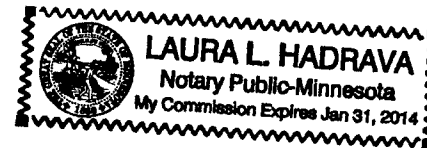

This instrument was drafted by:

Robert Kovanen
Cass County Surveyor
P.O. Box 579
Walker, MN 56484

CERTIFICATE OF LOCATION OF GOVERNMENT CORNER

QUARTER CORNER OF SECTION 6, TOWNSHIP 134 NORTH, RANGE 29 WEST,
AND OF SECTION 1, TOWNSHIP 134 NORTH, RANGE 30 WEST.

No. 2

STATE OF MINNESOTA)
COUNTY OF CROW WING) SS

I HEREBY CERTIFY THAT ON THE 28TH DAY OF NOVEMBER, 1966, THAT I, DEAN M. ANDERSON, A REGISTERED LAND SURVEYOR, ESTABLISHED THE QUARTER CORNER BETWEEN SECTION 6, TOWNSHIP 134 NORTH, RANGE 29 WEST AND SECTION 1, TOWNSHIP 134 NORTH, RANGE 30 WEST, BY SINGLE PROPORTION BETWEEN THE SOUTHWEST CORNER AND THE WITNESS CORNER FOR THE NORTHWEST CORNER OF SAID SECTION 6 AND I FURTHER CERTIFY THAT ON THE 4TH DAY OF APRIL, 1967, IN ORDER TO PERPETUATE THE LOCATION OF SUCH CORNER, I DID, AT THE EXACT LOCATION THEREOF, PLACE A PERMANENT MARKER CONSISTING OF A CASS COUNTY IRON MONUMENT, 3 INCHES BELOW THE SURFACE. I FURTHER CERTIFY THAT I ESTABLISHED 3 REFERENCE OR WITNESS MONUMENTS CONSISTING OF 3 TREES WHICH REFERENCE OR WITNESS MONUMENTS ARE LOCATED IN THE MANNER FOLLOWING:

3" WHITE PINE W.N.W. 41.30'
6" WHITE PINE E.N.E. 37.85'
4" WHITE PINE S.E. 51.30'

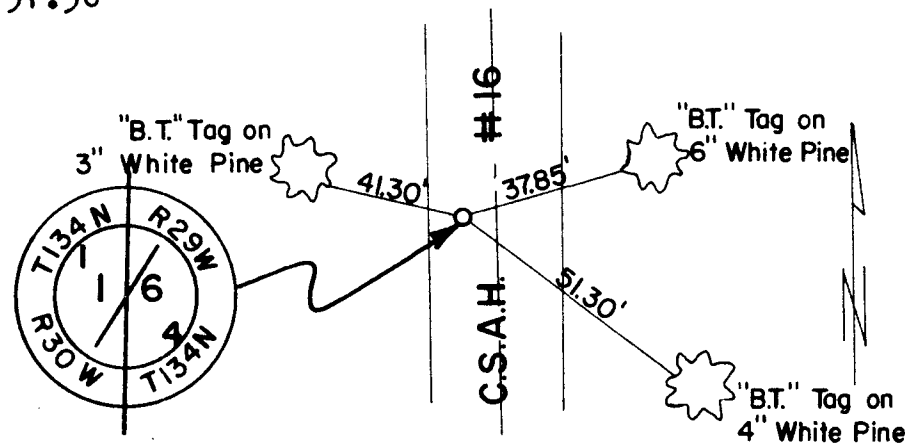

DATED AT BRAINERD, MINNESOTA 11th DAY OF MAY, 1967

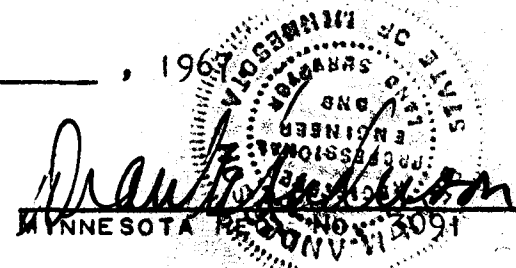

OFFICE OF THE REGISTER OF DEEDS)
COUNTY OF CASS) SS

I HEREBY CERTIFY THAT THE WITHIN INSTRUMENT WAS FILED IN THIS OFFICE FOR RECORD ON THE 18 DAY OF May, 1967.

Beulah Hendricks
REGISTER OF DEEDS