



A000583926

OFFICE OF THE COUNTY RECORDER  
CASS COUNTY, MINNESOTA  
CERTIFIED, FILED, AND/OR  
RECORDED ON

9/7/2012 3:03:09 PM

AS DOC #: A000583926

PAGES: 2

REC FEES: 0.00

KATHRYN M. NORBY  
CASS COUNTY RECORDER

BY SR \_\_\_\_\_ Dep

Index Number A-25

# CERTIFICATE OF LOCATION OF GOVERNMENT CORNER

NORTH EAST Corner of Section 1, Township 133, Range 31  
5TH Principal Meridian, State of Minnesota, County of Cass

At the corner location shown on the sketch:

On 2-17-11 found a 2" x 72" GALV. PIPE

left monument as found       lowered monument       removed monument (explain)

On 2-17-11 placed on 3.5" Brass Cap Stamped CASS CTY 43932  
Pounded original MON down and set New Mon inside.

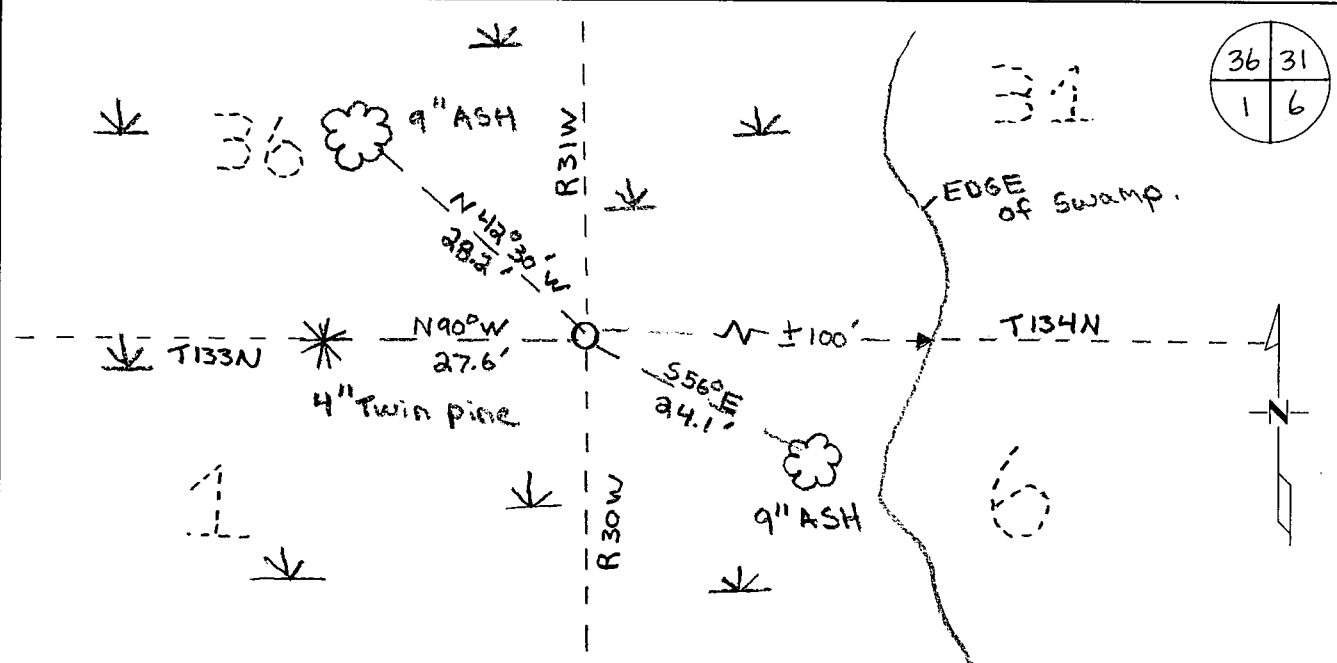

Statement of evidence for this corner location is on back of this page.

I hereby certify that this document was researched and prepared by me or under my direct supervision and that I am a licensed Land Surveyor under the laws of the State of Minnesota.

Signature Chris Hoglund  
Chris Hoglund, PS  
License No. 43932

Date: 6/13/12





**Statement of Evidence:**

Northeast Corner of Section 1, Township 133 North, Range 31 West, May Township, 5<sup>th</sup> Principal Meridian, Cass County, Minnesota.

1858 Original US General Land Office survey by E.N. Darling, set a wood post and bearing trees noted as:

10" Fir	N 80° W	6 links
6" Fir	S 35° W	7 links
10" Fir	S 50° E	10 links
8" Fir	N 55° E	16 links

2002 Bruce Grivna, LS 17253, (Westwood Professional Services, Inc.) did extensive survey work in Sections 5, 6 and 7, T133N, R30W, Sections 1, 2 and 3, T133N, R31W, Sections 30 and 31, T134N, R30W and Sections 34, 35 and 36, T134N, R31W. As part of this survey work, section corner monuments, roads and other lines of occupation were located in these sections. The northeast corner of Section 1 was computed on line and at a split distance from the ½" iron pipe LS 11865 at the southeast corner of Section 1 and the stone monument found at the northeast corner of Section 36. Total measurement between these corners was 10,598.65 feet (5299.33 per mile). Using this position the distance to an established fence intersection at the north quarter corner of Section 2, Township 133N, R31W fit GLO distance within 17 feet. Distance to the nearest found government corner east (meander corner number 16, Township 133, Range 30) measured 12,063.48 feet compared to a GLO distance of 11824.16 feet, a difference of 239 feet. From an establish north-south fence at the northeast corner of Section 6, Township 133, Range 30 to Meander Corner Number 16, the measured distance fit GLO distance within 15.9 feet (short). After careful analysis it was determined that the on line split distance fit more consistently with GLO measurements in the area, and that the double proportioned method was not a viable method for perpetuation of this corner. (Westwood Job #20027529)

9" Ash	N 42°30' W	28.2 feet
4" Twin Pine	West	27.6 feet
9" Ash	S 56° E	24.1 feet

Cass County Coordinates South Zone obtained by GPS (NAD 83, 1996 Adj)  
 N: 177603.78  
 E: 487065.98

2011 Westwood Professional Services, Inc. found the 2"x72" galvanized pipe set by Grivna in 2002 with ties still intact. Accepted Grivna monument based on extensive research and field work done by Westwood Professional Services in 2002. Pounded monument flush and set a 5/8"x24" rebar with 3.5" brass cap inside galvanized pipe. Located set monument with 20 minute static GPS shot and verified coordinates with VRS GPS observation. Analysis of the recovered data, field evidence and survey measurements, indicates that the monument found by Westwood Professional Services, Inc is the accepted position for this corner.

Cass County Coordinates South Zone obtained by static GPS (NAD 83, 1996 Adj)  
 N: 177603.72  
 E: 487066.10

Central State Plane Coordinate  
 N: 827464.72  
 E: 2557041.69