

CERTIFICATE OF LOCATION OF GOVERNMENT CORNER

to 34/35 140N
 Section 34/35 Corner ~~34~~ Section 3/2, Township 139N, Range 26W, 5th P.M.

STATE OF MINNESOTA, County of Cass

At the corner location shown on the sketch:

- On 7/19/02 found a 2" iron pipe with steel cap on 1/2" x 1/2" steel
DATE
rod with fence post along side.
 left monument as found, lowered monument, removed monument (explain)
- On _____ placed a _____
DATE

SKETCH OF REFERENCE TIES

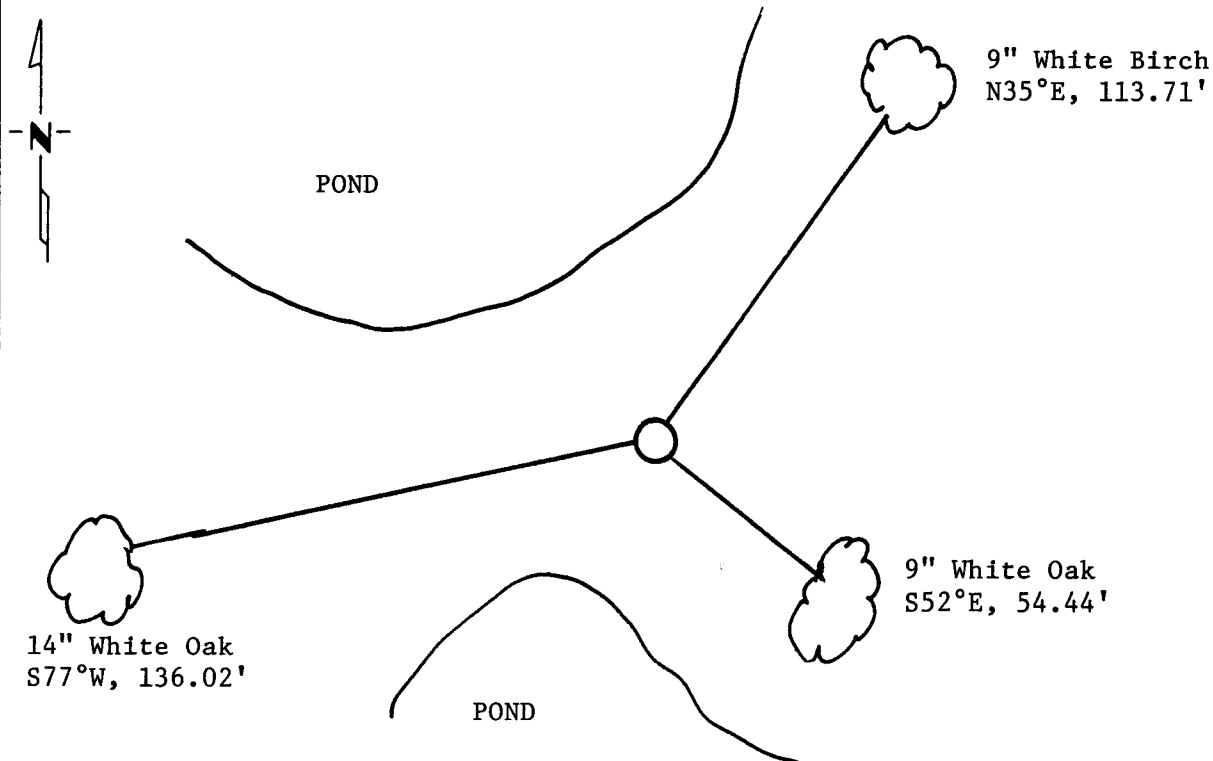

Statement of evidence relative to this corner location is on back of page.



I hereby certify that this document and the data contained herein was prepared by me or under my direct supervision.

Milo E. Stefan 2/12/05
SIGNATURE DATE

Registration No. 12261

Land Surveyor

County Surveyor

OFFICE OF THE COUNTY RECORDER

County of _____

I hereby certify that this document was filed in the Co. Recorders office at _____ .M. on the _____ day of _____ A.D., 19 _____

County Recorder _____

By _____, Deputy

DOCUMENT NO. _____

Statement of Evidence:

ORIGINAL SURVEY

1863 - This corner was established by the U.S. General Land Office surveyors at 80.00 chains, whereby a wood post was set with 4 bearing trees:

- 10" White Pine, N82°E, 15 Links
- 9" Scrub Pine, S33°E, 15 Links
- 15" White Pine, S80°W, 94 Links
- 15" White Pine, N75°W, 73 Links

SUBSEQUENT SURVEYS

1937 - CCC crew from Washburn Lake found capped 2 1/2" iron pipe - Book 1, page 52

1938 - Book 20, page 40 - called iron pipe 100' West of State Highway #6

?Date- George A. Ralph, survey of State Highway #6, made note of corner, book 8, page 90 - 91.

1998 - Landecker found corner, set steel fence post along side of iron pipe and made 3 new bearing trees:

- 9" White Birch, N35°E, 115.71 feet
- 9" White Oak, S52°E, 54.44 feet
- 14" White Oak, S77°W, 136.02 feet

I accept this iron pipe as the perpetuated position of the Section Corner.

Milo E Stefan



A000496580

OFFICE OF COUNTY RECORDER
CASS COUNTY MINNESOTA

CERTIFIED, FILED, AND/OR
RECORDED ON
03/29/2005 01:28:39PM

AS DOC #: A000496580
PAGES: 2
REC FEES: \$0.00

KATHRYN M. NORBY
COUNTY RECORDER

BY *Kathryn M. Norby*
DEPUTY