

CERTIFICATE OF LOCATION OF GOVERNMENT CORNER

I hereby certify that this survey, plan, or report was prepared by me or under my direct supervision and that I am a duly Licensed Land Surveyor under the laws of the State of Minnesota.

Patrick A. Trotter

PATRICK A. TROTTER

Date: 4-08-04 License No: 44002
41002

OFFICE OF THE COUNTY RECORDER
County of CASS

I hereby certify that this document was filed in the Office of the County Recorder at _____ o'clock _____ M. on the _____ day of _____, 20____ A.D.

County Recorder _____

By: _____, Deputy
DOCUMENT NO.

EAST QUARTER Corner of Section 30, Township 134, Range 30, 5th P.M.

On _____ found a _____

left monument as found, lowered monument, removed monument (explain)

On 02/10/03 placed a 1/2" IRON PIPE WITH PLASTIC CAP STAMPED RLS #17008

decl:

SKETCH OF REFERENCE TIES

CORNER INDEX T-5

Not to Scale



NORTHWEST CORNER
ALUMINUM CAPPED
3/4" REBAR STAMPED
DNR SURVEY MARKER
DOC #375017

18" OAK
DOUBLE BLAZED
WITH NAIL AT FACE

SECTION 30

SECTION 29

10" OAK
DOUBLE BLAZED
WITH NAIL AT FACE

8" OAK
DOUBLE BLAZED
WITH NAIL AT FACE

N 44° W
8.28

S 70° E
18.69

S 24° W
36.53

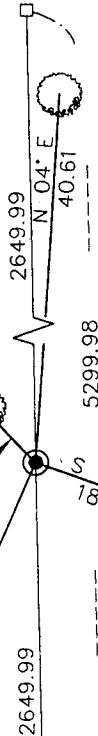

LEGEND

- DENOTES DECIDUOUS TREE
- DENOTES 1/2 INCH IRON PIPE CAPPED 17008
- DENOTES FOUND 3/4 INCH REBAR

12" OAK
DOUBLE BLAZED
WITH NAIL AT FACE

SOUTHWEST CORNER
POSITION BY KEVIN J. METZ
SEE CASS COUNTY SURVEYORS RECORDS
1/2" IRON PIPE CAPPED 17008

Statement of evidence for this corner position is on the back of this page

East Quarter Corner, Section 30, Township 134 North, Range 30 West, Cass County, Mn.

1868 N. Butler, U.S. Deputy Surveyor sets a wooden post for this corner during the original survey of the interior subdivision of Township 134 North, Range 30 West and witnesses it with the following bearing trees:

13" Black Pine	North 08° West	6 Links
18" Norway Pine	North 25° East	41 Links

2003 Patrick Trottier, Land Surveyor, License # 41002, employed by Landecker and Associates Inc. of Pequot Lakes, Minnesota, searches diligently for physical and related paper evidence of said post and finds none.

An expansion of his search to adjacent Government Corners reveals the Northwest Corner of said Section 29 is marked with an aluminum capped 3/4" re-bar stamped "DNR SURVEY MARKER" and after further research finds a recorded CERTIFICATE OF LOCATION OF GOVERNMENT CORNER" Document # 375017.

No physical evidence of the Southwest Corner of said Section 29 was found, however, a search of the Cass County Surveyors records reveals in 2002 Kevin J. Metz, Land Surveyor, License # 40343 establishes the position for this corner and files the following statement:

"After extensive field search for evidence of this corner, and after finding none, other than a few strands of old barbed wire fence, this corner position was established by double proportion using the Northeast Corner of Section 30-134-30, the Northwest Corner of Section 31-134-30, the Southwest Corner of Section 32-134-30, and the Northeast Corner of Section 32-134-30. This was done in agreement with David Landecker, of Landecker and Associates, and Bob Kovanen, Cass County Surveyor. This position lies Easterly of a Tamarack swamp, which is in agreement with the original Government running notes, and nearly on-line, North-South, with the found strands of barbed wire fence, which agrees with 1921 notes from John Greene, Land Surveyor, Walker, Mn."

Mr. Trottier sets a 1/2" plastic capped iron pipe # 17008 at this location from which:

10" Jack Pine	North 17° West	21.46 feet
10" Popple	South 34° West	80.71 feet
6" Jack Pine	South 32° East	35.81 feet
5" Jack Pine	North 62° East	48.94 feet

Mr. Trottier in consultation with David Landecker, Land Surveyor, license # 17008, and in accordance with the rules of Restoration of Lost Corners, establishes and sets a 1/2" plastic capped iron pipe # 17008 for West Quarter Corner of said Section 29 midway and on line between the two above referenced Government Corners, from which:

10" Oak	North 44° West	8.28 feet
12" Oak	South 24° West	36.53 feet
8" Oak	South 70° East	18.69 feet
18" Oak	North 04° East	40.61 feet

A000483080

OFFICE OF COUNTY RECORDER
CASS COUNTY MINNESOTA

CERTIFIED, FILED, AND/OR
RECORDED ON
05/04/2004 12:52:02PM

AS DOC #: A000483080
PAGES: 3
REC FEES: \$0.00

KATHRYN M. NORBY
COUNTY RECORDER

BY Kathryn M. Norby DEPUTY