

CERTIFICATE OF LOCATION OF GOVERNMENT CORNER

NORTH QUARTER Corner of Section 21, Township 135 N, Range 31 W, 5TH P.M.

STATE OF MINNESOTA, County of CASS

At the corner location shown on the sketch:

On _____ found a _____
DATE

left monument as found, lowered monument, removed monument (explain)

On 6-10-98 Placed a DSM UP 0.2', 2.5' W AND 0.5' S OF WOOD
DATE CORNER FENCE POST, FENCES N-S-E-W

SKETCH OF REFERENCE TIES

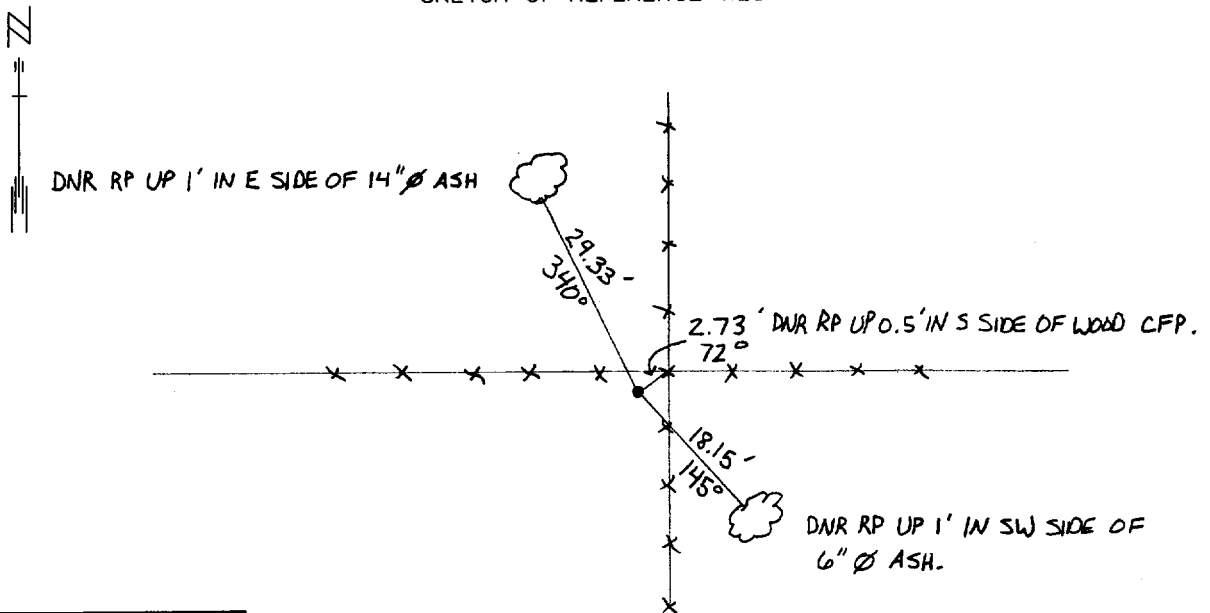

NAD83 CASS CO.
COORDINATES

N 225,425.52
E 468,221.49

Abstract Document
#441843

AZIMUTHS OBSERVED WITH COMPASS

Statement of evidence relative to this corner location is on back of page.

DATE
FILE WMA01198

I hereby certify that this document and the data contained herein was prepared by me or under my direct supervision.

John D. Waller 5/3/01
SIGNATURE DATE

License Number 16098

Land Surveyor, Professional Engineer
 County Surveyor, County Engineer

OFFICE OF THE COUNTY RECORDER
County of Cass

I hereby certify that this document was filed in the Co. recorders office at 2:26 P.M. on the 16th day of Oct. A.D., 2001

County Recorder Kathryn M. Nalley
By John F. Maedle, Deputy

DOCUMENT NO. 441843

North Quarter Corner Section 21, Township 135 North, Range 31 West

The Department of Natural Resources, Bureau of Engineering contacted the following offices for information regarding this corner:

MN Secretary of State
Cass County Surveyor
Widseth, Smith and Nolting of Brainerd
Landecker and Associates of Pequot Lakes
Landecker and Associates of Walker
Central Minnesota Surveying

1870 The US General Land Office field notes, on file in the Secretary of State's Office, show this corner to be marked with a post and the following bearing trees were marked:

Bur Oak 8" S 25 ½° E 81 links
Elm 12" N 55° W 84 links

1920 Lincoln Mackey surveyed the Rainbow Trail through this township. He set a 2" x 48" iron monument at a split between the section corners. The distance to each of the corners was 2664.5'.

1998 The DNR survey crew searched for the corner at the intersection of fences north, south, east and west. Nothing was found and a 3/4" x 24" iron rod with a MNDNR SURVEY MARKER cap was set at the lost position between section corners, 2662.43' from each of the section corners. The monument fell 0.5' south and 2.5' west of the corner fence post.

For more information on our survey in this area please contact MN DNR, Bureau of Engineering, Survey Section, 1601 Minnesota Drive, Brainerd, MN 56425