

**CERTIFICATE OF LOCATION OF GOVERNMENT CORNER**

Witness Corner to Meander Corner #43, common to Section 5, Township 142 North, Range 27 West and Section 32, Township 143 North, Range 27 West, of the Fifth Principal Meridian, Cass County, Minnesota, on the east shore of Boy River.

June, 1999; Northern Lights Surveying and Mapping, Inc., set an aluminum capped aluminum rod as the witness corner to the E. bank MC on line between MC #13, and the NE corner of section 5, 50m east of the proportioned position.

SKETCH OF REFERENCE TIES & EVIDENCE  
T.143N., R.27W.

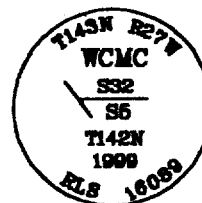
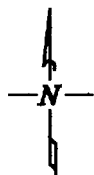

NOT TO SCALE

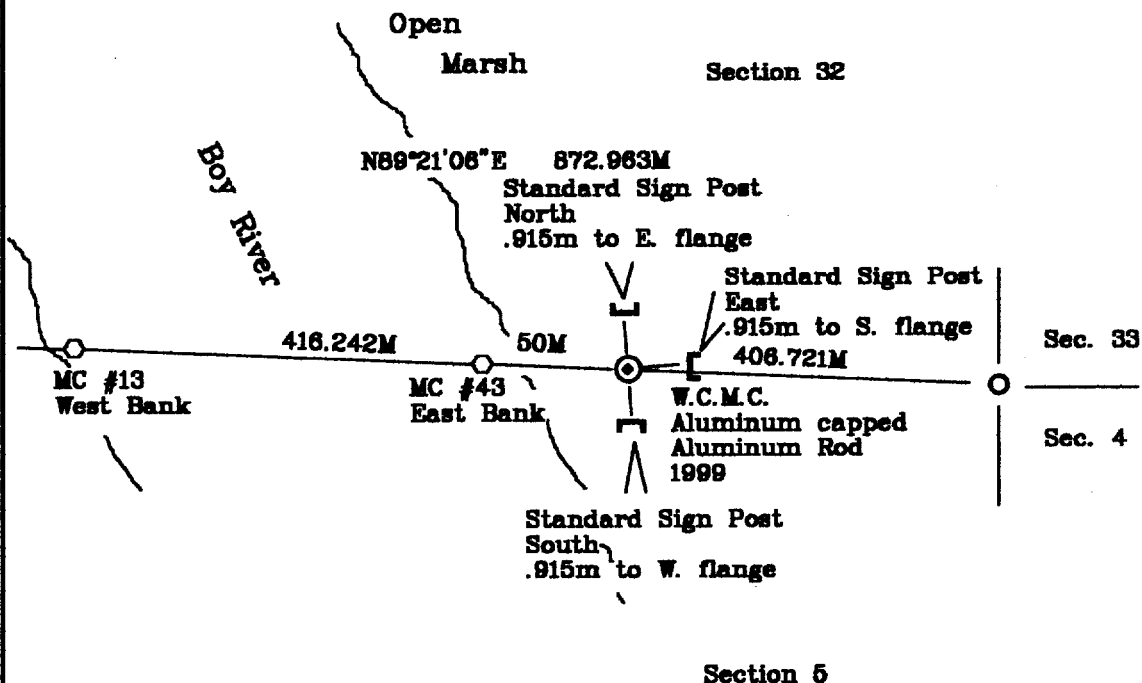

Bearings are Grid North, Minnesota Central Zone, measured with a hand compass adjusted to 3° East declination.

T.142N., R.27W.

Statement of evidence relative to this corner location is on the back of this page

I hereby certify that this survey, plan, or report was prepared by me or under my direct supervision and that I am a duly licensed Land Surveyor under the laws of the State of Minnesota.

*Harold Leuelling* 7-1-99  
Harold Leuelling Date

Licensed Land Surveyor No. 16089  
NORTHERN LIGHTS SURVEYING & MAPPING, INC.

OFFICE OF THE COUNTY RECORDER 414543  
County of Cass

I hereby certify that this document was filed in the Recorder's office.

Time: 9:05 A.M. Date: July 2, 1999

Recorder Claudine Kaylor

By K.F., Deputy

DOCUMENT NO. 414543

## Statement of Evidence

Witness Corner to Meander Corner #43 common to Section 5, Township 142 North, Range 27 West and Section 32, Township 143 North, Range 27 West, of the Fifth Principal Meridian, Cass County, Minnesota, on the east shore of Boy River.

July 1873; General Land Office (G.L.O.) survey notes; P. Conger set a meander corner 30.18 chains west of the SE corner of section 32. The corner was a wooden post and there were no bearing trees available.

September 1873; G.L.O notes for T143N, R27W: Deputy Surveyor William Allen set a wood post for the meander corner, which was 22 chains from his section corner to the east. The corner was referenced with the following:

6" (0.152m) Tamarack  
N12°E  
750 Links (150.876m)

1919; G.L.O. Cadastral Surveyor Earl Harrington retraced the township line between T.142N., R.27W. and T.143N., R.27W. He found the NE corner of section 5 and the meander corner on the west bank of Boy River, but he did not find this corner. It was not reestablished at that time.

Said records are on file with the Secretary of State, St. Paul, Minnesota; copies of these records are on file with the Cass County Surveyor's Office, Walker, Minnesota.

June, 1999; Northern Lights Surveying and Mapping, Inc., crew of Heinle and Shelle Kovanen searched for evidence of the original corner as set by Allen, and proceeded to try and set the MC proportionally between the MC on the west bank and the NE corner of Section 5. This position is located in the river. A WC to the MC was set on line between the west bank MC and the NE corner of section 5 and 50m east of the proportioned position, using a 0.019m aluminum rod 3.353m long, with a stamped 0.083m diameter cap, .230m above the ground. They established the following references:

Standard Sign Post North .915m to E flange	Standard Sign Post East .915m to S flange	Standard Sign Post South .915m to W flange
--	---	--

Northern Lights surveying and Mapping, Inc., Boy River Township Field Book #6, p. 6.

## Coordinates:

## Cass County North

Northing = 69302.213 meters  
Easting = 159655.354 meters

State Plane Coordinate System  
Minnesota Central Zone  
NAD 83

Northing = 339291.142 meters  
Easting = 809782.801 meters

Latitude = 47°09'09.94023" North  
Longitude = 94°07'15.63110" West