

I hereby certify that this document and the data contained herein was prepared by me or under my direct supervision.

Jame Kram SIGNATURE 2/12/99 DATE

Registration No. 23668

- Land Surveyor,  Professional Engineer,
- County Surveyor,  County Engineer.

OFFICE OF THE COUNTY RECORDER

County of Cass

I hereby certify that this document was filed in the Co. Recorders office at 12:45 P .M. on the 23rd day of February A.D. 1999

County Recorder Claudine Kaylor

By K.J. Deputy

DOCUMENT NO. 410191

# CERTIFICATE OF LOCATION OF GOVERNMENT CORNER

15.51 CHAINS WEST OF E 1/4 CORNER

SPECIAL MEANDER Corner of Section 3, Township 141 N, Range 28 W, 5th P.M.

STATE OF MINNESOTA, County of CASS

At the corner location shown on the sketch:

- On 6/26/97 DATE found a GLO MONUMENT UP 0.3 FEET ABOVE TOP OF WATER
- left monument as found,  lowered monument,  removed monument (explain)
- On \_\_\_\_\_ DATE placed a \_\_\_\_\_

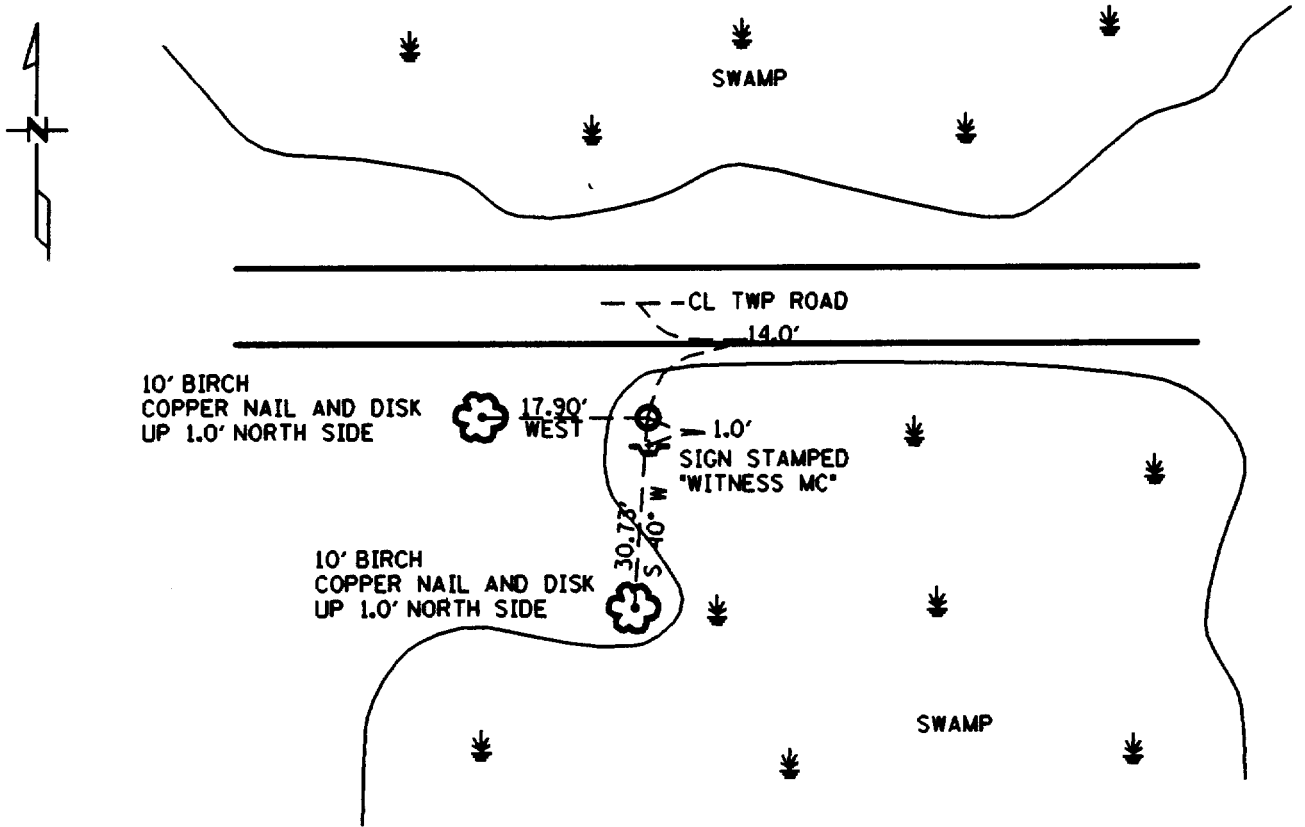

Statement of evidence relative to this corner location is on back of page.

Statement of Evidence: Special M.C. on E-W Quarter line Section 3, T. 141 N. R. 28 W. 5th P.M.

- 1921 US General Land Office dependant resurvey set a 1" x 36" I.P. with a brass cap and marked the following bearings; 8" Poplar S 80 1/2 W 61 links, 6" Poplar N 79 1/2 W 86 links.
- 1972 William Okerman found a GLO monument in good condition and marked the following bearings; 6" Oak S 9 W 65.40 ft., 9" Oak S 57 W 19.10 ft., 5" Elm N 69 E 49.80 ft.
- 1997 Minnesota Dept. Of Transportation found a GLO monument in good condition and marked the following bearings; 10" Birch N 90 W 17.90ft., 10" Birch S 4 W 30.73 ft., steel sign post 1 ft. South. The Minnesota Department of Transportation accepts this position as the correct location for the corner.

For details and survey analysis, contact The Minnesota Department of Transportation District Surveys Office in Baxter Minnesota.