

# CERTIFICATE OF LOCATION OF GOVERNMENT CORNER

NORTHEAST Corner of Section 15, Township 134 N, Range 30 W, 5<sup>th</sup> P.M.

STATE OF MINNESOTA, County of CASS

At the corner location shown on the sketch:

- On 7-7-93 found a 1 1/4" IRON PIPE, UP 0.4', WITH TWO 1 1/4" IRON PIPES  
DATE SLOPING AWAY FROM IT AT 45° ANGLE
- left monument as found,       lowered monument,       removed monument (explain)
- On \_\_\_\_\_ Placed a \_\_\_\_\_  
DATE \_\_\_\_\_

## SKETCH OF REFERENCE TIES



NOTE:  
10"-12" ROCKS PILED AROUND MONUMENT

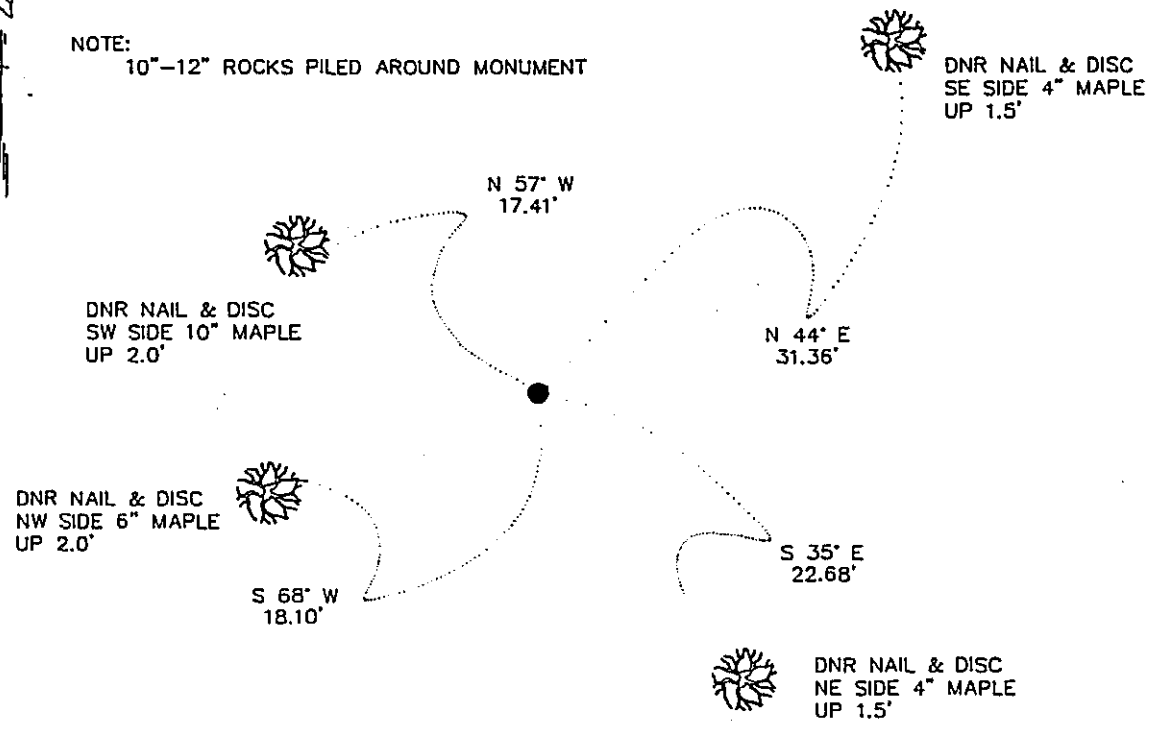

BEARINGS OBSERVED WITH COMPASS

Statement of evidence relative to this corner location is on back of page.

SFT00039.04.00.01  
J.B.M. AUG. 1993

I hereby certify that this document and the data contained herein was prepared by me or under my direct supervision.

Lowell R. Rasmussen SIGNATURE      8-25-93 DATE

Registration No. 17005

- Land Surveyor,       Professional Engineer
- County Surveyor,       County Engineer

OFFICE OF THE COUNTY RECORDER 35197  
County of CASS

I hereby certify that this document was filed in the Co. recorders office at 4:24 P.M. on the 14<sup>th</sup> day of October A.D., 1993  
County Recorder Claudine Kaylan  
By N.B., Deputy  
DOCUMENT NO. 35197

**Northeast Corner Section 15, Township 134 North, Range 30 West**

The DNR Bureau of Engineering contacted the following offices for information regarding this corner:

MN Secretary of State  
Cass County Surveyor  
Cass County Highway Engineer

- 1868 The U.S. General Land Office field notes, on file in the Secretary of State's Office, show this corner to be marked with a post and marked the following bearing trees:  
W. Pine 36" N 18° W 12 lks., W. Pine 36" S 48° W 33 lks.  
W. Pine 24" S 48° E 49 lks., W. Pine 30" N 21° E 77 lks.
- 1911 Cass County Land Corner Record Card, on file in the County Surveyor's Office, shows in County Survey Record Book A, on Pages 465 to 472, A.W. Moulstor found a 1 1/4" iron pipe "set by state surveyor from old Gov't BT Stumps": Burned Pine Stump N 7° 30' W 7.75 ft., Burned Pine Stump N 20° E 50.60 ft., Burned Pine Stump S 47° W 21.30 ft., Burned Pine Stump S 48° 30' E 32.30 ft. Both north stumps marked B.T. Piled rocks around pipe and located a little pot hole S 75° W 80 ft. This information is also on microfilm - roll 105 Book 50 Page 56.
- 1993 July, the DNR Bureau of Engineering conducted a search for this corner and found the following: a 1 1/4" iron pipe up 0.4 ft. with 10" - 12' stones piled around it, two (2) 1 1/4" iron pipes sloping away from the first pipe at a 45° angle down, one to the north, the other to the west. Searched for but did not find any evidence of the government bearing trees. The first iron pipe was found to measure:  
2651.40 ft. from the east quarter corner Section 10  
2644.99 ft. from the north quarter corner Section 14

Analysis of the available information led the DNR Bureau of Engineering to conclude that the found iron pipe up 0.4 ft. marks the location of the corner. Its origin can be traced back to the government bearing trees.