

# CERTIFICATE OF LOCATION OF GOVERNMENT CORNER

NORTHEAST Corner of Section 11, Township 134 N, Range 30 W, 5<sup>th</sup> P.M.

STATE OF MINNESOTA, County of CASS

At the corner location shown on the sketch:

- On 6-28-93 found a SPIKE  
DATE
- left monument as found,     lowered monument,     removed monument (explain)
- On \_\_\_\_\_ Placed a \_\_\_\_\_  
DATE

### SKETCH OF REFERENCE TIES

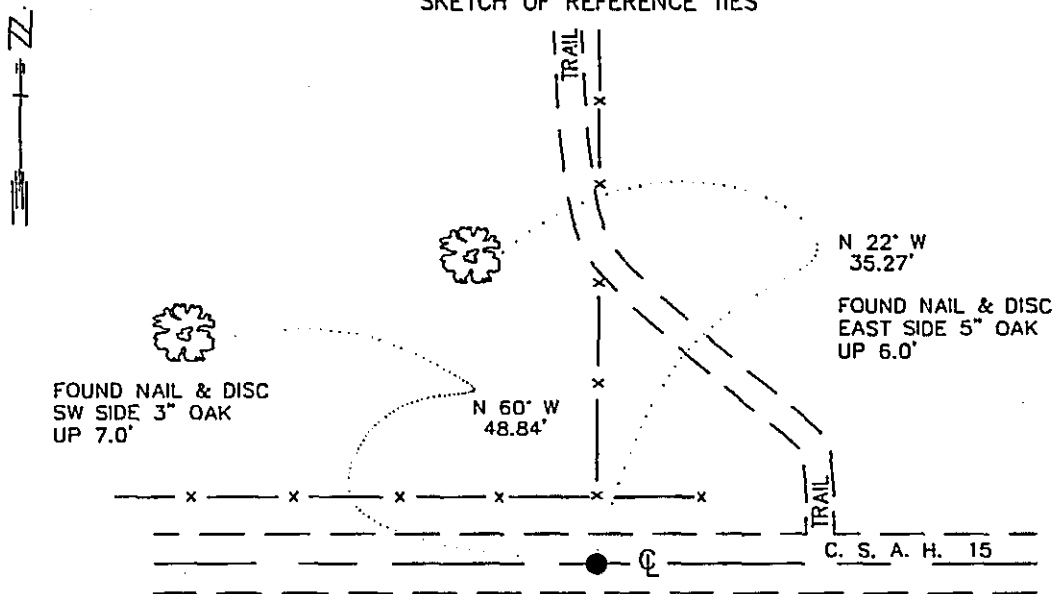

NOTE:  
 MONUMENT IS  
 ON CL E-W ROAD  
 ON OLD DOWN FENCE NORTH  
 ON EAST EDGE TRAIL NORTH

BEARINGS OBSERVED WITH COMPASS

Statement of evidence relative to this corner location is on back of page.

SFT00039.04.00.01  
J.B.M. AUG. 1993

I hereby certify that this document and the data contained herein was prepared by me or under my direct supervision.

Lowell R. Pommeroy SIGNATURE    8-25-93 DATE

Registration No. 17005

- Land Surveyor,     Professional Engineer
- County Surveyor,     County Engineer

OFFICE OF THE COUNTY RECORDER 351914  
 County of CASS

I hereby certify that this document was filed in the Co. recorders office at 4:18 P. .M. on the 14<sup>th</sup> day of OCTOBER A.D., 1993

County Recorder Claudine Kaylan  
 By N.B. ,Deputy

DOCUMENT NO. 351914

**Northeast Corner Section 11, Township 134 North, Range 30 West**

The DNR Bureau of Engineering contacted the following offices for information regarding this corner:

MN Secretary of State  
Cass County Surveyor  
Cass County Highway Engineer

- 1868 The U.S. General Land Office field notes, on file in the Secretary of State's Office, show this corner to be marked with a post and marked the following bearing trees:  
N. Pine 20" S 44 1/2° W 99 lks., N Pine 22" N 5 1/2° E 94 lks.
- No Date The right-of-way map for County State Aid Highway 15 shows an in-place monument at this corner. Corner is shown on the centerline of an east-west road.
- 1990 Cass County Land Corner Record Card, on file in the County Surveyor's Office, shows W. Curo set a pin and temporary ties with a county highway crew.
- 1993 June 28, the DNR Bureau of Engineering conducted a search for this corner and found a spike on the centerline of an east-west gravel road. Searched for and found the 1990 ties which agreed with the spike. Searched for but did not find any evidence of the government bearing trees. Contacted the Cass County Highway Department for further information on this corner. It was learned that a 3/4" iron rod was found at this location, but it had a bent top that would not straighten. Removed the iron rod and set a spike in its location. Spike was found to measure:  
2664.38 ft. from the north quarter corner Section 11  
5299.16 ft. from the northeast corner Section 14

Analysis of the available information led the DNR Bureau of Engineering to conclude that the found spike marks the location of the corner. According to the County Highway Department, the east-west road will soon be paved and they will set a monument at the spike location after paving.