

CERTIFICATE OF LOCATION OF GOVERNMENT CORNER

NORTH QUARTER Corner of Section 34, Township 140, Range 26, 5TH R.M.

STATE OF MINNESOTA, County of CASS

At the corner location shown on the sketch:

- On 12-6-83 found a 1 1/4" IRON PIPE, FLUSH
DATE
- left monument as found, lowered monument, removed monument (explain)
- On _____ placed a _____
DATE

SKETCH OF REFERENCE TIES

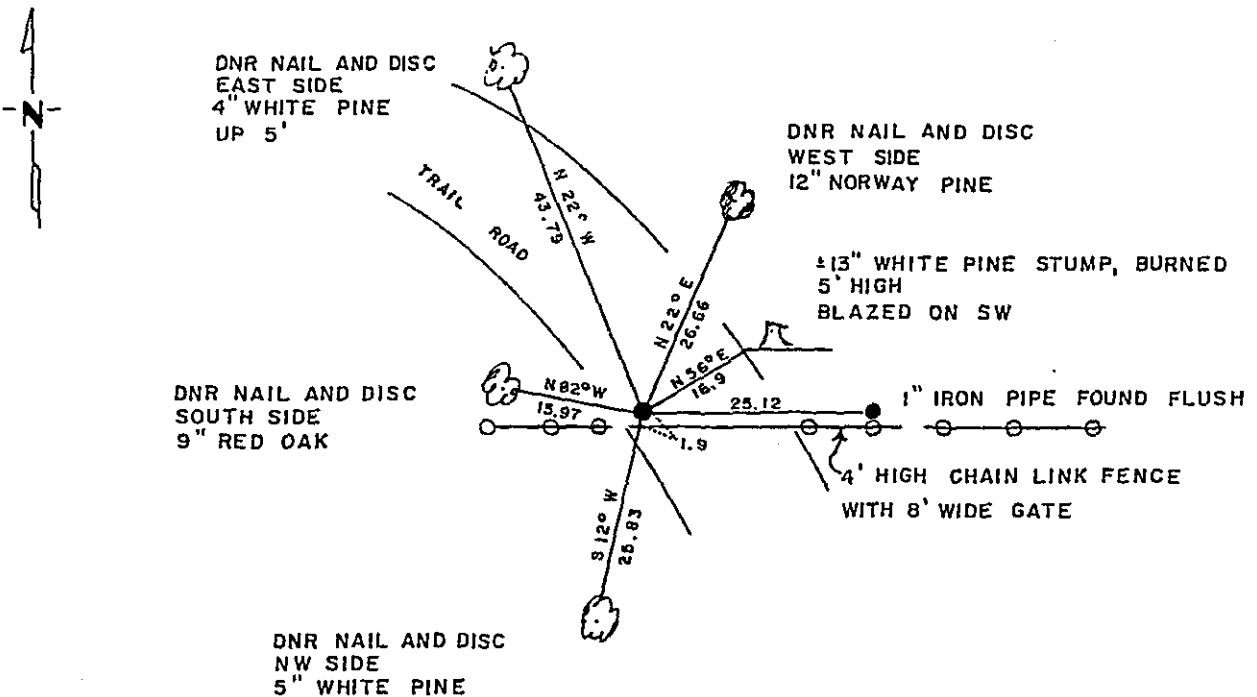

BEARINGS OBSERVED WITH COMPASS

Statement of evidence relative to this corner location is on back of page.

J.A.W. 5-11-84
FO.-717

I hereby certify that this document and the data contained herein was prepared by me or under my direct supervision.

John D. Walker 12-3-92
SIGNATURE DATE

Registration No. 16098

- Land Surveyor, Professional Engineer
- County Surveyor, County Engineer

343673
OFFICE OF THE COUNTY RECORDER
County of Cass

I hereby certify that this document was filed in the Co. recorder's office at 3:05 P. M. on the 10 day of December A.D., 1992
County Recorder Clairine Kayler
By MS Deputy
DOCUMENT NO. 343673

North Quarter Corner Section 34, Township 140 North, Range 26 West

The following offices were contacted for information on this corner:

- Minnesota Secretary of State
- Minnesota Department of Transportation
- Cass County Surveyor
- Wallace F. Buckler, RLS
- Gary Stevenson & Associates
- AMI Surveyors & Mappers
- Widseth, Smith, Nolting, & Associates
- Walt Curo Surveying

1871 This corner was originally established by the U.S. General Land office survey. The government notes show the corner marked with a post and witnessed by the following bearing trees:

- 12° Norway Pine, S. 15° W., 15 links (5.28')
- 12° Norway Pine, N. 57° E., 25 links (16.5')

1964 The Plat of FIRST ADDITION TO JOHANNESHOHN LOTS, by Dean Anderson, RLS, shows an iron pipe at the quarter corner with a distance of 197.19' east along the section line to an iron pipe at the NE corner of Lot 12 of said Plat.

1983 The DNR Bureau of Engineering found a 1 1/4" iron pipe at the quarter corner. A very old and burned 13" White Pine stump with a blaze on its SW side was found N. 56° E., 16.9' from the iron pipe. A 1" iron pipe was found at a distance of 197.20' easterly of the 1 1/4" pipe.

The 1 1/4" iron pipe was accepted as marking the quarter corner position.

For information regarding this survey, contact the MN Department of Natural Resources, Bureau of Engineering, Survey Section, 500 Lafayette Road, St. Paul, MN 55155-4029

