

# CERTIFICATE OF LOCATION OF GOVERNMENT CORNER

East Quarter                      Corner of Section 20, Township 141, Range 28, 5th P.M.

STATE OF MINNESOTA, County of Cass

At the corner location shown on the sketch:

- On                      found a                       
DATE
- left monument as found,  lowered monument,  removed monument (explain)
- On 11/17/92 placed a 2 inch by 48 inch iron monument with brass  
DATE  
cap up 14 inches.

Magnetic Decl: 5° East SKETCH OF REFERENCE TIES  
 Not to Scale

All distances are horizontal to nail in side of tree

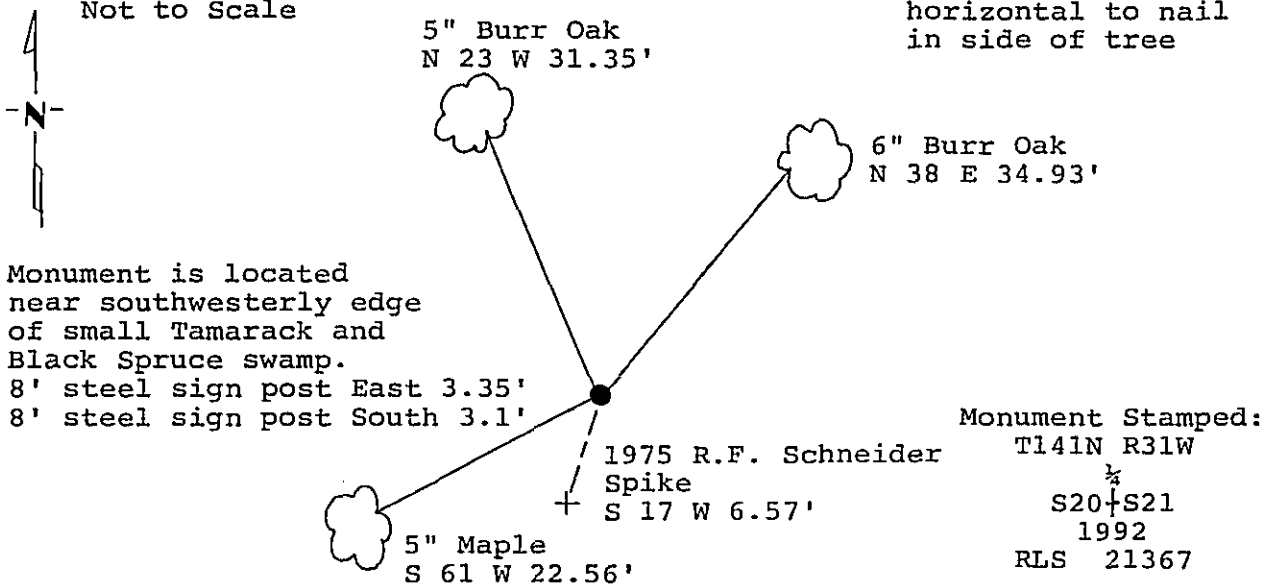

Monument is located near southwesterly edge of small Tamarack and Black Spruce swamp.  
 8' steel sign post East 3.35'  
 8' steel sign post South 3.1'

All bearing trees are scribed, painted with red enamel and marked with a 54-3 (bearing tree) tag.

Statement of evidence relative to this corner location is on back of page. 343559

I hereby certify that this survey, plan or report was prepared by me or under my direct supervision and that I am a duly Registered Land Surveyor under the laws of the State of Minnesota.

Terry L. Freeman  
 Terry L. Freeman  
 Date 12/8/92 Registration No. 21367

OFFICE OF THE COUNTY RECORDER  
 County of Cass

I hereby certify that this document was filed in the Co. Recorders office at 3:20 P.M. on the 8 day of December A.D., 19 92  
 County Recorder Claudia Karlyn  
 By MS, Deputy  
 DOCUMENT NO. 343559

Statement of Evidence:

East Quarter corner, Section 20, Township 141 North,  
Range 31 North, Cass County, Minnesota

P-9

1873 P.H. Conger, U.S. Deputy Surveyor, originally established this corner position while subdividing Township 141 North, Range 31 West. The notes indicate that he set a wood post and marked the following bearing trees: an 8 inch Norway Pine North 74 degrees East a distance of 70 links (46.20 feet); and an 11 inch Norway Pine North 71 degrees West a distance of 31 links (20.46 feet).

1962 on May 2, United States Forest Service notes for Township 141 North, Range 31 West in Book 1, page 74, show that R.H. McDonald searched for the corner and found no original evidence.

1975 on May 30, R.F. Schneider, Licensed Land Surveyor Number 5740, searched for corner and found no evidence. His notes in his Book 37, page 51, show that he set a spike at the single proportion position and marked the following bearing trees: a 10 inch Birch North 22 degrees East a distance of 11.10 feet; a 5 inch White Oak South 26 degrees East a distance of 54.81 feet and a 10 inch Red Oak South 19 degrees West a distance of 41.79 feet.

1992 on July 28, a Landecker & Associates of Walker, Inc., survey crew found the 1975 Schneider spike and ties.  
1992 on November 17, a Landecker & Associates of Walker, Inc., survey crew set a 2 inch by 48 inch iron monument with brass cap up 14 inches at the lost, single proportion position between the Northwest and Southwest corners of Section 21 (see note below). New bearing trees were marked as shown and steel sign posts set as noted on front of this certificate.

Note: This corner position is different than that established by R.F. Schneider in 1975 due to the recovery of the obliterated position of the true original corner at the Northwest corner of Section 21, which Schneider had previously established by double proportion methods.