

CERTIFICATE OF LOCATION OF GOVERNMENT CORNER

East Quarter Corner of Section 24, Township 141, Range 29, 5th P.M.

STATE OF MINNESOTA, County of Cass

At the corner location shown on the sketch:

- On 5/22/92 found a 1 inch iron bent 6 inches below road surface
and 5 $\frac{1}{2}$ by 5 $\frac{1}{2}$ concrete monument with brass cap 24 inches below
 left monument as found, lowered monument, removed monument (explain)
- On _____ placed a _____
DATE

Magnetic Decl: 5° East SKETCH OF REFERENCE TIES
 Not to Scale

All distances are horizontal to nail in side of tree.

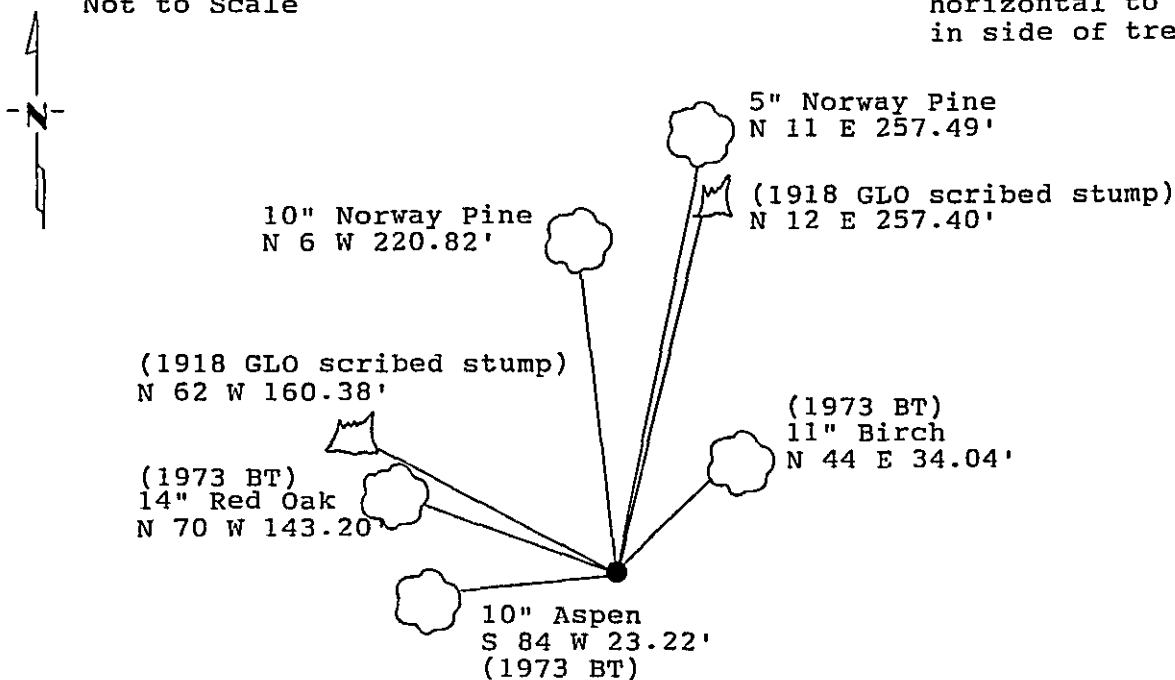

All bearing trees are scribed, painted with red enamel and marked with a 54-3 (bearing tree) tag.

Statement of evidence relative to this corner location is on back of page. 341347

I hereby certify that this survey, plan or report was prepared by me or under my direct supervision and that I am a duly Registered Land Surveyor under the laws of the State of Minnesota.

Terry L. Freeman
 Terry L. Freeman
 Date 9/18/92 Registration No. 21367

OFFICE OF THE COUNTY RECORDER
 County of Cass

I hereby certify that this document was filed in the Co. Recorders office at 9:35 A.M. on the 21 day of Sept A.D., 19 92

County Recorder Claudia Kayler
 By (m), Deputy

DOCUMENT NO. 341347

Statement of Evidence:

East Quarter corner, Section 24, Township 141 North,
Range 29 West, Cass County, Minnesota

P-25

1873 P.H. Conger, U.S. Deputy Surveyor, originally established this corner position while running the east line of Township 141 North, Range 29 West. The notes indicate that he set a wood post and marked a bearing tree: a 13 inch Pine stub South 71 degrees East a distance of 84 links (55.44 feet).

1915 Cass County Surveyor's Office Record Book "B", Pages 169-177 and microfilm roll 10S, Book 60, Page 145, show a survey by John Curo. The notes indicate that he set a 2 and 1/2 inch by 48 inch capped iron.

1917 Cass County Surveyor's Office Record Book "C", Page 527 and microfilm roll 11S, Book 77, Page 105, shows a survey by E.B. Horst. The notes indicate that he found an iron pipe and marked the following bearing trees: a 20 inch White Pine stump North 50 degrees 50 minutes West a distance of 27.9 feet; and a 4 inch Tamarack North 27 degrees 22 minutes East a distance of 42.4 feet.

1918 General Land Office records shows survey by Earl Harrington. The notes indicate that he set a 1 inch by 36 inch iron pipe with brass cap proportionally, 36 inches in ground 9.24 feet south of 2 inch iron pipe set by County Surveyor. He marked the following new bearing trees: an 8 inch Norway Pine North 12 and 3/4 degrees East a distance of 390 links (257.40 feet); and an 8 inch White Pine North 62 and 1/4 degrees West a distance of 243 links (160.38 feet).

1935 Civilian Conservation Corps found a bearing tree: a 15 inch Norway Pine North 70 degrees West a distance of 145.2 feet scribed 1/4 24 BT. Placed a Forest Service Location Poster on a telephone pole on north side of old railroad grade from which the corner bears Northwest 231 feet.

1973 on April 9, United States Forest Service notes in Book 3 of Township 141 North, Range 28 West, Page 68 show survey by J. Ekstrom. The notes indicate that the brass cap could not be found, it had been graded out. He did, however, find both 1918 General Land Office bearing tree stumps. He set a 5 and 1/2 inch by 5 and 1/2 inch by 24 inch concrete monument with brass cap 6 inches below road surface and marked the following new bearing trees: a 14 inch Oak North 71 degrees West a distance of 143.30 feet; a 10 inch Aspen South 84 degrees West a distance of 23.50 feet; and an 11 inch Birch North 44 degrees East a distance of 34.20 feet. A 6 foot steel sign post was set West a distance of 12.60 feet with a 54-4 sign.

1973 on April 9, Milo Stefan, Registered Land Surveyor Number 12261, filed a Certificate of Location of Government Corner showing the 1973 United States Forest Service information.

CERTIFICATE OF LOCATION OF GOVERNMENT CORNER

East Quarter corner, Section 24, Township 141 North,
Range 29 West, Cass County, Minnesota

P-25

1986 on May 5, United States Forest Service notes in Book 3 of Township 141 North, Range 28 West, Page 68, shows that Survey Technician Krause found the 1973 concrete monument 6 inches below the road surface and the Northwest and Southwest 1973 bearing trees in good shape. The Northeast bearing tree was found to be a 20 foot snag.

1992 on May 22, a Landecker & Associates of Walker, Inc., survey crew found a 1 inch iron bent 6 inches below road surface. They pulled the iron and dug down 24 inches to uncover a 5 and 1/2 inch by 5 and 1/2 inch concrete monument with brass cap. They placed a 1/2 inch by 24 inch iron pipe over the monument and left it as is. They also found the 1918 General Land Office bearing tree stumps with scribing in fair condition. The 1973 United States Forest Service ties were found as shown on front of this certificate. They marked two new bearing trees as shown on front of this certificate. Landecker & Associates of Walker, Inc., accepts the found concrete monument as marking the obliterated 1918 General Land Office corner and the true proportional position between the Northeast corner and Southeast corner position.