

CERTIFICATE OF LOCATION OF GOVERNMENT CORNER

Northwest Corner of Section 31, Township 142, Range 31, 5th P.M.

STATE OF MINNESOTA, County of Cass

At the corner location shown on the sketch:

- On 1/9/91 found a USFS ties for nail set from original
Northeast Pine bearing tree (stump)
 left monument as found, lowered monument, removed monument (explain)
- On 2/2/91 placed a 2 inch by 48 inch iron pipe with brass cap

Magnetic Decl: 5° East
Not to Scale

SKETCH OF REFERENCE TIES

All distances are horizontal to nail in side of tree

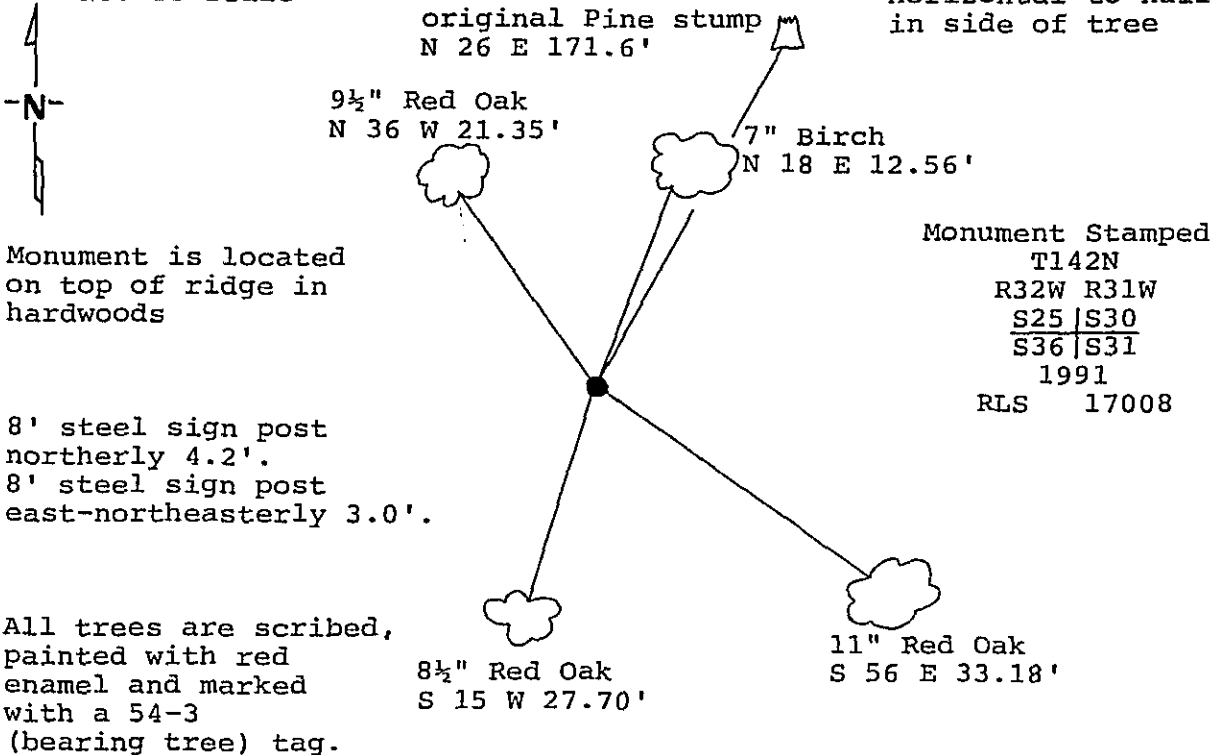

Statement of evidence relative to this corner location is on back of page. 327275

I hereby certify that this document and the data contained herein was prepared by me or under my direct supervision.

Wm A. Erdick 3/6/91
SIGNATURE DATE

Registration No. 17008

Land Surveyor, Professional Engineer
 County Surveyor, County Engineer

OFFICE OF THE REGISTER OF DEEDS
County of Cass

I hereby certify that this document was filed in the Reg. of Deeds office at 3:00 P.M. on the 11 day of March A.D., 1991

Register of Deeds *Claudia Kayler*
By *MJ*, Deputy

DOCUMENT NO. 327275

Northwest corner, Section 31, Township 142 North,
Range 31 West, Cass County, Minnesota

V-1 142-31

1871 George Stuntz, U.S. Deputy Surveyor, originally established this corner position while running the West line of Township 142 North, Range 31 West. The notes indicate a wood post was set to mark the corner position and the following witnesses: a 17 inch Yellow Pine South 30 degrees West a distance of 179 links; a 25 inch White Pine North 26 degrees East a distance of 260 links; and a 20 inch Yellow Pine South 5 degrees East a distance of 363 links.

1987 United States Forest Service personnel search for corner. They find strong evidence of original Northeast bearing tree. Southwest and Southeast bearing trees seem to be obliterated. Some evidence, but burned stumps or rotted depressions remain. The USFS set spike from Northeast bearing tree for corner.

1988 United States Forest Service personnel tie nail as set from Northeast bearing tree stump into traverse of the East line of the township. Ties: 7 inch Red Oak East a distance of 4.99 feet; a 4 inch Birch Northwest a distance of 12.38 feet; and a 4 inch Red Oak South a distance of 3.75 feet.

1990-1991 Landecker & Associates, Inc. review search and traverse notes of USFS of the East township line. They accept the position as established by USFS in 1987 from original Northeast bearing tree as establishing the corner in its obliterated position of original corner. The spike set in 1987 was missing; however the survey crew set a new spike from the three 1988 USFS ties for corner while traversing the East township line. On February 2, 1991 the survey crew set a 2 inch by 48 inch iron pipe with brass cap up 10 inches. New bearing trees were marked as shown and steel sign posts set as noted on front of this certificate.