

CERTIFICATE OF LOCATION OF GOVERNMENT CORNER

West Quarter _____ Corner of Section 18, Township 142, Range 31, 5th P.M.

STATE OF MINNESOTA, County of Cass

At the corner location shown on the sketch:

- On _____ found a _____
DATE
- left monument as found, lowered monument, removed monument (explain)
- On 1/29/91 placed a 3/4" aluminum drive rod with stamped
DATE
aluminum cap

Magnetic Decl: 5° East SKETCH OF REFERENCE TIES
 Not to Scale

All distances are horizontal to nail in side of tree

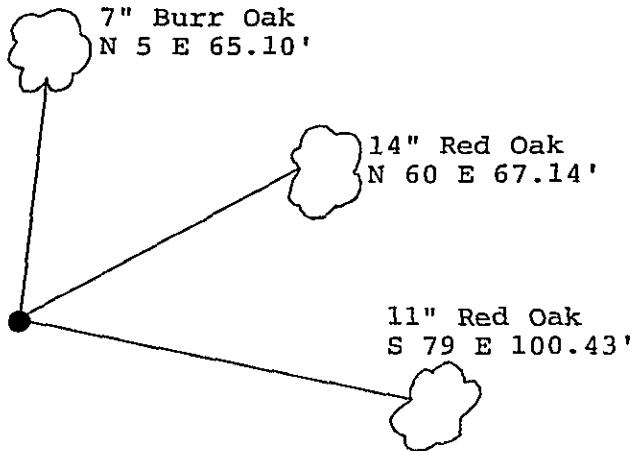
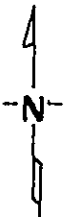

Monument is located in Tag Elder and Willow swamp, 20'± southerly of the swamp edge.
 8' Steel sign post Northerly 3.20'
 8' Steel sign post Southerly 3.05'

Monument Stamped
 T142N
 R32W, R31W
 S13¹/₂S18
 1991
 RLS 17008

All trees are scribed, painted with red enamel and marked with a 54-3 (bearing tree) tag.

Statement of evidence relative to this corner location is on back of page. 327269

I hereby certify that this document and the data contained herein was prepared by me or under my direct supervision.

Neil O. Kralik 3/6/91
SIGNATURE DATE

Registration No. 17008

- Land Surveyor, Professional Engineer
 County Surveyor, County Engineer

OFFICE OF THE REGISTER OF DEEDS

County of Cass

I hereby certify that this document was filed in the Reg. of Deeds office at 2:30 P. .M. on the 11 day of March A.D., 19 91

Register of Deeds *Claudia Kogler*

By *MS*, Deputy

DOCUMENT NO. 327269

West Quarter corner, Section 18, Township 142 North,
Range 31 West, Cass County, Minnesota

L-1 142-31

1871 George Stuntz, U.S. Deputy Surveyor, originally established this corner position while running the West line of Township 142 North, Range 31 West. The notes indicate a wood post was set to mark the corner position and the following witnesses: an 8 inch Tamarack South 35 degrees West a distance of 12 links; and a 7 inch Tamarack South 30 degrees East a distance of 92 links.

1921 County Surveyor's Record Book C, page 473 shows survey by E.B. Horst. The notes indicate a 2 inch by 48 inch iron monument was set at the single proportion position between the Northwest corner of Section 18 and the West Quarter corner of Section 19. The notes do not indicate that any bearing trees were marked.

1921 County resurvey in County Recorder's Office file cabinet E number 59 shows survey by E.B. Horst. The notes indicate a 2 inch by 48 inch iron monument was found.

1988 United States Forest Service personnel traverse the West line of Township 142 North. They find the 2 inch iron pipe as set by Horst in 1921.

1990 Landecker & Associates, Inc. review the USFS notes. A new corner was computed by single proportion measurement between the Northwest corner of Section 18 and the West Quarter corner of Section 19 as recovered by the USFS in 1988. No evidence was found of the original survey at this new location. The corner was determined to be lost.

1991 on January 29, a Landecker & Associates, Inc. survey crew set a 5 foot aluminum rod with point, 3 foot stabilizer and aluminum cap at the single proportion position between the Northwest corner of Section 18 and the West Quarter corner of Section 19 in Tag Elder & Willow swamp. New bearing trees were marked as shown and steel sign posts set as noted on front of this certificate. The 2 inch iron pipe set by Horst in 1921 is northwest approximately 104 feet.