

CERTIFICATE OF LOCATION OF GOVERNMENT CORNER

East Quarter _____ Corner of Section 6, Township 140, Range 31, 5th P.M.

STATE OF MINNESOTA, County of Cass

At the corner location shown on the sketch:

- On _____ found a _____
DATE
- left monument as found, lowered monument, removed monument (explain)
- On 6/4/90 placed a 2" tubular monument with aluminum cap
DATE

Magnetic Decl: 5° East
Not to Scale

SKETCH OF REFERENCE TIES

All distances are horizontal to nail in side of tree

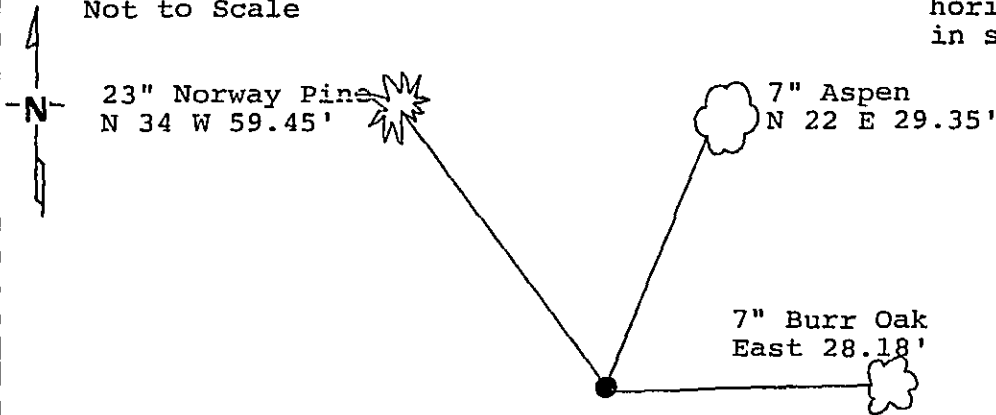

Monument is located 15'± northerly of North edge of small Tag Elder and Tamarack swamp near toe of southerly facing slope. Set a 6' steel sign post northerly 2.0'.

Monument Stamped
T140N R31W
1/4
S6+S5
1990
RLS 17008

Statement of evidence relative to this corner location is on back of page 325135

I hereby certify that this document and the data contained herein was prepared by me or under my direct supervision.

[Signature] 11/15/90
SIGNATURE DATE

Registration No. 17008

- Land Surveyor, Professional Engineer
- County Surveyor, County Engineer

OFFICE OF THE REGISTER OF DEEDS

County of Cass

I hereby certify that this document was filed in the Reg. of Deeds office at 3:49 P.M. on the 21 day of November A.D., 19 90

Register of Deeds Claudia Kayler

By [Signature], Deputy

DOCUMENT NO. 325135

East Quarter corner Section 6, Township 140
North, Range 31 West, Cass County, Minnesota

C-5 140-31

1870 set a post and marked the following bearing trees: an 8 inch Pine North 52 degrees West a distance of 19 links; and a 12 inch Norway Pine South 74 degrees East a distance of 69 links.

1990 Landecker-Stevenson & Associates, Inc. survey crew found remains of stumps of original bearing trees. Obliterated position from stumps fit closely with the original measurement to the closing corner to Sections 5 and 6.

6/4/90 a Landecker & Associates, Inc., Walker, Minnesota, survey crew set a 2 inch tubular monument with aluminum cap. Three new bearing trees were marked and sign post set as shown on front of this certificate.