

CERTIFICATE OF LOCATION OF GOVERNMENT CORNER

East Quarter Corner of Section 10, Township 143N, Range 26W, 5th P.M.

STATE OF MINNESOTA, County of Cass

At the corner location shown on the sketch:

- On _____ found a _____
DATE
- left monument as found, lowered monument, removed monument (explain)
- On 5-3-1990 placed a 2" X 54" brass capped monument
DATE

Monument Marked

SKETCH OF REFERENCE TIES
not to scale

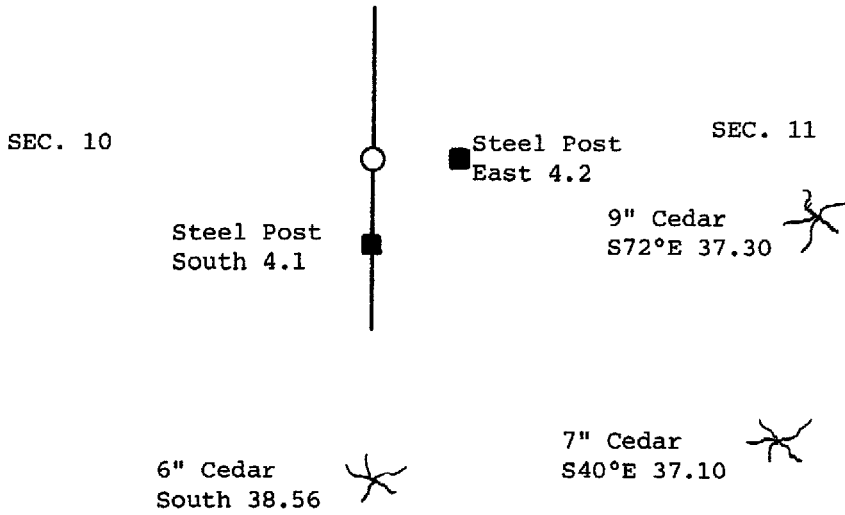
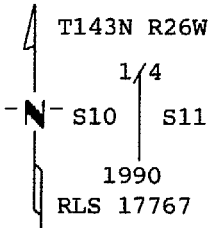

bearings are true

All trees are scribed, painted with a 30d spike in side and USFS 54-3 tag.

Statement of evidence relative to this corner location is on back of page.

323153

I hereby certify that this survey, plan or report was prepared by me or under my direct supervision and that I am a duly Registered Land Surveyor under the laws of the State of Minnesota.

William C. Osage

Date 8/22/90 Registration No. 17767

OFFICE OF THE COUNTY RECORDER

County of Cass

I hereby certify that this document was filed in the Co. Recorders office at 3:12 P. M. on the 28 day of August A.D., 19 90

County Recorder Clairine Kayler

By MS, Deputy

DOCUMENT NO. 323153

Statement of Evidence:

G17 East quarter corner section 10

1/4 Cor. 10 and 11 (E 1/4 Cor. Sec. 10)

- 1872 U.S. General Land Office survey set wood post for corner, the following references were noted:
Aspen 5" S 46 degrees E, 6 Links (3.96 feet)
Spruce 4" N 31 degrees W, 6 Links (3.96 feet)
- 1916 James Flynn, Cass County Book C, Page 171, Survey Record No. 413, found following BT partly obliterated:
Spruce 6" N 31 degrees W, 6 Links
no new BT's were added.
- 1963 A FSLP was placed on an Aspen by personnel of the Remer Ranger district.
- 1969 Curt Krause, USFS, chained to area from section corner to south, found 1963 tag on 10" Aspen close to search area, found no other evidence.
- 10-4-1989 Personnel from Kovanen & Osufsen Inc. found USFS approximate 1/4 corner tag dated 4-13-1979, DNR signs East and West along cutout line, old fence line (down) runs N 25 degrees E from old road, 30' along fence, find 6" Spruce with scar (down), no other evidence found. This search area is on old E - W road.
- 5-3-1990 Personnel from Kovanen & Osufsen Inc. made an additional search of area and set a 2" x 54" brass capped monument in lost position on line between the found northeast corner of section 10 and the reestablished southeast corner of section 10 and mark the following witnesses:
Cedar 9" S 72 degrees E, 37.30 feet
Cedar 7" S 40 degrees E, 37.10 feet
Cedar 6" South, 38.56 feet
Set 8' long steel sign post with sign attached, East 4.2 feet
Set 8' long steel sign post with sign attached, South 4.1 feet

This position is not traceable to the original GLO corner, but accepted as corner for lack of further evidence.