

# CERTIFICATE OF LOCATION OF GOVERNMENT CORNER

Witness Corner

to Southeast Corner of Section 35, Township 141 N, Range 29 W, 5th P.M.

STATE OF MINNESOTA, County of Cass

At the corner location shown on the sketch:

Latitude: 46° 58' 45.601"  
 Longitude: 94° 18' 13.143"

On 11/9/88 found a tipped out monument

left monument as found,  lowered monument,  removed monument (explain)

On 4/21/89 placed a 2 inch by 48 inch iron pipe with brass cap and plastic base with magnet.

Magnetic Decl: 5° East  
 Not to Scale

SKETCH OF REFERENCE TIES

All distances are horizontal to nail in side of tree.

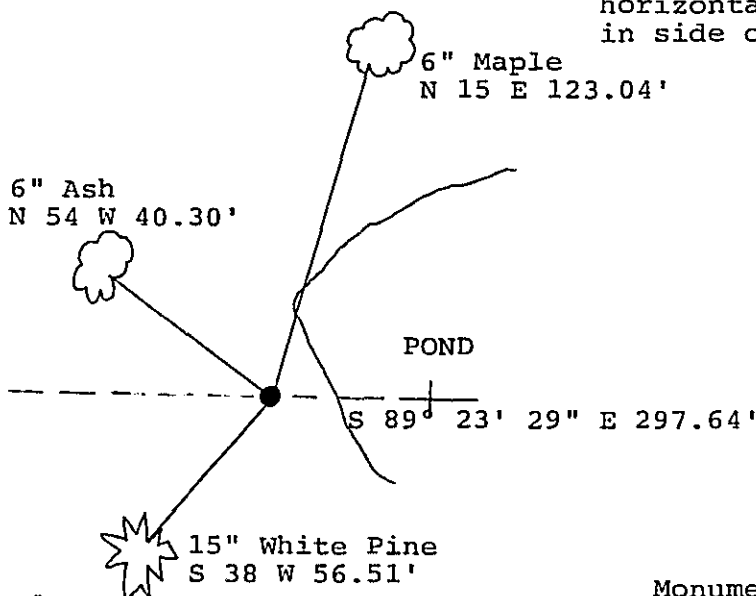
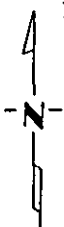

Monument is located  
 23'± Westerly of waters  
 edge.  
 8' steel sign post 4.0' West

Monument Stamped  
 R29W  
 SC  
 T141N S35 S36WC  
 T140N S2  
 1989  
 RLS 17008

All trees are painted with red enamel  
 and marked with a 54-3 (bearing tree) tag.

Statement of evidence relative to this corner location is on back of page.

312367

I hereby certify that this survey, plan or report was prepared by me or under my direct supervision and that I am a duly Registered Land Surveyor under the laws of the State of Minnesota

David S. Landecker  
 David S. Landecker  
 Date 5-24-89 Registration No. 17008

OFFICE OF THE COUNTY RECORDER  
 County of Cass

I hereby certify that this document was filed in the Co. Recorders office at 10:35 A.M. on the 25 day of May A.D., 19 89  
 County Recorder Claudia Kayler  
 By MS Deputy  
 DOCUMENT NO. 312367

Statement of Evidence:

Witness Corner to the Standard Southeast Corner  
Section 35, Township 141 North, Range 29 West,  
Cass County, Minnesota

Z-21 141-29  
Bk.6 Pg.41

1863 Johnson and Thornton, U.S. Deputy Surveyors, originally established this corner position while running the 10th Standard Parallel. The notes indicate a wood post was set to mark the witness corner position 4.51 chains West of the Southeast corner of said section and the following witnesses: a 14 inch White Birch North 42 degrees West a distance of 35 links; and a 12 inch White Birch South 60 degrees East a distance of 29 links.

1915 John Curo, surveyed Section 2, Township 140 North, Range 29 West and set a 2 and 1/4 inch by 48 inch iron pipe with cap as a witness corner to the Southeast corner of said Section 35.

1983 Gary Stevenson, Registered Land Surveyor Number 12684, found tipped County monument. He did not find original corner. Mr. Stevenson set a reference monument to the Southeast corner northerly on the section line between Sections 35 and 36.

1986 U.S. Forest Service crews set an aerial target over this corner position for determination of coordinate values through the use of GPS on the Chippewa South Boundary Project Cadastral Survey U.S. Project Number 53-6392-8-219. This target allowed for the search and location of this corner.

1988 a Landecker-Stevenson & Associates crew searched for the original witness corner. The following information was found and noted: no evidence of the original corner or Birch bearing trees from 1863. Found 2 inch County capped iron pipe tipped out monument that was established by Curo, (not original witness corner).

1989 on April 21 a Landecker-Stevenson & Associates crew set a 2 inch by 48 inch iron pipe with brass cap and plastic base with magnet for witness corner to the standard Southeast corner in the same position as noted in the original survey. This witness is North 89 degrees 23 minutes 29 seconds West 297.64 feet from the Southeast corner thereof. New bearing trees were marked as shown and a steel sign post was set as noted on front of this certificate.