

# CERTIFICATE OF LOCATION OF GOVERNMENT CORNER

Standard

South Quarter Corner of Section 32, Township 141 N, Range 28 W, 5th P.M.

STATE OF MINNESOTA, County of Cass

At the corner location shown on the sketch: Latitude: 46° 58' 43.559"  
Longitude: 94° 14' 59.419"

On 10/17/88 found a 1 and 1/4" well point  
DATE

left monument as found,  lowered monument,  removed monument (explain)

On 4/12/89 placed a 3/4" by 5' aluminum rod with 3' fluted top  
DATE  
and stamped aluminum cap.

Magnetic Decl: 5° East SKETCH OF REFERENCE TIES  
Not to Scale

All distances are horizontal to nail in side of tree.

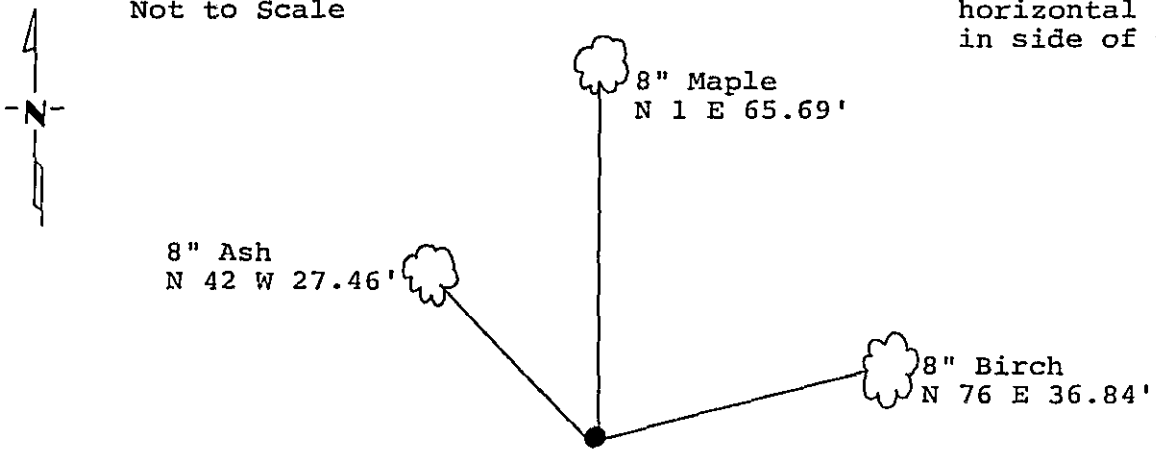

Monument is located 10' northwest of southeast corner of swamp and ±175' west of road.

All trees are painted with red enamel and marked with a 54-3 (bearing tree) tag.

Monument Stamped  
R28W  
SC  
T141N S 1/2 S32  
T140N S5  
1989  
RLS 17008

Statement of evidence relative to this corner location is on back of page. 312 357

I hereby certify that this survey, plan or report was prepared by me or under my direct supervision and that I am a duly Registered Land Surveyor under the laws of the State of Minnesota.

David S. Landecker  
David S. Landecker  
Date 5-28-89 Registration No. 17008

OFFICE OF THE COUNTY RECORDER

County of Cass

I hereby certify that this document was filed in the Co. Recorders office at 2:45 A. M. on the 25 day of May A.D., 19 89

County Recorder Christine Kayler

By MS Deputy

DOCUMENT NO. 312 357

Statement of Evidence:

Standard South Quarter Corner Section 32, Township  
141 North, Range 28 West, Cass County, Minnesota

Z-7 141-28  
Bk.7 Pg.21

1863 Johnson and Thornton, U.S. Deputy Surveyors, originally established this corner position while running the 10th Standard Parallel. The notes indicate a wood post was set to mark the corner position and the following witnesses: a 9 inch White Birch North 16 degrees West a distance of 13 links; and a 6 inch White Birch North 20 degrees East a distance of 13 links.

1912 County Survey Record Book B pages 265-269 shows survey by John Curo and Harry S. Todd, whereby Todd reestablished the section corners and monumented same along the 10th Standard Parallel for the entire South line of this township. These corner positions were determined proportionally between the Southeast and Southwest township corners.

1918 the U.S. General Land Office resurveyed portions of this township and in the process did not recover this corner. They used the Southwest and Southeast corners of the township to proportion along the South line of the township.

1920's John Curo performed numerous surveys along the South line of this township in which he also proportioned in the Section and Quarter corners as noted by Todd. The Curo and Todd surveys differed slightly in overall dimensions. However, their theory and principles were the same.

1973 W.J. Spain surveys the plat of NORTHLAND ACRES. Plat shows corner as monumented.

Numerous local surveyors have used the monument as found by Spain in 1973, and established proportionally.

1986 U.S. Forest Service crews set an aerial target in the vicinity of this corner for the search and establishment of the true corner position. The target having coordinate values through the use of GPS on the Chippewa South Boundary Project Cadastral Survey U.S. Project Number 53-6392-8-219. This target allowed for the search and location of this corner.

1988 on October 17 a Landecker-Stevenson & Associates crew searched for the corner. The following information was found and noted: found Quarter Corner pipe as noted and fitting Spains plat.

1989 on April 12 a Landecker-Stevenson & Associates crew remove found pipe and set a 3/4 inch by 5 foot aluminum rod with 3 foot fluted top and stamped aluminum cap in its location. It was determined this pipe fit the plat monuments and resembled the single proportionate position determined on the Standard Parallel for its location between the Southeast and Southwest corners of the township. New bearing trees were marked as shown and a steel sign post was set as noted on front of this certificate.