

# CERTIFICATE OF LOCATION OF GOVERNMENT CORNER

Number 16 Meander Corner of Section 33, Township 141 N, Range 29 W, 5th P.M.

STATE OF MINNESOTA, County of Cass

At the corner location shown on the sketch: Latitude: 46° 58' 46.623"  
 Longitude: 94° 21' 42.672"

On \_\_\_\_\_ found a \_\_\_\_\_  
DATE

left monument as found,  lowered monument,  removed monument (explain)

On 4/11/89 placed a 3/4 inch by 5 foot aluminum rod with 3 foot  
DATE  
fluted top and stamped aluminum cap.

Magnetic Decl: 5° East SKETCH OF REFERENCE TIES  
 Not to Scale

All distances are horizontal to nail in side of tree.

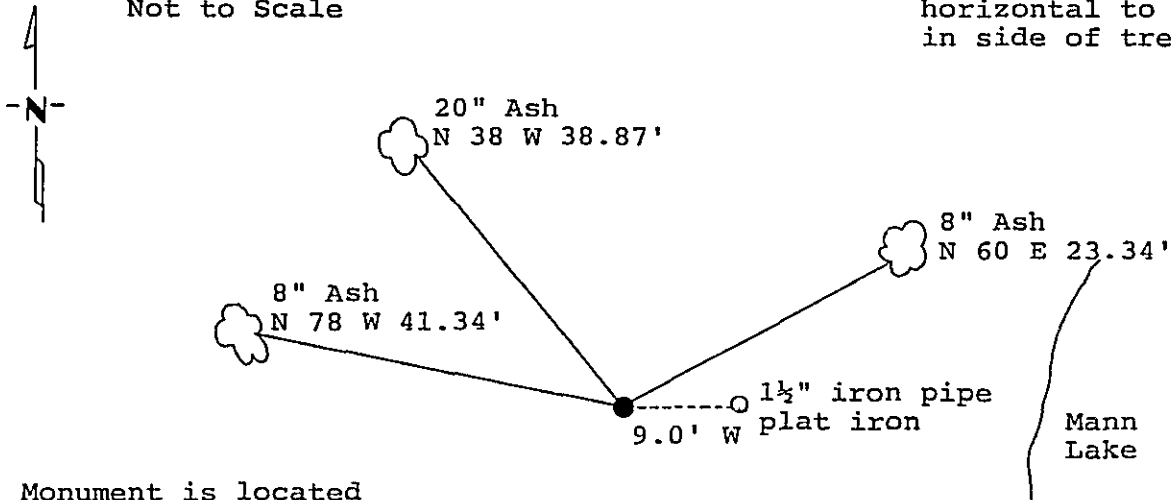

Monument is located  
 85'± Westerly of  
 waters edge and 50'±  
 Easterly of 4 foot high  
 bank.  
 8' Steel sign post West 4.0'

All trees are painted with red enamel and marked with a 54-3 (bearing tree) tag.

Monument Stamped  
 R29W  
 T141N S33/  
 T140N S 4 MC  
 1989  
 RLS 17008

Statement of evidence relative to this corner location is on back of page.

312158

I hereby certify that this survey, plan or report was prepared by me or under my direct supervision and that I am a duly Registered Land Surveyor under the laws of the State of Minnesota.

David S. Landecker  
 David S. Landecker  
 Date 5-12-89 Registration No. 17008

OFFICE OF THE COUNTY RECORDER

County of Cass

I hereby certify that this document was filed in the Co. Recorders office at 4:08 P. M. on the 15 day of May A.D., 1989

County Recorder Claudia Kayler

By ms, Deputy

DOCUMENT NO. 312158

Statement of Evidence:

Meander Corner Number 16 Section 33, Township 141 North, Range 29 West, Cass County, Minnesota

Z9-10 141-29  
Bk.6 Pg.25

1863 Johnson and Thornton, U.S. Deputy Surveyors, originally established this corner position while running the 10th Standard Parallel. The notes indicate a wood post was set to mark the corner position and the following witnesses: a 6 inch Tamarack North 33 degrees East a distance of 18 links; and an 8 inch Ash South 50 degrees West a distance of 18 links.

1964 U.S. Forest Service records show the following: technician Ekstom searched for corner, but found no evidence.

1974, 1975, 1977 Myron Landecker, Registered Land Surveyor Number 7452. Plats of: ROTTIERS BABY LAKE NORTH END ADDITION; HOLIDAY SHORES; HOLIDAY SHORES FIRST ADDITION. Plats show iron pipe in meander corner vicinity, he does not label as meander corner.

1986 U.S. Forest Service crews set an aerial target in the vicinity of this corner for the search and establishment of the true corner position. The target having coordinate values through the use of GPS on the Chippewa South Boundary Project Cadastral Survey U.S. Project Number 53-6392-8-219. This target allowed for the search and location of this corner.

1988 a Landecker-Stevenson & Associates crew searched for the corner. The following information was found and noted: distance falls on a 24 inch Ash at base of a four foot bank; no evidence of original bearing trees. Landecker monuments along Section line as noted in plat of ROTTIERS BABY LAKE NORTH END ADDITION found. This corner position determined lost.

1989 on April 11 a Landecker-Stevenson & Associates crew set a 3/4" by 5' aluminum rod with 3 foot fluted top and stamped aluminum cap. This corner was established at the lost, single proportionate position on the arc of the Tenth Standard Parallel between the Southwest corner of Section 33 and Meander Corner Number 1 on the East shore of Mann Lake and South line of Section 34. New bearing trees were marked as shown and a steel sign post set as noted on front of this certificate.