

CERTIFICATE OF LOCATION OF GOVERNMENT CORNER

Northeast Corner of Section 30, Township 141 N, Range 28 W, 5th P.M.

STATE OF MINNESOTA, County of Cass

At the corner location shown on the sketch: Latitude: 47° 00' 31.161"
 Longitude: 94° 23' 12.625"

On 11/4/88 found a 2" GLO brass cap monument and 1916 2" capped
DATE
County iron pipe

left monument as found, lowered monument, removed monument (explain)

On placed a
DATE

Magnetic Decl: 5° East SKETCH OF REFERENCE TIES
 Not to Scale

All distances are horizontal to nail in side of tree.

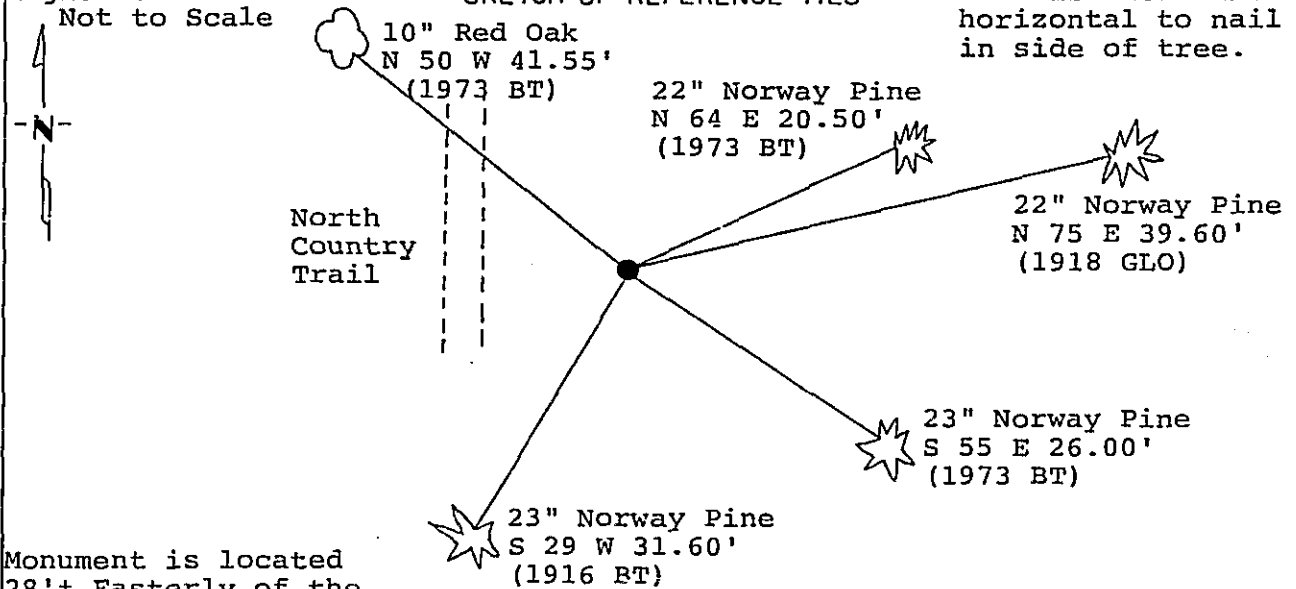

Monument is located 28'± Easterly of the North Country Trail and 152'± Westerly of FS Trail #2100.

8' steel sign post North 5.0'
 6' steel sign post West 6.2'

Monument Stamped
S19 | S20
S30 | S29
 1918

All trees are painted with red enamel and marked with a 54-3 (bearing tree) tag.

Statement of evidence relative to this corner location is on back of page. 311936

I hereby certify that this survey, plan or report was prepared by me or under my direct supervision and that I am a duly Registered Land Surveyor under the laws of the State of Minnesota.

David S. Landecker
 David S. Landecker
 Date 5-1-89 Registration No. 17008

OFFICE OF THE COUNTY RECORDER

County of Cass

I hereby certify that this document was filed in the Co. Recorders office at 9:10 A. M. on the 9 day of May A.D., 19 89

County Recorder Clonine Kayler

By ms, Deputy

DOCUMENT NO. 311936

Statement of Evidence:

Northeast Corner Section 30, Township 141 North,
Range 28 West, Cass County, Minnesota

R-5 141-28
Bk.7 Pg.45

1874 P. H. Conger, U.S. Deputy Surveyor, originally established this corner position while subdividing Township 141 North, Range 28 West. The notes indicate a wood post was set to mark the corner position and the following witnesses: a 20 inch White Pine South 18 degrees West a distance of 24 links; a 30 inch White Pine North 44 degrees West a distance of 28 links; a 28 inch White Pine North 46 degrees East a distance of 72 links; and a 20 inch White Pine South 42 degrees East a distance of 33 links.

1916 County Surveyor's Record Book C pages 384-390 show survey by E.B. Horst. He found all government bearing tree stumps and set a 2 and 1/2 inch by 48 inch iron pipe with cap. New ties: a 20 inch White Pine stump North 39 degrees 30 minutes East a distance of 40.30 feet; a 24 inch White Pine stump South 42 degrees East a distance of 68.40 feet; and a 5 inch Norway Pine South 28 degrees West a distance of 31.70 feet.

1918 U.S. General Land Office dependant resurvey found the corner marked by all four original bearing tree stumps and a 2 inch capped iron pipe. A 2 inch by 36 inch iron pipe with a marked brass cap was set to mark the corner. The following bearing trees were marked: an 8 inch Norway Pine North 74 and 1/2 degrees East a distance of 60 links; an 8 inch Norway Pine South 54 and 1/4 degrees East a distance of 129 links; a 14 inch White Oak South 39 and 3/4 degrees West a distance of 398 links; and a 7 inch Norway Pine North 85 degrees West a distance of 275 links.

1973 U.S. Forest Service surveyor, Bill Okerman, Registered Land Surveyor Number 6807 finds General Land Office 2 inch brass cap monument and capped County iron pipe. The following bearing trees were marked: a 7 inch Oak North 50 degrees West a distance of 41.55 feet; a 20 inch Norway Pine North 64 degrees East a distance of 20.50 feet; a 21 inch Norway Pine South 55 degrees East a distance of 26.00 feet; a 21 inch Norway Pine South 29 degrees West a distance of 31.60 feet; and set a 6 foot steel sign post due West 6.2 feet. He filed corner certificate on February 5, 1974, with the Cass County Recorder as certificate number 894.

1988 on November 4 a Landecker-Stevenson & Associates crew visited the corner and found the following: 2 inch brass cap monument and 2 inch capped iron pipe, all four 1874 bearing tree stumps, 1916 Southwest bearing tree, which was also a 1973 Okerman tie, 1918 General Land Office Northeast bearing tree and remains of Southeast bearing tree stump. All four 1973 Okerman bearing trees are in good shape. The old bearing trees were remeasured as shown and steel sign posts are in place as noted on front of this certificate.