

CERTIFICATE OF LOCATION OF GOVERNMENT CORNER

Northeast _____ Corner of Section 34, Township 141 N, Range 29 W, 5th P.M.

STATE OF MINNESOTA, County of Cass

At the corner location shown on the sketch: Latitude: 46° 59' 38.838"
 Longitude: 94° 19' 36.503"

- On _____ found a _____
DATE
- left monument as found, lowered monument, removed monument (explain)
- On 3/20/89 placed a 2 inch by 48 inch iron pipe with brass cap
DATE
and plastic base with magnet.

Magnetic Decl: 5° East SKETCH OF REFERENCE TIES
 Not to Scale

All distances are horizontal to nail in side of tree.

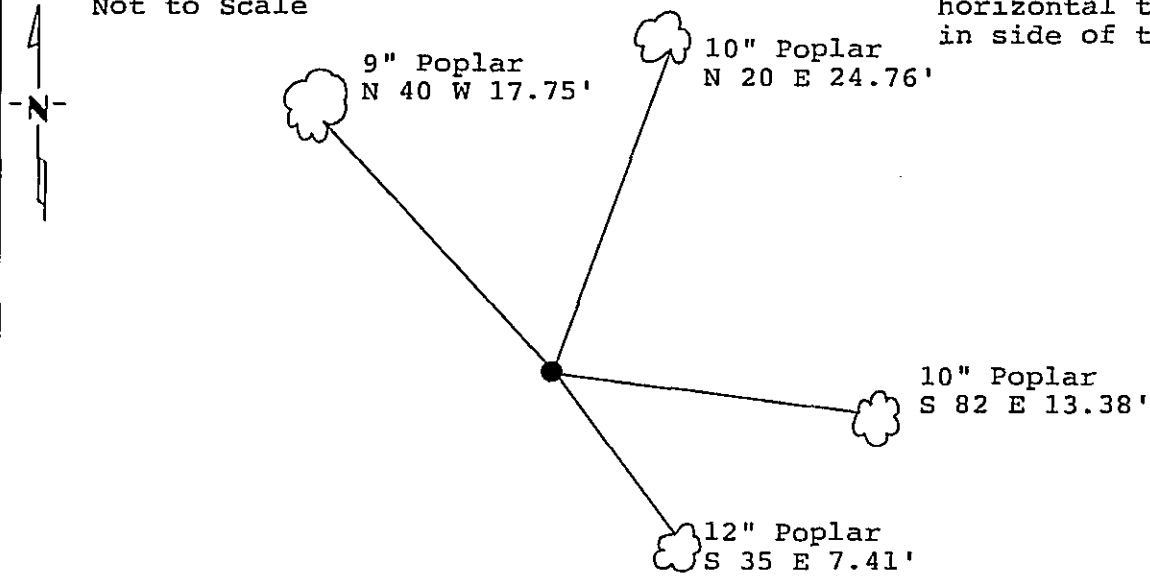

Monument is located on Westerly slope of "bowl", west of plantation. 8' steel sign post North 4.0' All trees are painted with red enamel and marked with a 54-3 (bearing tree) tag.

Monument Stamped
 T 141 N R 29 W
S27 | S26
S34 | S35
 1989
 RLS 17008

Statement of evidence relative to this corner location is on back of page. 311850

I hereby certify that this survey, plan or report was prepared by me or under my direct supervision and that I am a duly Registered Land Surveyor under the laws of the State of Minnesota.
David S. Landecker
 David S. Landecker
 Date 4-28-89 Registration No. 17008

OFFICE OF THE COUNTY RECORDER
 County of Cass
 I hereby certify that this document was filed in the Co. Recorders office at 3:58 P.M. on the 3 day of May A.D., 1989
 County Recorder Clondine Kayle
 By MS, Deputy
 DOCUMENT NO. 311850

Statement of Evidence:

Northeast Corner Section 34, Township 141 North,
Range 29 West, Cass County, Minnesota

V-17 141-29
Bk.4 Pg.72

1873 P. H. Conger, U.S. Deputy Surveyor, originally established this corner position while subdividing Township 141 North, Range 29 West. The notes indicate a wood post was set to mark the corner position and the following witnesses: an 8 inch White Oak North 79 and 1/2 degrees West a distance of 39 links; a 24 inch White Pine South 60 degrees West a distance of 70 links; and a 14 inch White Pine stub North 66 degrees East a distance of 39 links.

1918 U.S. General Land Office dependent resurvey reestablished this corner as lost, by double proportional measurements. A 3 inch by 48 inch wood stake was set to mark the corner. No new bearing trees were marked.

1974 Myron Landecker, Licensed Land Surveyor Number 7452, did not find this corner. He, therefore, established the corner lost from reconstructing the 1918 General Land Office resurvey in this area. Specifically he used the Northeast and reservation closing corner on the east line of Section 27 to reestablish this position. No monument was set.

1976 Robert F. Schneider, Licensed Land Surveyor Number 5740, did not find corner and followed the previous survey methods of Myron Landecker in use of this corner position. No monument was set.

1986 U.S. Forest Service crews set an aerial target in the vicinity of this corner for the search and establishment of the true corner position. The target having coordinate values through the use of GPS on the Chippewa South Boundary Project Cadastral Survey U.S. Project Number 53-6392-8-219. This target allowed for the search and location of this corner.

1988 a Landecker-Stevenson & Associates crew searched for the corner. The following information was found and noted: search a 200 foot area for original bearing trees and post proportioned by General Land Office in 1918. No evidence of any post or bearing trees from original survey or General Land Office resurvey.

1989 on March 20 a Landecker-Stevenson & Associates crew set a 2 inch by 48 inch iron pipe with brass cap and plastic base with magnet at the obliterated corner position reestablished from the 1918 General Land Office resurvey notes and existing monumentation. New bearing trees were marked as shown and a steel sign post was set as noted on front of this certificate.