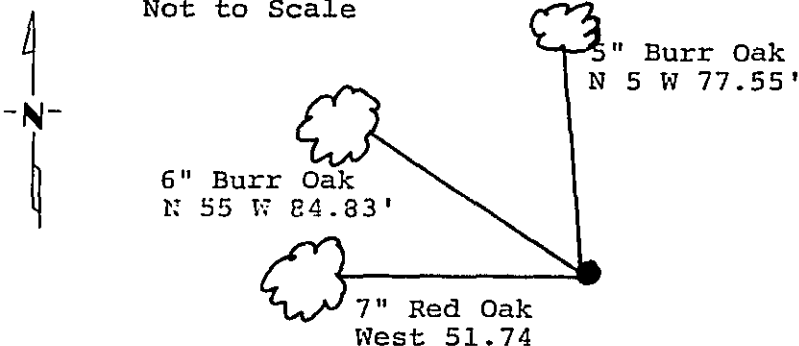

CERTIFICATE OF LOCATION OF GOVERNMENT CORNER

STANDARD

SOUTH QUARTER Corner of Section 36, Township 141 N, Range 30 W, 5th P.M.STATE OF MINNESOTA, County of CASS

At the corner location shown on the sketch:

Latitude: 46° 58' 47.301"Longitude: 94° 25' 04.697" On 6/1/88 found a 2" iron monument with a brass cap (USFS)
DATE left monument as found, lowered monument, removed monument (explain) On _____ placed a _____
DATEMagnetic Decl: 5° East SKETCH OF REFERENCE TIES
Not to ScaleAll distances are
horizontal to nail
in side of tree.Monument is located
in woods 1900' more or
less easterly of road to
north end of Little
Webb Lake
8' sign post west 3.2'

Monument Stamped

T 141 N R 30 W
1/4 S | 36
T 140 N

1965

All trees are painted with red enamel and
marked with a 54-3 (bearing tree) tag.

RLS No. 6807

Statement of evidence relative to this corner location is on back of page.

I hereby certify that this survey, plan or
report was prepared by me or under my
direct supervision and that I am a duly
Registered Land Surveyor under the laws
of the State of Minnesota.David S. Landecker
David S. Landecker
Date 3/31/89 Registration No. 17008OFFICE OF THE COUNTY RECORDER
County of CassI hereby certify that this document was filed in
the Co. Recorder's office at 1:40 P. .M. on the
3rd day of April A.D., 19 89County Recorder Claudine Taylor
By Bjk, DeputyDOCUMENT NO. 311190

Statement of Evidence:

Standard South Quarter Corner Section 36,
Township 141 North, Range 30 West, Cass County,
Minnesota

Z-23 141-30
Bk.4 Pg.28

1863 Johnson and Thornton, U.S. Deputy Surveyors, originally established this corner position while running the 10th Standard Parallel. The notes indicate a wood post was set to mark the corner position and the following witnesses: a 12 inch Aspen North 75 degrees West a distance of 34 links; and a 7 inch Yellow Pine North 4 degrees East a distance of 34 links.

1965 U.S. Forest Service technician James Ekstrom found the corner monumented with a 2 inch iron pipe. He set a 2 inch by 5 foot iron pipe with bronze cap. New bearing trees were marked: a 6 inch Aspen North 46 degrees West a distance of 19.6 feet; and a 5 inch Maple North 53 degrees East a distance of 27.5 feet.

1971 U.S. Forest Service Surveyor Bill Okerman, Licensed Land Surveyor Number 6807, filed corner certificate on February 19, with the Cass County Recorder as certificate Number 626, using 1965 information.

1986 U.S. Forest Service crews set an aerial target over this corner position for determination of coordinate values through the use of GPS on the Chippewa South Boundary Project Cadastral Survey U.S. Project Number 53-6392-8-219. This target allowed for the search and location of this corner. Both 1965 bearing trees were cut off.

1988 on June 1 a Landecker-Stevenson & Associates crew visited the corner and found the following evidence: 2 inch brass cap monument and capped iron as previously used by County in good condition. New bearing trees were marked as shown and steel sign post was set as noted on front of this certificate.