

CERTIFICATE OF LOCATION OF GOVERNMENT CORNER

Meander _____ Corner of Section 26, Township 141N, Range 28W, 5th P.M.

STATE OF MINNESOTA, County of Cass

At the corner location shown on the sketch:

On 10-19-88 found a 1918 GLO 1" x 36" iron pipe with brass cap
DATE

left monument as found, lowered monument, removed monument (explain)

On _____ placed a _____
DATE

Monument marked

SKETCH OF REFERENCE TIES
 Not to scale

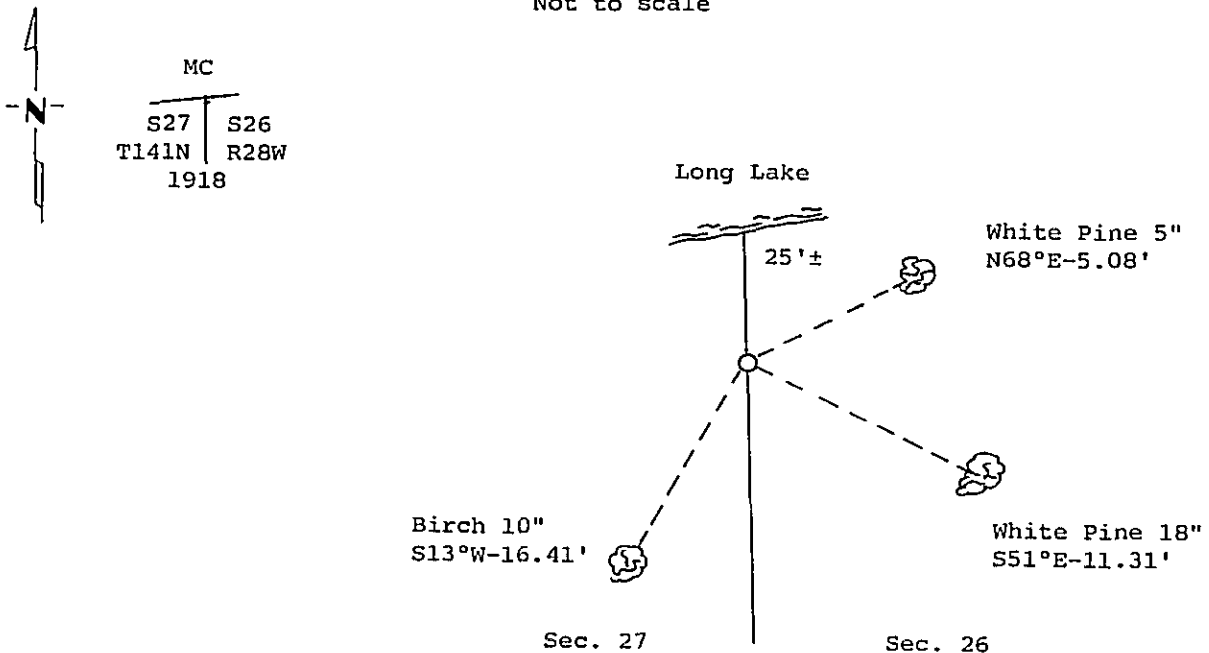

Spike in side of trees, no paint, scribe or tags

Statement of evidence relative to this corner location is on back of page.

310944

I hereby certify that this survey, plan or report was prepared by me or under my direct supervision and that I am a duly Registered Land Surveyor under the laws of the State of Minnesota.

William C. Osborn

Date 3/17/89 Registration No. 12767

OFFICE OF THE COUNTY RECORDER

County of Cass

I hereby certify that this document was filed in the Co. Recorders office at U.S.A. M. on the 17 day of March A.D., 1989

County Recorder Claudine Kayler

By ms, Deputy

DOCUMENT NO. 310944

Statement of Evidence:

T,U-17 MC Sections 26 & 27 (South Shore)

- 1874 P.H. Conger set post for corner and the following reference:
Poplar 6" bears S 40 degrees E, 20 Links (13.20 feet)
- 1918 Dependent resurvey by GLO, notes state no evidence of original
post or bearing trees. Established new MC and the following
references:
Birch 6" bears S 11 1/4 degrees W, 25 Links (16.50 feet)
W. Pine 10" bears S 22 1/2 degrees E, 19 Links (12.54 feet)
- 12-13-88 Personnel from Kovanen & Osufsen Surveyors find 1918 GLO corner
and witnesses. Left monument as found. Added spikes to 1918
witnesses and add new witness as shown on Certificate.

This position is not a perpetuation of the original GLO corner, but
accepted as corner for lack of further evidence.