

CERTIFICATE OF LOCATION OF GOVERNMENT CORNER

C-N-NE 1/64 Corner of Section 12, Township 141 N., Range 29 W., 5th P.M.
STATE OF MINNESOTA, County of CASS

At the corner location shown on the sketch:

- On 7/27/87 found a 1" GLO brass cap monument up 8" in good condition
DATE
- left monument as found, lowered monument, removed monument (explain)
- On _____ placed a _____
DATE

SKETCH OF REFERENCE TIES

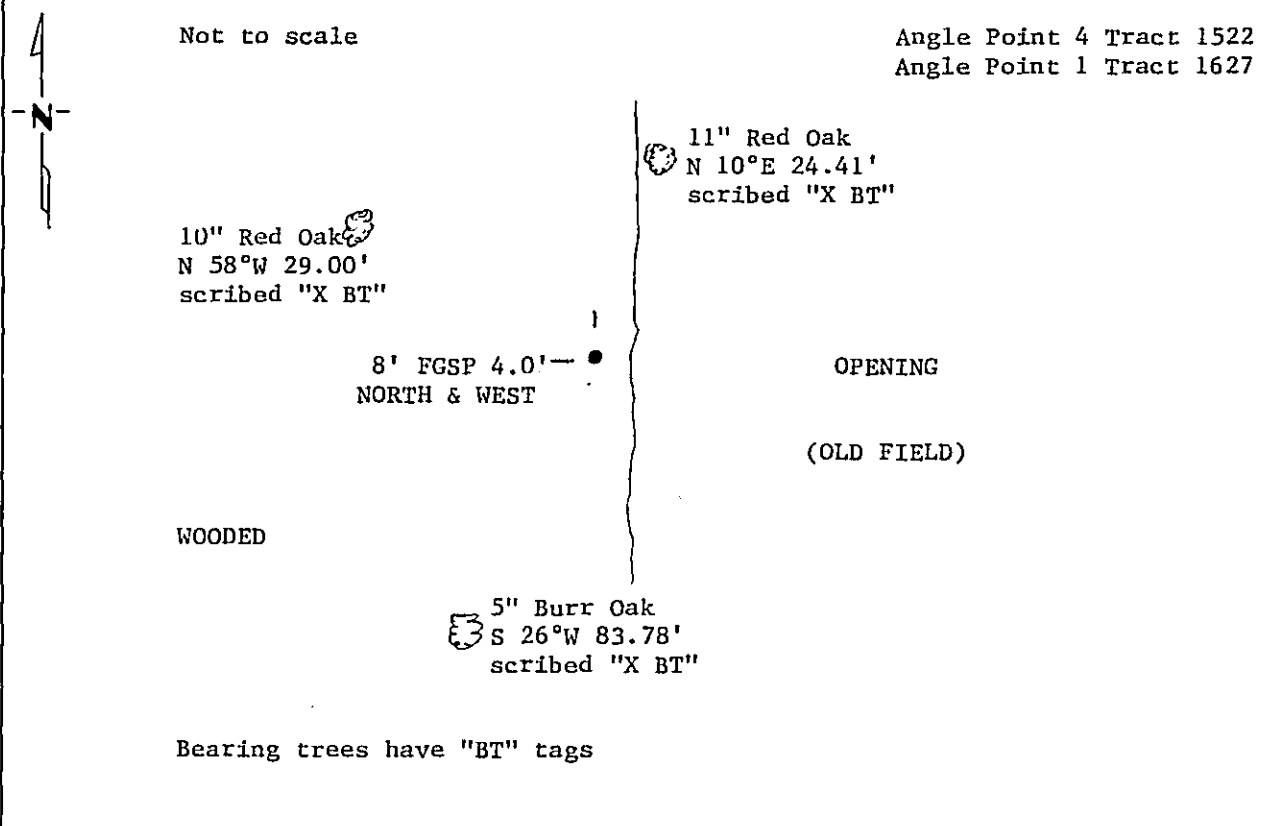

Statement of evidence relative to this corner location is on back of page. 309785

I hereby certify that this document and the data contained herein was prepared by me or under my direct supervision.

Walter E. Coen 1-9-89
SIGNATURE DATE

Registration No. 11395
 Land Surveyor
 County Surveyor

OFFICE OF THE COUNTY RECORDER
County of Cass

I hereby certify that this document was filed in the Co. Recorders office at 3:25 P.M. on the 9 day of January A.D., 1989

County Recorder Claudine Kayler
By M.S., Deputy
DOCUMENT NO. 309785

Statement of Evidence: C-N-NE 1/64 Corner Section 12,T.141 N.,R.29 W.,5th P.M.

- 1918 US General Land Office dependent resurvey set a 1"x36" I.P. with marked brass cap for this corner. No bearing trees were marked.
- 1987 On July 27, Terry Freeman,Cass County Surveyors Office and Curt Krause,US Forest Service found the GLO brass cap monument in good condition,up 8". Mark three bearing trees and set fiberglass sign posts NORTH 4.0' and WEST 4.0'. Chained GLO distance south and the distance checks well.