

# CERTIFICATE OF LOCATION OF GOVERNMENT CORNER

# 24 Meander Corner of Section 2 & 3, Township 141 N., Range 28 W., 5th P.M.

STATE OF MINNESOTA, County of CASS

At the corner location shown on the sketch:

On 3/7/88 found a brass cap monument up 29", 10' southerly of waters edge

left monument as found,  lowered monument,  removed monument (explain)

On \_\_\_\_\_ placed a \_\_\_\_\_

## SKETCH OF REFERENCE TIES

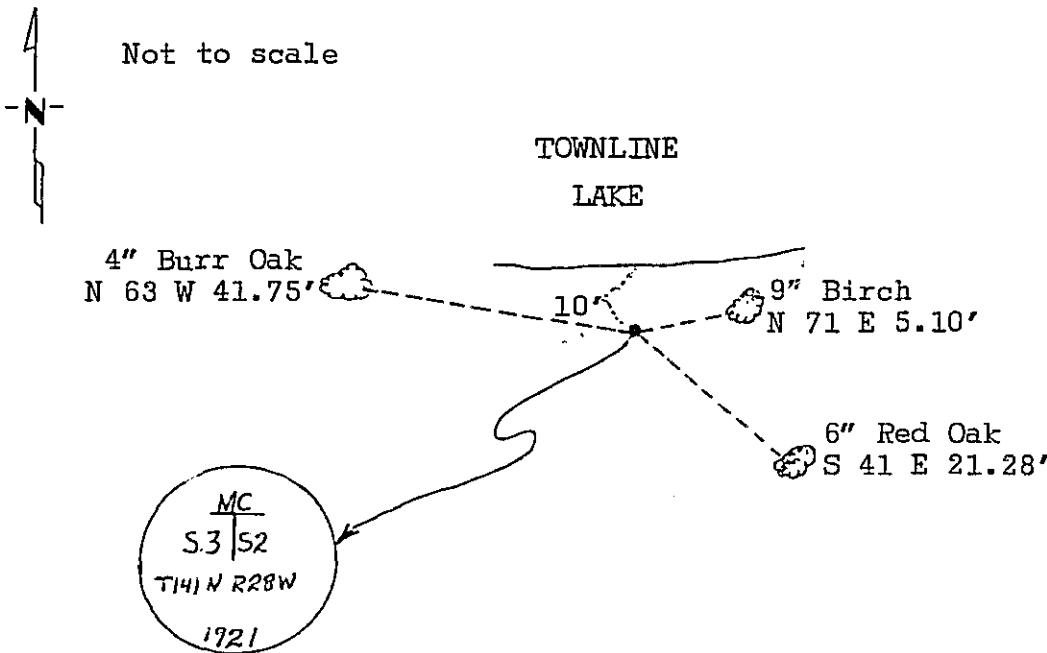

Not to scale

Trees double blazed, scribed, painted red and 54-3 Bearing Tree tag. Measurement taken to nail in side of tree.

Statement of evidence relative to this corner location is on back of page. 303288

I hereby certify that this document and the data contained herein was prepared by me or under my direct supervision.

Walter E. Cunn 3-22-88  
SIGNATURE DATE

Registration No. 11395

Land Surveyor

County Surveyor

### OFFICE OF THE COUNTY RECORDER

County of Cass

I hereby certify that this document was filed in the Co. Recorders office at 9:50 A.M. on the 22 day of March, A.D., 19 88

County Recorder Clondine Kayler

By ms, Deputy

DOCUMENT NO. 303288

Statement of Evidence: Meander Corner #24, Sections 2&3, T.141 N., R.28 W.,  
5th P.M.

- 1874 US General Land Office survey set a wood post for this corner and marked the following bearing trees: 7" Birch S 49 W 14 lks., 6" W.Pine S 52 E 90 lks.
- 1921 US General Land Office dependent resurvey found an old decayed stake and set a 1"x36" I.P. with marked brass cap. The following bearings were marked: 6" Red Oak S 59  $\frac{1}{2}$  E 16 lks., 12" Birch N 35  $\frac{3}{4}$  W 27 lks.
- 1988 On March 7, Curo Surveying, under contract with the US Forest Service, found the brass cap monument up 29" in mound of rocks, 10' southerly of waters edge. Bearing trees marked as shown on front of this certificate.