

CERTIFICATE OF LOCATION OF GOVERNMENT CORNER

WEST QUARTER Corner of Section 16, Township 140 N, Range 29 W, 5th P.M.

STATE OF MINNESOTA, County of CASS

At the corner location shown on the sketch:

On OCT. 20, 1987 found a 3/4" IRON 9" ABOVE.
DATE

left monument as found, lowered monument, removed monument (explain)

On placed a
DATE

NO SCALE

SKETCH OF REFERENCE TIES

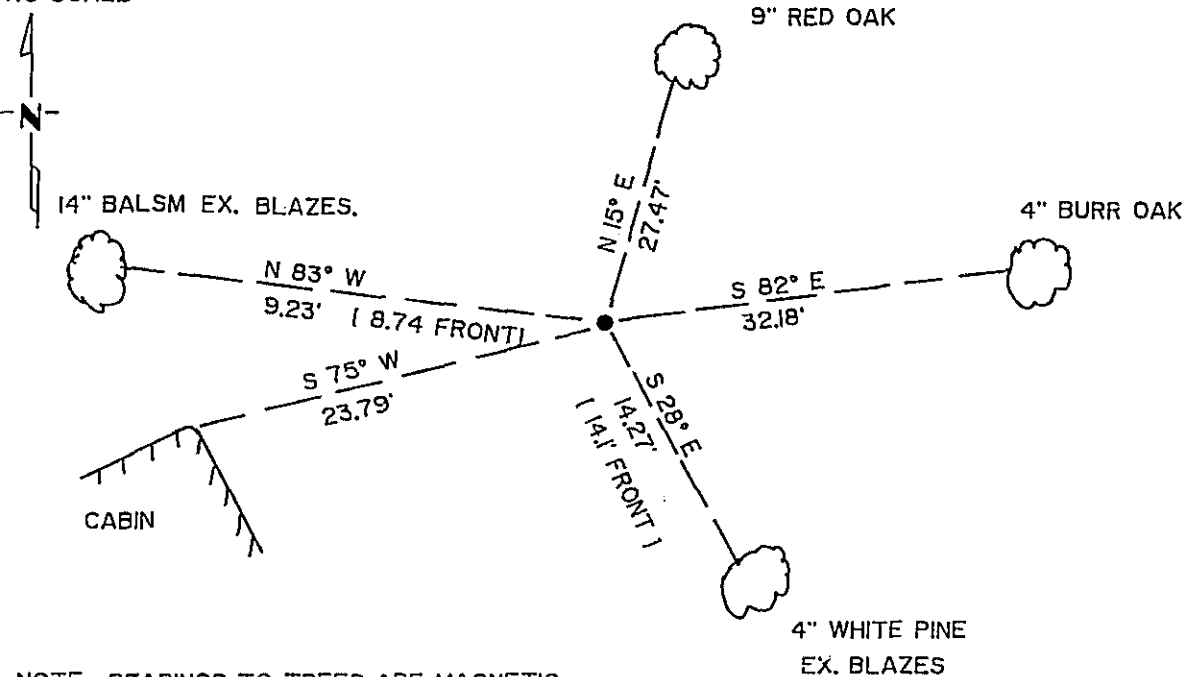

NOTE: BEARINGS TO TREES ARE MAGNETIC.
 ALL TREES ARE MARKED WITH DOUBLE BLAZES.
 DISTANCES ARE TO DISC IN SIDE OF TREES.

Statement of evidence relative to this corner location is on back of page. 302272

I hereby certify that this document and the data contained herein was prepared by me or under my direct supervision.

Donald A. Landecker 12/31/87
SIGNATURE DATE

Registration No. 17008

- Land Surveyor
- County Surveyor

OFFICE OF THE COUNTY RECORDER
 County of Cass

I hereby certify that this document was filed in the Co. Recorders office at 3:48 P. on the 13 day of January A.D., 1988

County Recorder Claudine Kayler
 By ms, Deputy

DOCUMENT NO. 302272

Statement of Evidence:

L-9

East Quarter Corner, Section 17, Township 140 North, Range 29 West, Cass County, Minnesota.

In 1870 the original government survey was done by Orville Smith. A wood post was set to make the corner.

Two bearing trees witnessing said corners were marked, noted as follows:

6" jack pine North 65 degrees East, 14 links

7" jack pine North 63 degrees West, 10 links.

Corner noted in place and set by single proportionate methods County Book 'C', Page 205.

In 1950 Harold Curo shows iron monument as noted on survey in County Book 'D', Page 357.

In 1978 Roger Mustonen, RLS #11946 while employed by W. J. Spain, Jr. RLS #2003 find capped iron pipe monument and uses in plat of SUNRISE TRAIL of record.

In 1987 David S. Landecker, RLS #17008, surveyor with the firm of Landecker & Associates, Inc. finds and accepts monument as used by Mustonen and Spain in 1978 as noted above.

H. Curo's distance on West line of Northwest Quarter check with measurements made by Landecker.

Landecker File #8778